

# INSTALL INSTRUCTIONS FOR 75-5223

## BEFORE YOU START

Kit may not fit with the following Aftermarket Parts installed:

Body Lift or Lowering Kit

Custom Hood

Aftermarket Turbocharger and/or Throttle Body Spacer

- Please read the entire product guide before proceeding.
- Ensure all parts are present.
- If you are missing any of the components, call our customer support at (909) 947-0015.
- Do not work on your vehicle while the engine is hot.
  - Make sure the engine is turned off and the vehicle is in Park or the Parking Brake is set.

## REQUIRED TOOLS

PROPRIETARY AND CONFIDENTIAL  
THE INFORMATION CONTAINED IN THIS DRAWING IS THE SOLE PROPERTY  
OF S&B FILTERS, INC. ANY REPRODUCTION IN PART OR AS A WHOLE  
WITHOUT THE WRITTEN PERMISSION OF S&B FILTERS, INC. IS PROHIBITED.

| REVISIONS |                 |           |          |
|-----------|-----------------|-----------|----------|
| REV.      | DESCRIPTION     | DATE      | APPROVED |
| A         | INITIAL RELEASE | 9/18/2025 | JJ       |

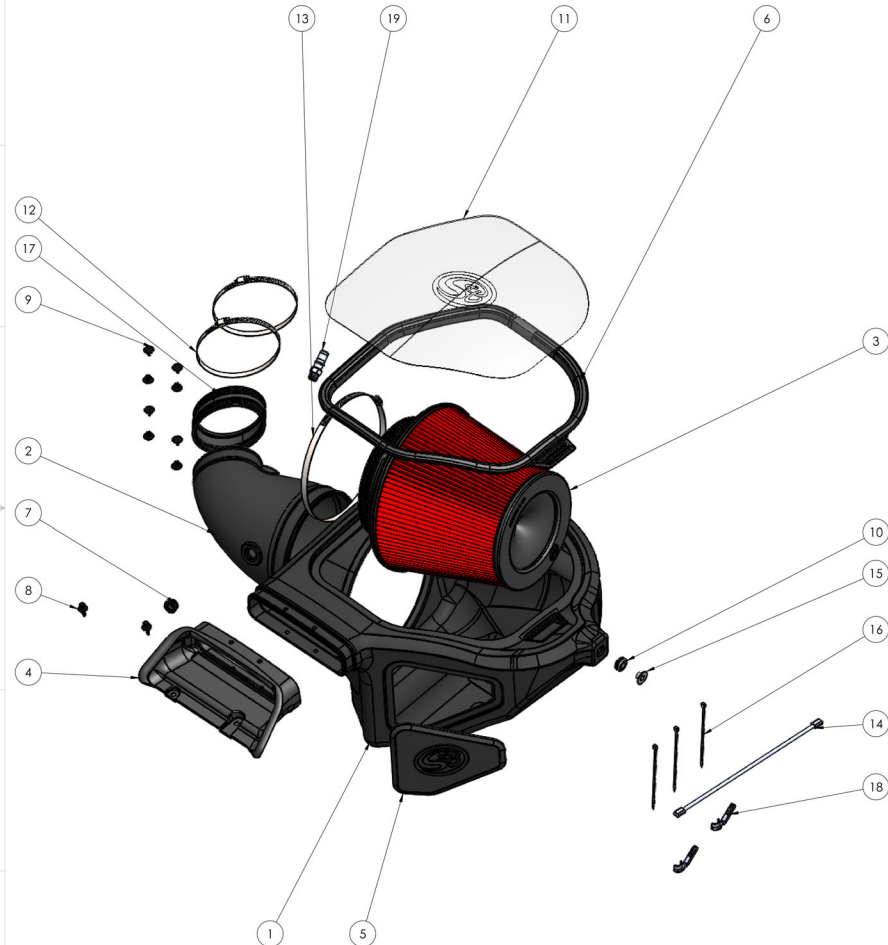

| ITEM NO. | PART NUMBER | DESCRIPTION                  | QTY. |
|----------|-------------|------------------------------|------|
| 1        | AL1423B-00  | F150 Raptor R Box            | 1    |
| 2        | AL1537-00   | Raptor R Whipple Tube        | 1    |
| 3        | KF-1095A    | Filter                       | 1    |
| 4        | AI1758C-00  | Front Inlet                  | 1    |
| 5        | AI2875C-00  | Box Seal                     | 1    |
| 6        | AI2876C-00  | Snap-in Lid Seal             | 1    |
| 7        | AI1948C-00  | IAT Sensor Adapter           | 1    |
| 8        | AI1763-00   | Plastic Rivet                | 2    |
| 9        | AI1762-00   | Rivet, Interlocking Shank    | 8    |
| 10       | AI1563-00   | Grommet                      | 1    |
| 11       | AI2874-00   | Clear Lid                    | 1    |
| 12       | AG1010-00   | Hose Clamp, #80              | 2    |
| 13       | AG1032-00   | hHose clamp, #12             | 1    |
| 14       | AI1969-00   | IAT Sensor Harness Extension | 1    |
| 15       | AI2296-00   | Bushing, Shoulder            | 1    |
| 16       | AI1750-00   | Cable Tie, 6" Long           | 3    |
| 17       | AI1523C-00  | Straight Coupler             | 1    |
| 18       | AI2936-00   | Disconnect Tool              | 2    |
| 19       | AI3319-00   | QUICK DISCONNECT             | 1    |

|                                   |  |         |            |                                     |  |
|-----------------------------------|--|---------|------------|-------------------------------------|--|
| UNLESS OTHERWISE SPECIFIED:       |  | NAME    | DATE       | TITLE:                              |  |
| DIMENSIONS ARE IN INCHES          |  |         |            | 2023+ F150 Raptor R,<br>Whipple Kit |  |
| TOLERANCES:                       |  | DRAWN   | JJ         |                                     |  |
| FRACTIONAL ±.11"                  |  |         | 09/15/2025 | SIZE DWG. NO.                       |  |
| DECIMAL ±.015"                    |  | CHECKED | JJ         |                                     |  |
| ANGULAR BUNCH ±.05°               |  |         | 09/15/2025 | REV                                 |  |
| TWO PLACE DECIMAL ±.05            |  |         |            |                                     |  |
| THREE PLACE DECIMAL ±.005         |  |         |            | SCALE: 1:5                          |  |
| INTERPRET GEOMETRIC               |  |         |            |                                     |  |
| TOLERANCING PER: ASME Y14.5M-1994 |  |         |            | SHEET 1 OF 1                        |  |
| MATERIAL:                         |  |         |            |                                     |  |
| FINISH:                           |  |         |            | DO NOT SCALE DRAWING                |  |
|                                   |  |         |            |                                     |  |



## STEP 1:

Before you begin your install, take a **10mm socket** to disconnect the negative cable from the battery terminal.

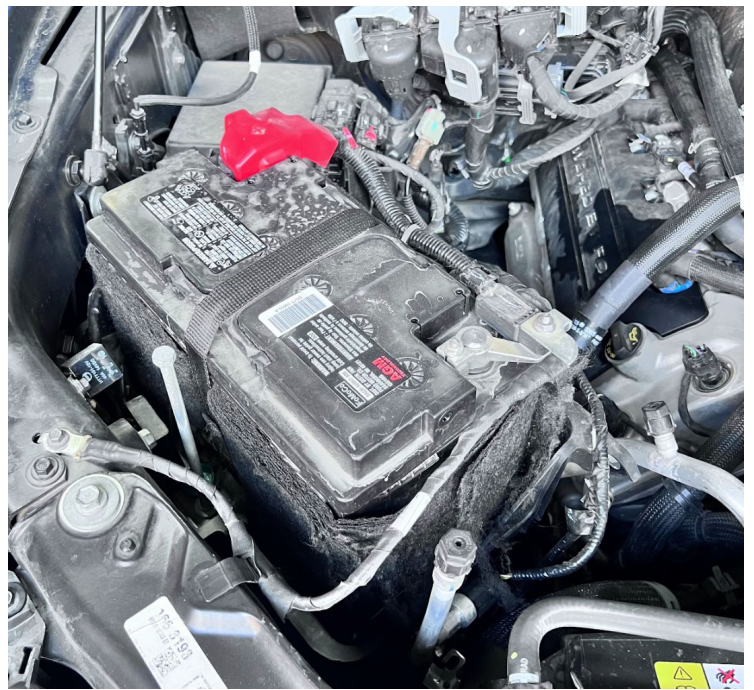

## STEP 2:

First, take a **body panel popper** to remove the 2 push pins holding down the factory air scoop.



## STEP 3:

Next, take a **13mm** socket and ratchet to remove the factory bolt holding the factory air box.

Additionally, make sure to remove the bushing and

grommet.



## STEP 4:

Next, take a **5/16th** or **8mm** socket to loosen the hose clamp on the throttle body side of the intake tube.





## STEP 5:

Now, go ahead and pinch the **two tabs** on the quick connect CCV fitting located on the firewall side of the intake tube.



## STEP 6:

Next, **push down on the tab** of the IAT sensor to disconnect it. This sensor can be located on the radiator side of the intake tube.



## STEP 7:

Take a **body panel removal tool** to remove the wire loom for the IAT Sensor located along the intake tube and air box.



## STEP 8:

Now, do the same thing to the **2nd wire loom**. This one can be found just to the right of the first one on the driver side.

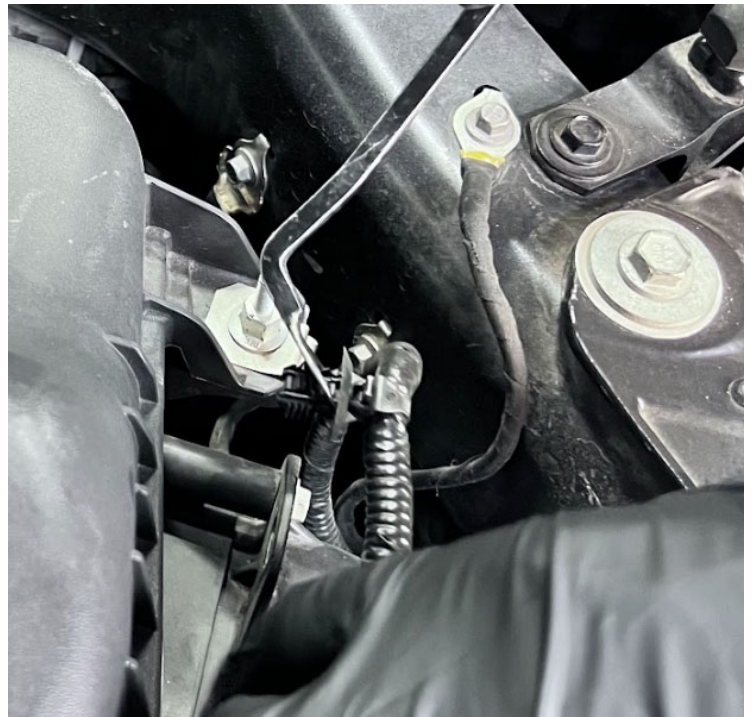

## STEP 9:

Now, go ahead and remove the air box and intake tube from the vehicle.

**Tip (Optional/Recommended):** We recommend covering the

throttle body with a clean shop towel to ensure no dirt or debris fall into the throttle body, which can potentially damage the motor.



## STEP 10:

Disconnect the IAT Sensor from the Stock Intake Tube. We recommend taking a small pick to lift up the tab in order to then turn and remove the sensor.

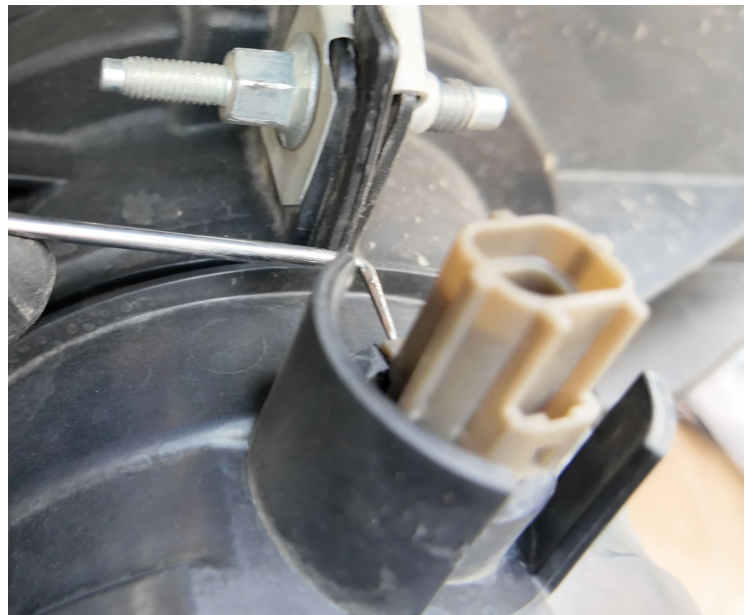

## STEP 11:

Now, take the IAT Sensor Adaptor (7) and install it into the S&B Intake tube (2). Make sure that the adaptor tab lines up with the gap in



the intake tube.

Then install the IAT Sensor and ensure the tab of the sensor goes over the lip on the grommet as seen in the picture to the right.

At this time, go ahead and connect the included IAT Sensor Harness Extension (14) onto the stock IAT harness.



## STEP 12:

Go ahead and thread in your CVC quick disconnect fitting (19) into your S&B Intake Tube.

**Tip:** Be sure to not over-tighten this fitting.





## STEP 13:

Install the Front Inlet Scoop.



## STEP 14:

Next, go ahead and install the **8** Interlocking Rivets (**9**) into the 4 holes (2 per hole) on the top and bottom of the Air Intake Inlet Scoop.



## STEP 15:

Install the provided Grommet (10) and Shoulder Bushing (15) to the fender side of the S&B air box.



## STEP 16:

Now, go ahead and pre-install the air filter in the S&B air box. Ensure the air filter's flange is fully seated to the air box. (as seen in the image to the right)

**Tip:** You can also do so while the air box is in the engine bay, but we recommend installing it while the air box is out of the vehicle.





## STEP 17:

It's time to pre-install the throttle body coupler onto the throttle body. You can also place the 2 provided hose clamps onto the coupler in preparation for the intake tube.



## STEP 18:

Go ahead and take the IAT wire loom and zip-tie it along the core support, up and out of the way, in order to give the S&B air box enough space.





## STEP 19:

Now, go ahead and install the S&B air intake.



## STEP 20:

Now, go ahead and tighten the **3** hose clamps on the intake assembly, (2 on the throttle body and 1 on the air filter flange). For this you'll need a **5/16th or 8mm socket**.



## STEP 21:

Connect the IAT Sensor to the include IAT Extension harness.



## STEP 22:

Next, take the Whipple Supplied PCV hose and connect it to the quick-connect fitting on the S&B intake tube.





## STEP 23:

Complete the installation of the S&B intake by bolting the air box to the stock air box location using a **13mm socket, extension**, and the **OEM bolt**.



## STEP 24:

Unwrap the protective film from the Clear Lid (11).





## STEP 25:

Install the Clear Lid (11) into the Snap-in Lid Seal (6).



## STEP 26:

Install the snap-in lid onto the S&B air box.



## STEP 27:

Reconnect the negative terminal of the battery using a **10mm socket**. Ensure all connection points are tight and secure.

**Your install is now  
complete.**

