



# INSTALL INSTRUCTIONS FOR 75-6002



## BEFORE YOU START

Note:

Kit may not fit with the following Aftermarket Parts installed:

Body Lift or Lowering Kit

Custom Hood

Throttle Body Spacer / Upgrade

Please read the entire product guide before proceeding.

Ensure all parts are present.

If you are missing any of the components, call our customer support at (909) 947-0015.

Do not work on your vehicle while the engine is hot.

Make sure the engine is turned off and the vehicle is in Park or the Parking Brake is set.

## REQUIRED TOOLS

Socket Wrench

7mm, 8mm, 10mm, 13mm Socket and Wrench

$\frac{3}{8}$ " Socket Extension

5/16" Nut Driver

Flat Blade Screwdriver or Panel Popper

T20 Torx Bit

Phillips Screwdriver

Scissors

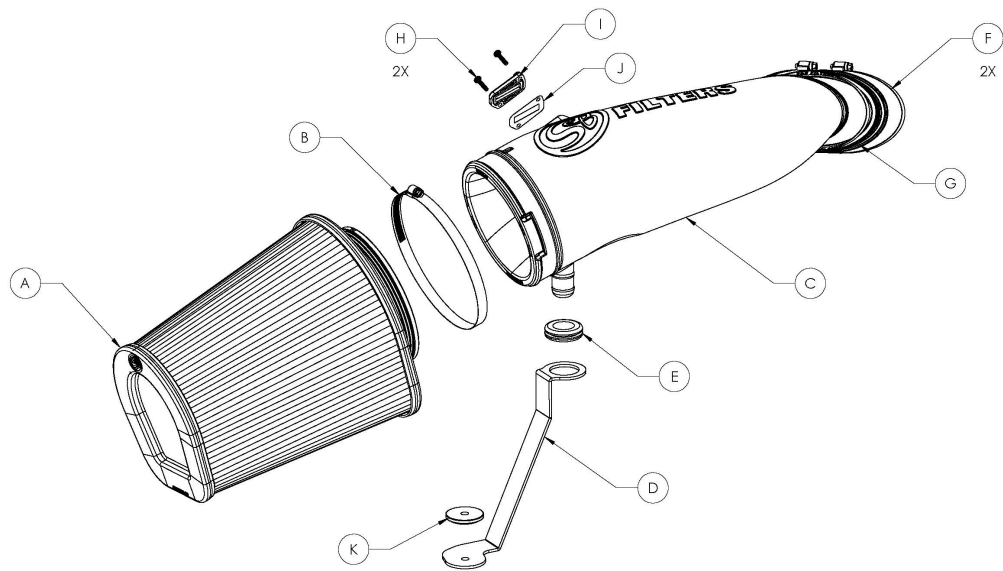

| ITEM NO. | PART NUMBER | DESCRIPTION                 | QTY. | ITEM NO. | PART NUMBER | DESCRIPTION                       | QTY. |
|----------|-------------|-----------------------------|------|----------|-------------|-----------------------------------|------|
| A        | KF-1070     | Air Filter                  | 1    | G        | AI1523C-00  | Straight Coupler                  | 1    |
| B        | AG1012-00   | Hose Clamp, #104            | 1    | H        | AI1837-00   | 8-32 Thread Size, 3/4" Long Screw | 2    |
| C        | AL1344-00   | Intake Tube                 | 1    | I        | AI1822-00   | MAF Adapter Pad                   | 1    |
| D        | AI2476-00   | Intake Tube Support Bracket | 1    | J        | AI1823-00   | MAF Gasket                        | 1    |
| E        | AI1368-00   | Rubber Grommet              | 1    | K        | AI2494-00   | Machined Aluminum Washer          | 1    |
| F        | AG1009-00   | Hose Clamp, #72             | 2    |          |             |                                   |      |

# STEP 1

With the ignition switched off and the parking brake set. Disconnect the negative battery cables on both batteries and the positive battery cable on the passenger side battery.

Note: Failure to disconnect the battery may cause the CEL to illuminate upon completion of the installation and subsequent operation. Do not skip this step!

Tools Required: Socket Wrench, 10mm Socket

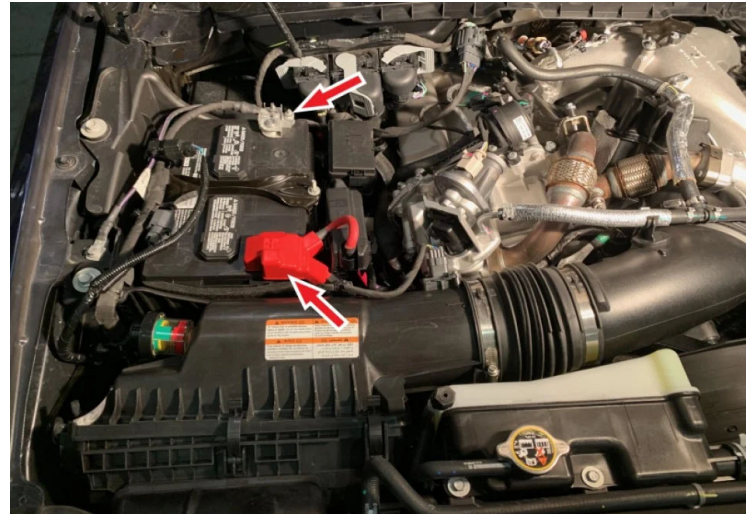

## STEP 1 (IMAGE 2)

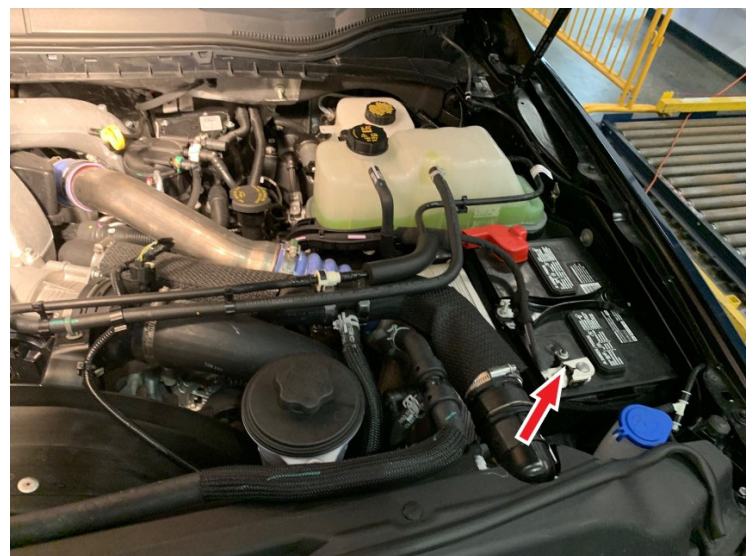

## STEP 2

Disengage the white locking clip, press down on the tab, then pull out to disconnect the MAF sensor harness from the MAF sensor.



## STEP 3

Remove the ribbed push in clip on the wiring harness from the stock intake lid.

Tools Required: Panel Popper or Flat Blade Screwdriver

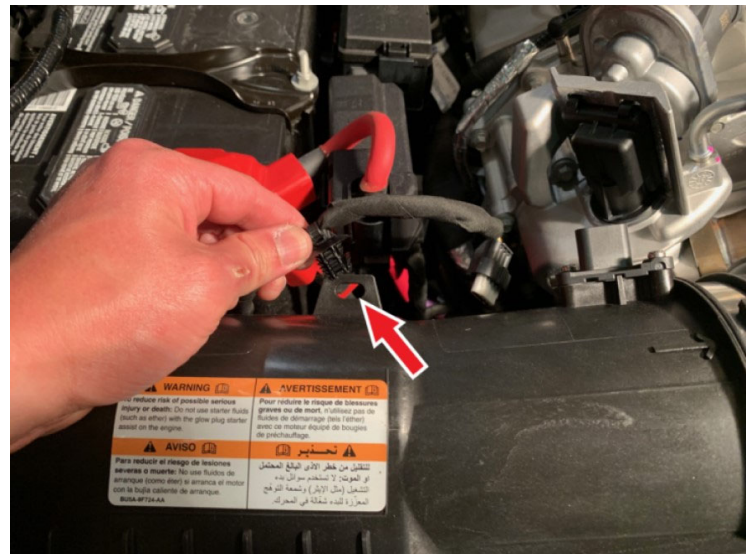

## STEP 4

Loosen the hose clamps on the intake tube connected to the turbo inlet and intake box.



Tools Required: 7mm  
Socket/Wrench or Flat Blade  
Screwdriver

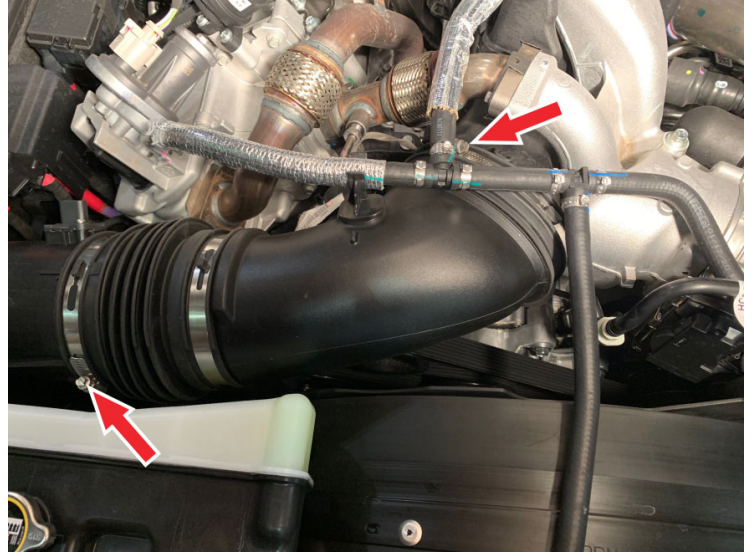

## STEP 5

Remove the coolant line  
from the intake tube clip  
then remove the intake tube  
from the vehicle.

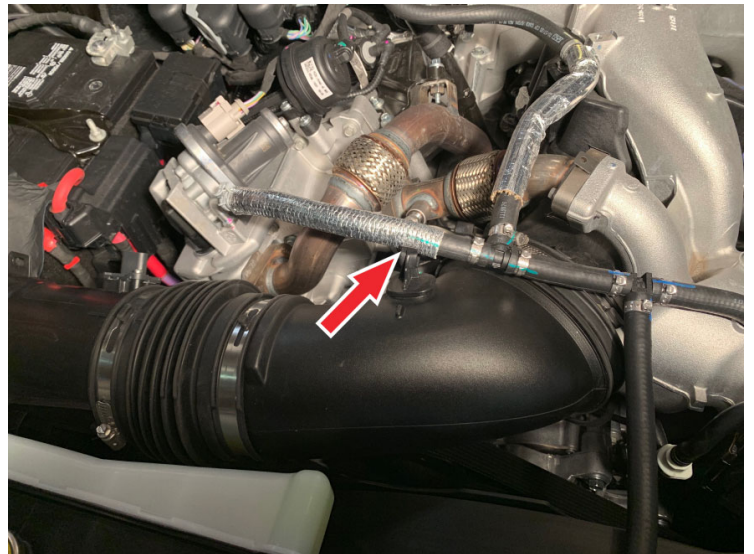

## STEP 6

Pop-out the stem and  
remove the push in rivet  
securing the stock front  
inlet.

Tools Required: Panel

Popper or Flat Blade  
Screwdriver



## STEP 7

Wiggle the stock front inlet  
loose and lift up to remove it  
from the vehicle.



## STEP 8

Using socket extension(s),  
remove the screw holding  
the stock intake box to the  
grill inlet duct.

Tools Required: 10" Socket  
Extension or 4" 6" Socket

Extension, 8mm Socket/  
Wrench



## STEP 9

Firmly but carefully rock and lift the intake box free from the lower grommet and free the side rubber bushings from the side saddle bracket. Remove the intake box from the vehicle.





## STEP 10

Remove the indicated grommet from the vehicle.



## STEP 11

Remove the two screws that hold the saddle bracket and remove the bracket from the vehicle. Set one of the screws aside, it will be reused in Step 13.

Tools Required: 13mm  
Socket/Wrench





## STEP 12

Install the rubber grommet (E) onto the tube support bracket (D) by pressing it into the large hole.



## STEP 13

Install the tube support bracket (D) into the vehicle using the custom washer (K) and the screw removed in step 11. Slide the end of the bracket under the area of the vehicle where the grommet was removed from in step 10. Place the custom washer over the hole so that the step on the washer is seated inside the hole. Use the previously removed screw to finish the installation. Do not torque the screw down so that the bracket retains some play without falling out of position.

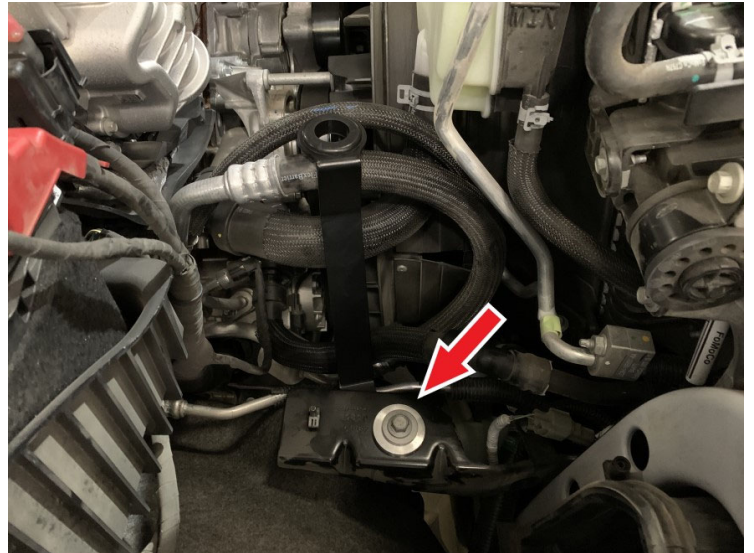

Tools Required: 13mm  
Socket/Wrench.

## STEP 14

After attaching the provided coupler (G) to the intake tube (C) with a #74 hose clamp (F), install the intake tube into the vehicle by slipping the other end of the

coupler around the turbo inlet. Gently guide the prong on the bottom of the tube into the grommet on the tube support bracket. Check the fitment of the bracket and tube and then tighten the bracket fully. This step ensures that the tube support bracket is installed in a position that will seat the tube correctly. After tightening down the bracket, remove the intake tube from the vehicle.



Tools Required: Ratchet,  
13mm Socket

## STEP 15

Remove the MAF sensor from the stock intake housing.

Tools Required: T20 Torx

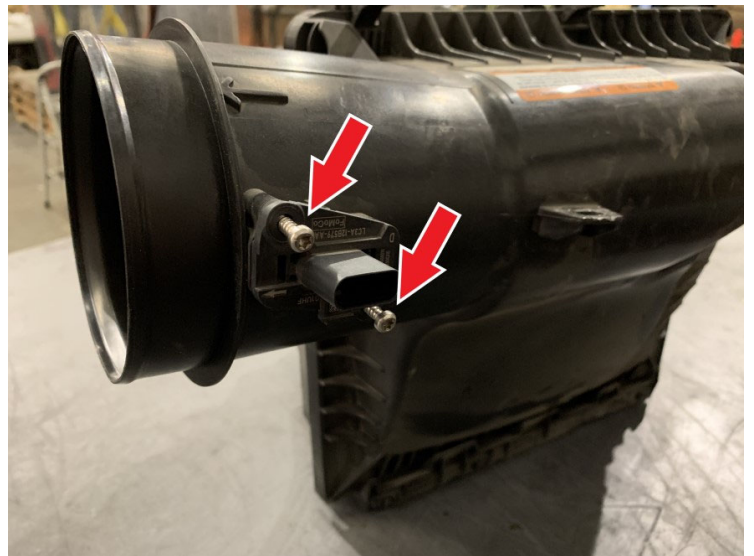

## STEP 16

Assemble the remainder of the entire intake tube/filter assembly outside of the vehicle. Attach the filter (A) to the intake tube and secure it using a provided #104 hose clamp (B). Put the remaining #74 hose clamp loosely around the remaining side of the coupler. Make sure the location markings on the filter and tube line up to ensure proper alignment of the filter assembly.



Tools Required: 5/16" Nut Driver

## STEP 17

Install the MAF sensor, MAF sensor pad (I) and MAF sensor pad gasket (J) onto the intake tube, securing them to the tube with the provided phillips head screws (H).



Tools Required: Phillips  
Screwdriver



## STEP 18

Install the assembled intake kit into the truck by sliding the intake tube into place so that the tube's coupler slips around the turbo inlet. Secure the assembly by pushing the tube down so that the prong on the bottom side of the tube presses securely into the grommet of the bracket installed in step 13.



## STEP 19

Finish securing the kit to the vehicle by tightening the #74 hose clamp over the coupler and around the turbo inlet.

Tools Required: 5/16" Nut Driver

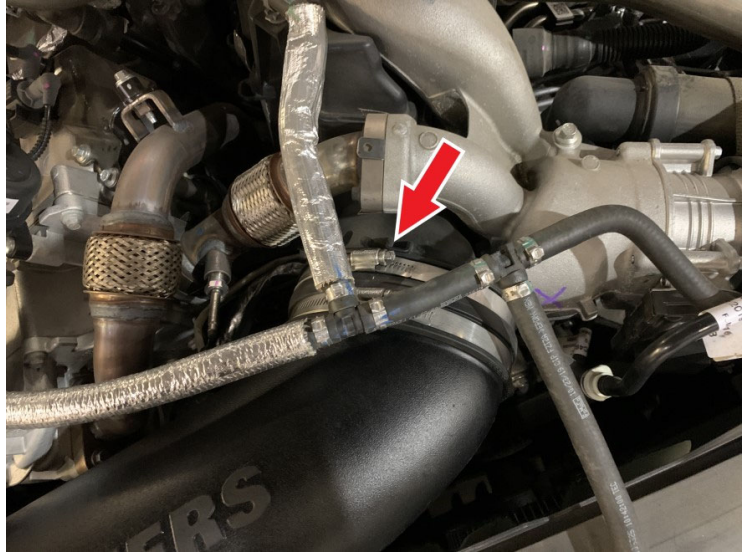

## STEP 20

Reattach the MAF harness to the MAF sensor by inserting the female end and engaging the white locking clip.

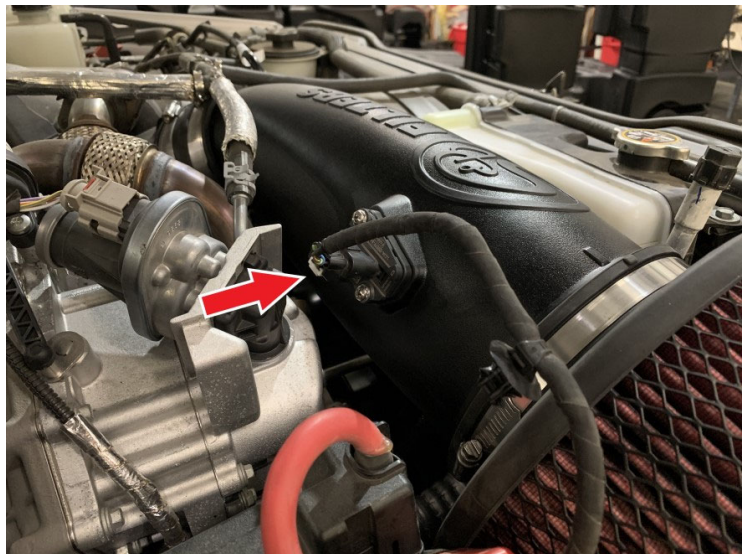

## STEP 21

Visually inspect the installation of the intake kit. Make sure the tube is fully seated within the support bracket and that the tube did not push out the grommet during installation.

## STEP 22

Reconnect the passenger side battery's positive terminal and both battery's negative terminals. Inspect your installation, make sure the kit is properly positioned and all fasteners are secured. S&B Filters recommends keeping all stock parts in case you would ever need to reinstall the stock intake. Affix the ID label near the intake kit. The installation is now complete.

