

INSTALL INSTRUCTIONS FOR 75-5163



BEFORE YOU START

Note:

This intake kit may not fit with the following Aftermarket Parts installed:

Body Lift or Lowering Kit

Custom Hood

Throttle Body Spacer / Upgrade

Aftermarket turbocharger

REQUIRED TOOLS

- 10mm Socket + Socket Wrench, Driver, or Wrench
- 5/16" Nut Driver or Socket and Driver
- 1/4" Nut Driver or Socket and Driver
- Flat Head Screwdriver
- Panel Popper
- Knife, Cutting Tool

Please read the entire product guide before proceeding.

- Ensure all parts are present.
- If you are missing any of the components, call our customer support at (909) 947-0015.
- Do not work on your vehicle while the engine is hot.
- Make sure the engine is turned off and the vehicle is in Park or the Parking Brake is set.

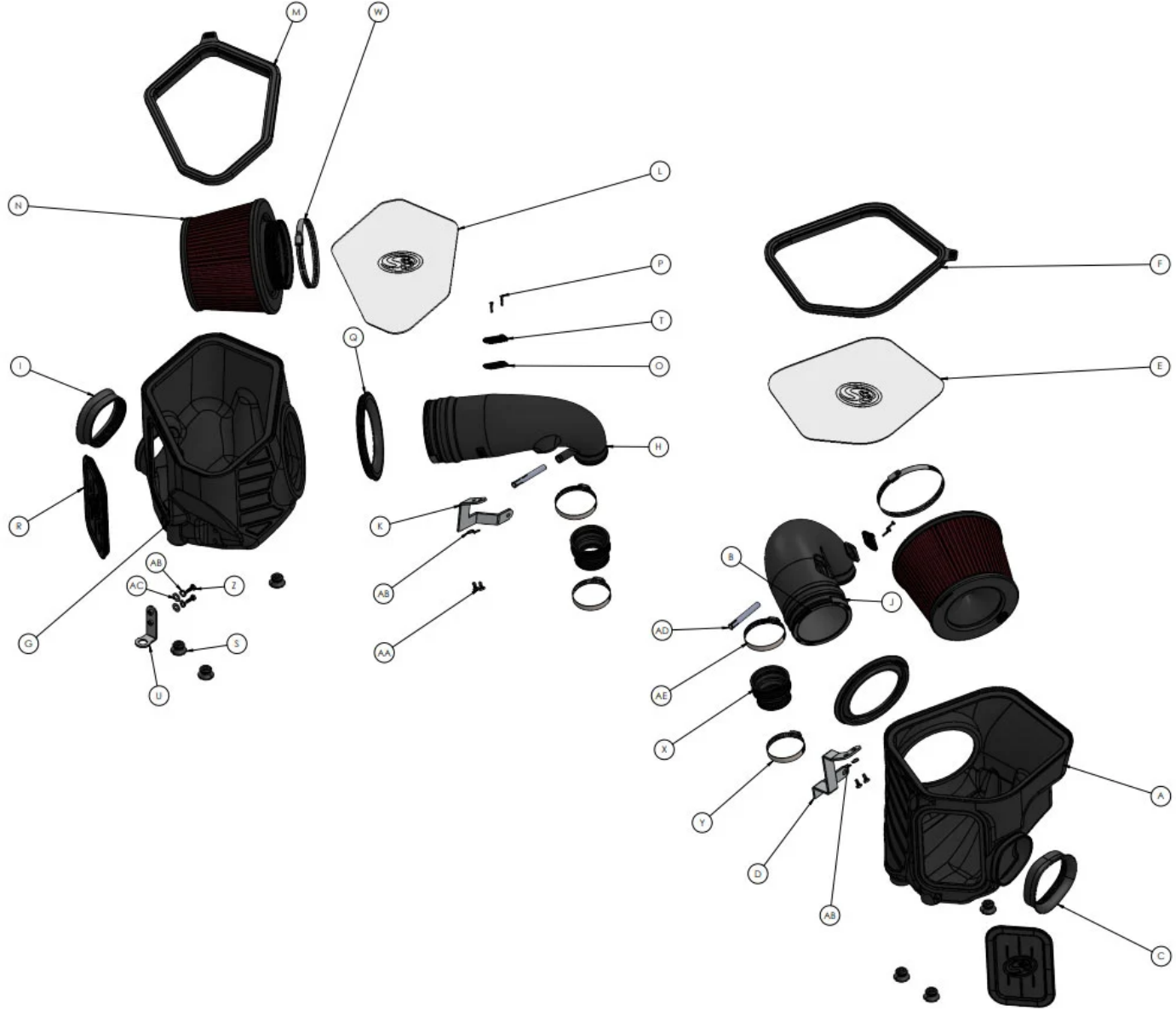

ITEM NO.	PART NUMBER	DESCRIPTION	QTY.
A	AL 1400D-00	DRIVER SIDE AIR BOX	1
B	AL 1401D-00	DRIVER SIDE TUBE	1
C	AI2746C-00-D	DRIVER SIDE SNAP-IN LID SEAL	1
D	AI2792-00	DRIVER SIDE BRACKET	1
E	AI2745-00-D	DRIVER SIDE POLYCARBONATE LID	1
F	AI2744C-00-D	DRIVER SIDE SNP -IN LID SEAL	1
G	AI 1400P-00	PASSANGER SIDE AIR BOX	1
H	AI1401P-00	PASSANGER SIDE TUBE	1
I	AI 2746C-00-P	PASSANGER SIDE SNAP-IN LID SEAL	1
J	AI2743-00	MAF AIR CONTROL INSERT	2
K	AI2793-00	PASSANGER SIDE BRACKET	1
L	AI2745-00-P	PASSANGER SIDE POLYCARBONATE LID	1
M	AI2744C-00-P	PASSANGER SIDE SNAP-IN LID SEAL	1
N	KF-1090A / KF-1090DA	PERFORMANCE REPLACEMENT FILTER	2
O	AI1823-00	MAF GASKET	2

ITEM NO.	PART NUMBER	DESCRIPTION	QTY.
P	AI1837-00	Screw	4
Q	AI1717C-001	SILICONE TUBE SEAL	2
R	AI2289C-00	AIR BOX PLUG	2
S	AI2375C-00	RUBBER GROMMETS	6
T	AI1822-00	MAF Mount	2
U	AI1677-01	Box Mounting	1
W	AG1009-00	#80 HOSE CLAMP	2
X	AI2762C-00	STEP DOWN SILICONE COUPLER	2
Y	AG1005-00	#40 HOSE CLAMP	2
Z	AI1068-00	Screw	2
AA	AI1077-00	Screw	4
AB	AI1309-00	Zinc-Plated Steel Split Lock Washer	6
AC	AI1073-00	Washer	2
AD	AI2859-00	CCV INSERT	2
AE	AG1006-00	#44 HOSE CLAMP	2

STEP 1

With the ignition switched off and the parking brake

set, disconnect the negative battery cable on the battery. Note: Failure to disconnect the battery may cause the CEL to be illuminated upon installation and subsequent operation completion. Do not skip this step! After disconnecting the battery, remove the engine cover.



STEP 2

Loosen the bolts for the driver side intake tube

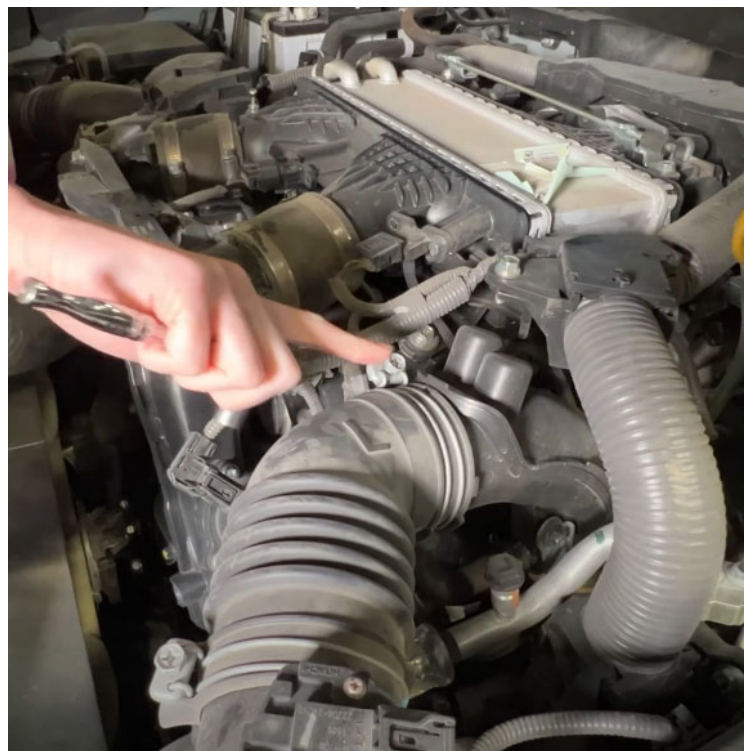

STEP 3

Disconnect the electrical connection to the MAF sensor and loosen two hose

clamps (10 mm socket).



STEP 4

Remove the driver-side Airbox and engine Air intake hose.



STEP 5

Remove the PCV hose and mounting bolt from the driver-side lower air intake tube.

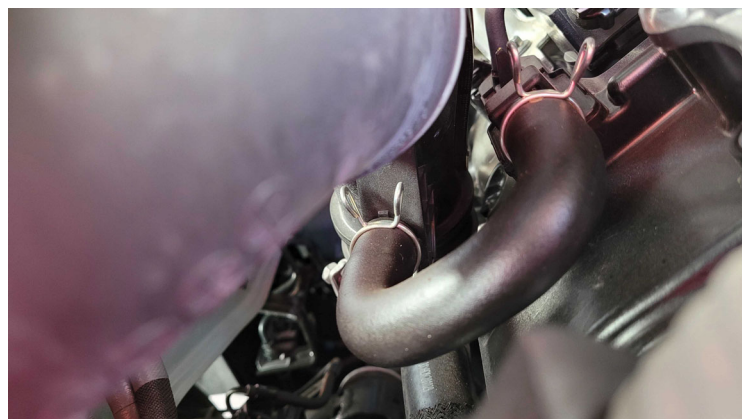

STEP 6

Remove the bolt connecting the OEM mounting bracket to the tube. Keep OEM bracket bolt for S&B Bracket installation. Next loosen the hose clamp connecting the intake tube to the turbo.



STEP 7

Unclip the line from the intake tube and remove the lower intake tube



STEP 8

Remove this bolt and put it aside as it will be reused with the S&B mounting bracket



STEP 9

Install the S&B mounting bracket with the bolt you just removed.



STEP 10

Install 3 grommets into the bottom of the S&B airbox



STEP 11

Determine if you want to install box plug (R) to the driver-side box (A). Check the testing results to determine the setup that you desire.



STEP 12

Install the tube seal(Q) and the the fender seal(C) onto the box.



STEP 13

Install the step down coupler(X) onto the intake tube. Please note the direction the hose clamps are pointing. This will make tighten the clamps easier when the tube is installed.



STEP 14

Remove the bolt for the horn to make the install of the intake box easier



STEP 15

Install the intake box making sure the grommets line up with the body



STEP 16

Insert the intake tube through the box and rotate the tube to connect the tube to the turbo inlet.



STEP 16B

Insert the CCV insert (AD) into the barb fitting on the intake tube



STEP 17

Install the PCV hose onto the S&B intake tube and secure with the clamp. Then use the included hex head bolts(AA) to secure the intake tube to the bracket.



STEP 18

Install the filter (N) with #80 hose clamp (W) onto the intake tube (B)

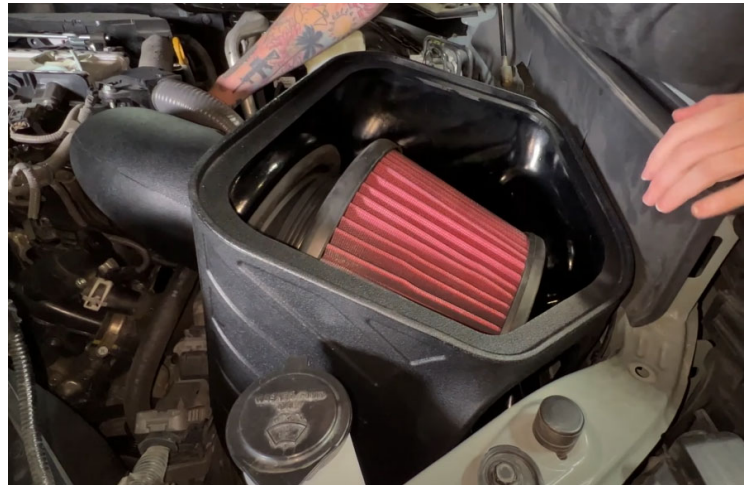

STEP 19

Tighten the hose clamps on the coupler connecting the intake tube to the turbo inlet



STEP 20

Remove the from the clear lid (E) and install the silicone Lid Seal (F) around the outside edge of the clear lid (E). Then snap into the opening of the airbox



STEP 21

Remove the MAF from the OEM intake tube. Install the MAF gasket (O), MAF mount (T), then use the included screws (P) to install the OEM MAF to the S&B intake. Reconnect the MAF sensor harness.



STEP 22

Loosen the bolts, disconnect the clip holding the MAF harness and disconnect the MAF from the OEM intake tube. You can then remove

the OEM air box from the truck.



STEP 23

Remove the PCV hose from the intake tube

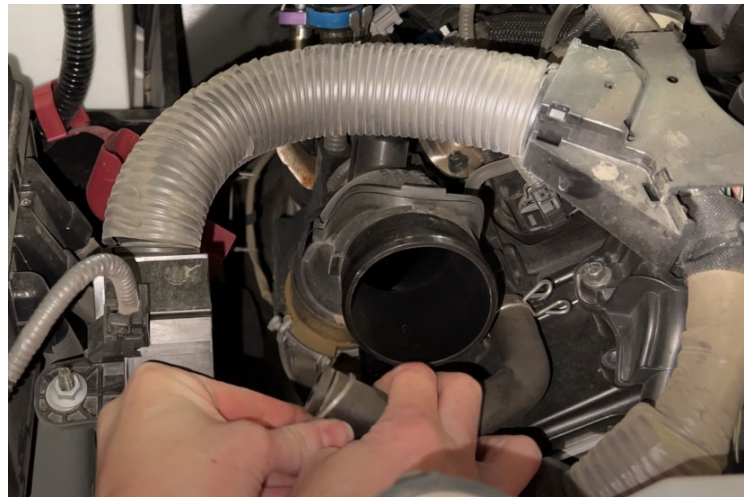

STEP 24

Loosen the hose clamp on the turbo inlet.



STEP 25

Remove the bolt securing the intake tube. This bolt will be reused. You can now remove the intake tube from the vehicle

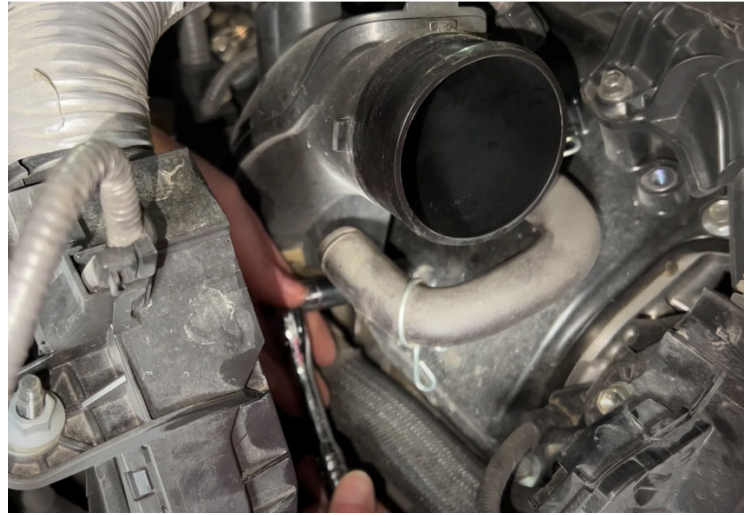

STEP 26

Install the box mounting bracket (U) to the box with the provided hardware and rubber grommets. Install the tube seal and fender seal to the box and install the box plug if you decided to install the box plug on the driver side intake box.



STEP 27

Install the step down coupler onto the intake tube with the head of the hose clamps on the opposite side of the intake tube as the MAF with the clamps facing the

passenger side body panel.



STEP 28

Install the passenger side bracket (K) onto the intake tube with the supplied washers (AB) and hex head bolts (AA).

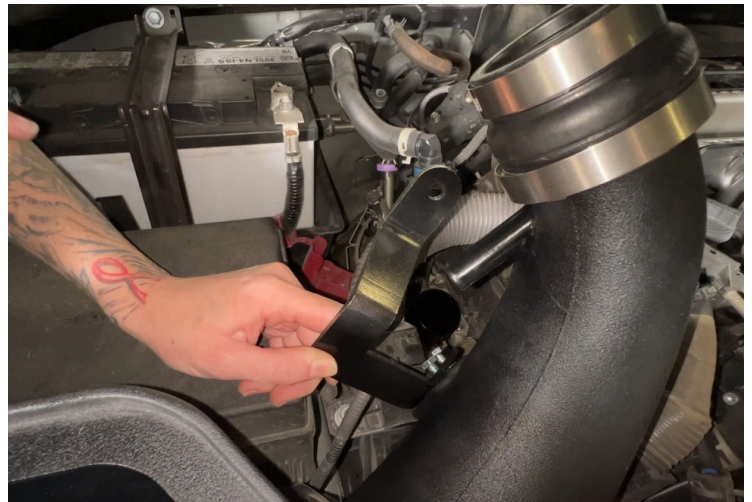

STEP 29

Lift the intake box up and rotate the intake tube onto the turbo inlet.



STEP 30

Install the filter.



STEP 30B

Insert the CCV insert (AD) into the barb fitting on the intake tube



STEP 31

Reconnect the PCV hose to the intake tube, reuse the OEM bolt to secure the bracket to the vehicle and secure the hose clamp on the turbo inlet.



STEP 32

Remove the lid film, install the silicone lid seal and install the lid into the box opening.



STEP 33

Remove the MAF from the OEM intake and install it onto the S&B intake tube with the MAF gasket (O), MAF mount (T) and included screws (P)



STEP 34

Remove the MAF from the OEM intake and install it onto the S&B intake tube with the MAF gasket (O), MAF mount (T) and included screws (P)



STEP 35

Reinstall the horn on the driver side if you loosened it. Reconnect the battery. Your install is now complete

