

INSTALL INSTRUCTIONS FOR 75-5121

BEFORE YOU START

Vehicle Applications:

2018 Jeep Wrangler JL 3.6L, Gas

2018 Jeep Wrangler JK 3.6L, Gas

2019-2024 Jeep Wrangler JL 3.6L, Gas

2020-2024 Jeep Gladiator 3.6L, Gas

Note: This intake kit may not fit with the following Aftermarket Parts installed: Body Lift or Lowering Kit, Custom Hood, Throttle Body Spacer / Upgrade, Aftermarket turbocharger

REQUIRED TOOLS

- Ratchet/Wrench
- 8mm & 10mm Socket
- Panel Popper
- Crescent Wrench
- Phillips Screwdriver
- Scissors

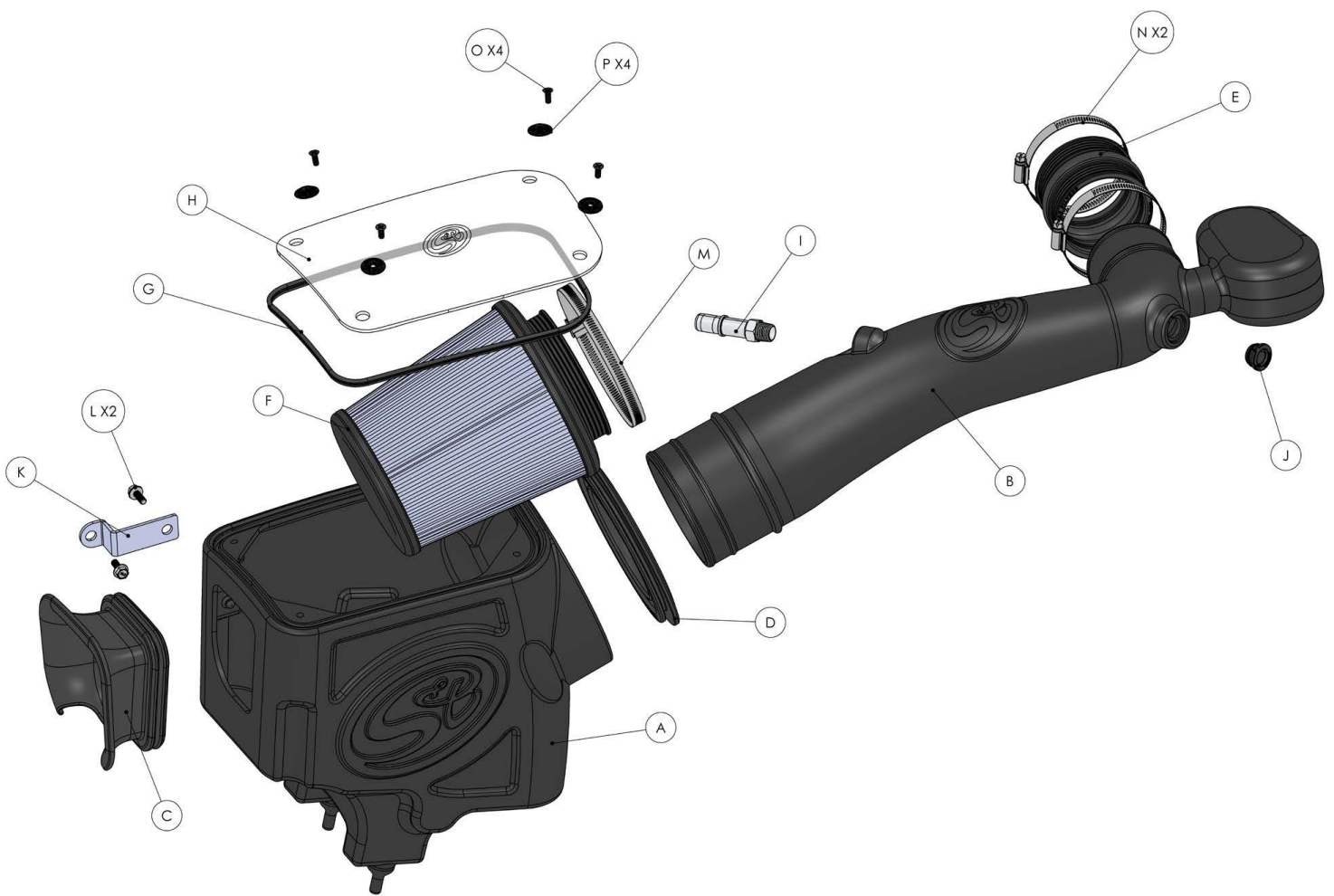

ITEM	QTY	DESCRIPTION	PART NUMBER
A	1	INTAKE BOX	AI1339B-00
B	1	INTAKE TUBE	AI1339-00
C	1	FENDER SEAL	AI2108C-00
D	1	TUBE SEAL	AI1650C-00
E	1	COUPLER	AI1601C-00
F	1	AIR FILTER	KF-1057
G	1	LID SEAL, 31"	AI1766-07
H	1	CLEAR LID	AI2120-00
I	1	QUICK CONNECT, FITTING TO 3/8" NPT	AI1701-00
J	1	IAT SENSOR GROMMET	AI1948C-00
K	1	BRACKET	AI2113-CT
L	2	BOLTS, FLANGE, M6 X16MM	AI2014-00
M	1	HOSE CLAMP #80	AG1010-00
N	2	HOSE CLAMP #56	AG1007-00
O	4	LID SCREW, 10-24	AI2005-00
P	4	LID WASHER, #10	AI2006-00

HARDWARE PACKS
HP1583-00
AG1007-00
HP1585-00
AI2113-00
AI2014-00
HP1586-00
AI1701-00
AI1948C-00
LHP0004-00
AI2005-00
AI2006-00
HP1584-00
AI2120-00
AI1766-07

AM0451-00 REV-C 11/07/2018

STEP 1

With the ignition switched off and the parking brake set. Disconnect the negative battery cable on the passenger side.

IMPORTANT: Failure to disconnect the battery for a minimum of 2 hours may cause the Check Engine Light to illuminate upon completion of the installation or subsequent operation. **DO NOT SKIP THIS STEP!**



STEP 2

Press down on the plastic clip to disengage the lock on the fitting then pull away to disconnect the CCV hose



STEP 3

Disconnect the electrical harness from the IAT sensor



STEP 4

Disconnect the three harness clips attached to the stock intake tube.

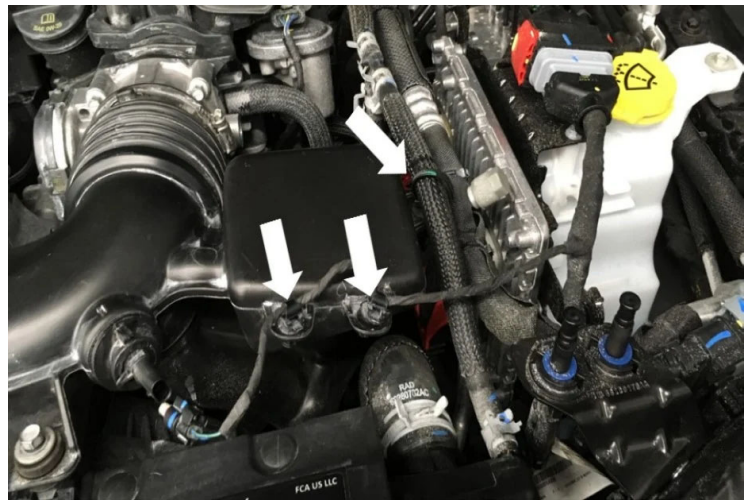

STEP 5

Remove the two bolts securing the stock intake tube to the fan shroud.

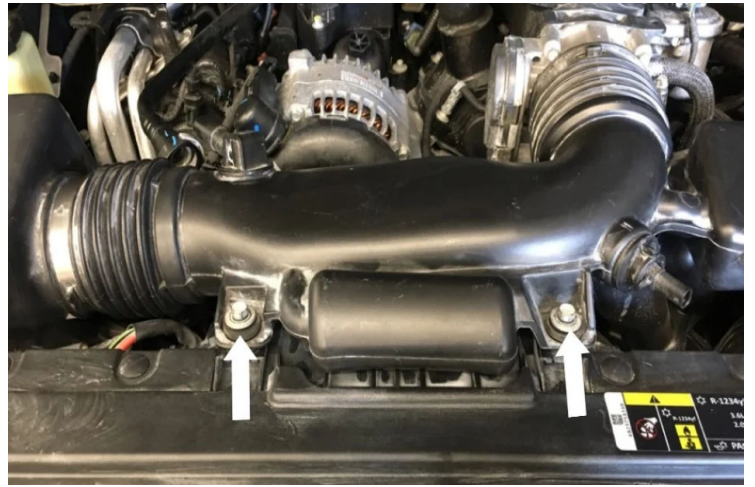

STEP 6

Loosen the hose clamp at the throttle body then pull the intake tube out and away from the throttle body.



STEP 7

Remove the bolt securing the stock intake box to the fender.



STEP 8

Lift the stock intake box to unseat the prongs from the grommets then remove the stock intake assembly from the vehicle.



STEP 9

Check to make sure the two grommets are still in place. Adjust and reinstall if necessary.



STEP 10

Remove the bolt securing the two battery tray brackets together.



STEP 11

Install the IAT Sensor Grommet (J) into the Intake Tube (B).



STEP 12A

Note the position of the IAT sensor on the stock intake tube. Turn the sensor counterclockwise to unlock then pull out.



STEP 12B

Install the IAT sensor into the Intake Tube (B). Make sure the sensor is installed in the same position as the stock intake tube.



STEP 13

Install the Quick Connect Fitting (I) into the Intake Tube (B) until hand tight then use a crescent wrench and tighten it another one to two complete turns.

IMPORTANT: Do not over tighten, as the Quick Connect Fittings can break or the threaded inserts may strip!



STEP 14

Install the Coupler (E) with the two #56 Hose Clamps (N) onto the Intake Tube (B) then tighten the hose clamp closest to the intake tube. Do not overtighten. Leave the hose clamp for the throttle body loose.



STEP 15

Install the Tube Seal (D) onto the Intake Box (A).



STEP 16

Install the Tube Seal (D) onto the Intake Box (A).



STEP 17

Install the Lid Seal (G) onto the groove on top of the Intake Box (A). Cut away any excess lid seal.



STEP 18

Install and tighten the Bracket (K) with the M6 Bolt (L) onto the Intake Box (A). Do not overtighten.



STEP 19

Align the prongs on the Intake Box (A) with the two grommets then push down on the intake box to fully seat the prongs.



STEP 20

Align the mounting hole and secure the Bracket (K) to the battery tray bracket with the M6 Bolt (L). Position the Fender Seal (C) up against the fender then tighten. Do

not overtighten.



STEP 21A

Install the Intake Tube (B) into the Intake Box (A) first then rotate the intake tube onto the throttle body.



STEP 21B

Tighten the #56 Hose Clamp (N). Do not overtighten.



STEP 22

Connect the IAT electrical harness into the IAT sensor



STEP 23

Connect the CCV hose into the Quick Connect Fitting (I). You should hear a snapping sound when the CCV hose is fully secured

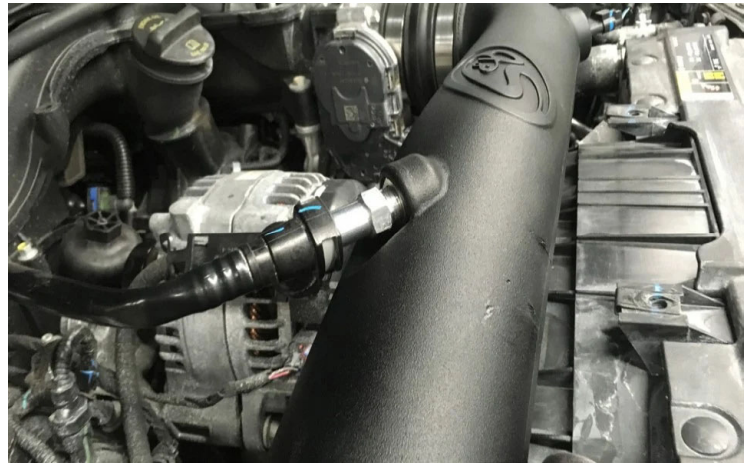

STEP 24

Install the Air Filter (F) and #80 Hose Clamp (M) onto the Intake Tube (B) then tighten the hose clamp. Do not overtighten.



STEP 25

Remove the protective covering from the Clear Lid (H)



STEP 26

Install the Clear Lid (H) onto the Intake Box (A) then install and tighten the Lid Screws and Washer (O & P). Do not overtighten.



STEP 27

Inspect your installation, make sure the kit is properly positioned and all fasteners are secured. S&B Filter recommends keeping all stock parts in case you would ever need to reinstall

the stock intake. Affix the ID label near the intake kit. The installation is now complete.



CARB EO LABEL

Please affix the included CARB-approved EO label in an area under the hood. We recommend placing it on the radiator shroud, or the underside of the vehicle's hood near the S&B product.



Vehicle CARB EO *Label Placement*

Sample Label:

 <small>PERFORMANCE FILTERS AND INTAKES</small>	
<small>Cotton (Cleanable) Dry (Disposable)</small>	
<small>Cold Air Intake System Part #:</small> 75-5121	75-5121D
<small>CARB EO #:</small>	D-590-28
<small>S&B Filters Inc., Fontana, CA, (800) 358-2639</small>	

Locations:

Under Vehicle Hood

Radiator Shroud
(Preferred location)

