

# INSTALL INSTRUCTIONS FOR 75-5108

## BEFORE YOU START

- Please read the entire product guide before proceeding.
- Ensure all parts are present.
- If you are missing any of the components, call our customer support at (909) 947-0015.
- Do not work on your vehicle while the engine is hot.
- Make sure the engine is turned off and the vehicle is in Park or the Parking Brake is set.
- Note: This intake kit may not fit with the following Aftermarket Parts installed: Body Lift or Lowering Kit, Custom Hood, Throttle Body Spacer / Upgrade

## REQUIRED TOOLS

- Ratchet with Ratchet Extension Bar
- 8mm & 10mm Wrench/Socket
- 5/16" Nut Driver or Flat Blade Screwdriver
- T20 Torx (supplied)
- Phillips Screwdriver
- Scissors
- Panel Popper

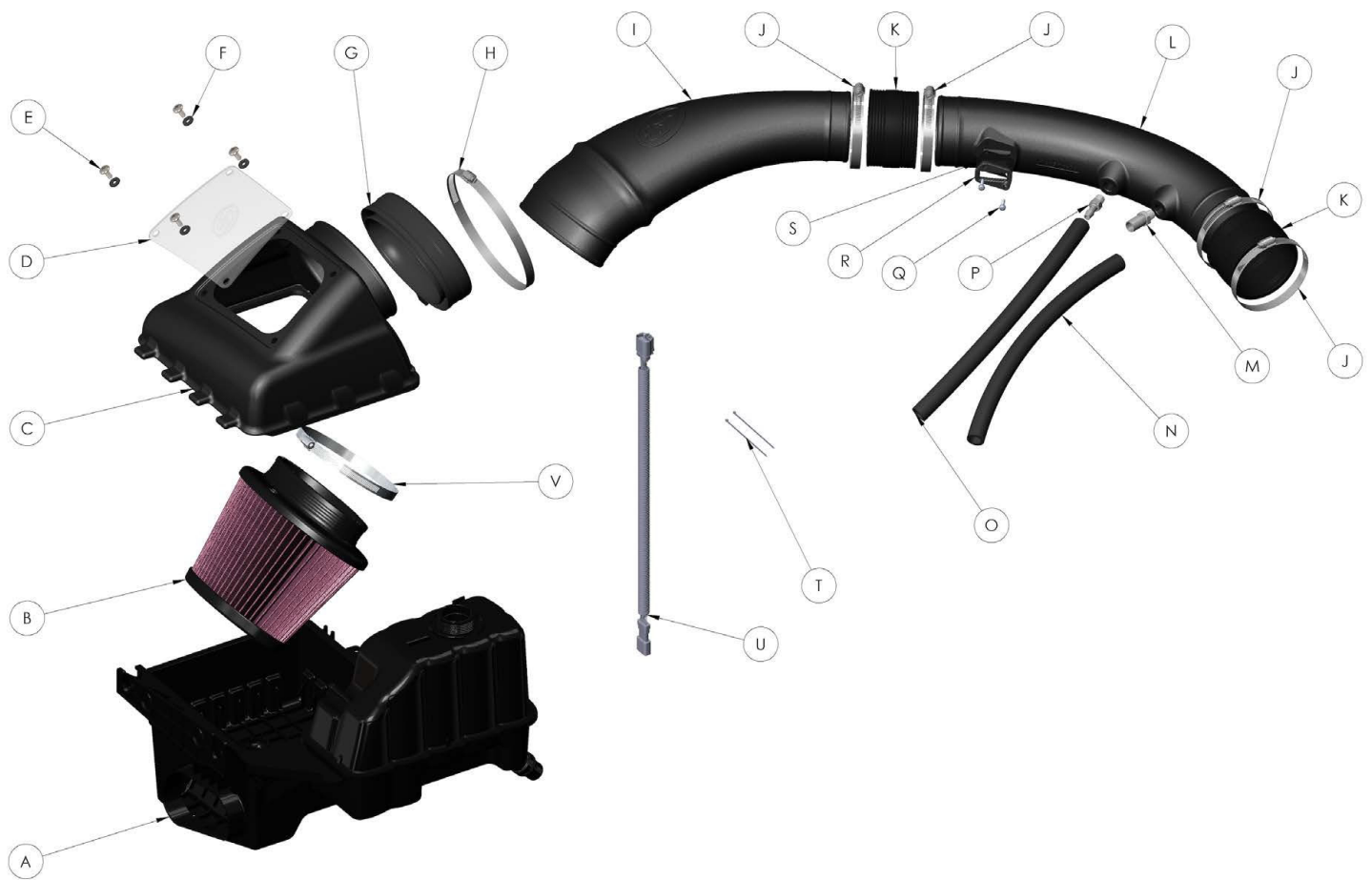

ITEM	PART NUMBER	DESCRIPTION	QTY.
A	-	STOCK INTAKE BOX (NOT INCLUDED)	1
B	KF-1058	AIR FILTER	1
C	AL1217-00	INTAKE BOX COVER	1
D	AI1606-00	CLEAR LID	1
E	AI1569-00	SCREW, TRUSS, 1/4"-20 x 5/8"	4
F	AI1571-00	RUBBER WASHER	4
G	AI1604C-00	RUBBER CUFF	1
H	AG1012-00	HOSE CLAMP, #104	1
I	AL1315-00	INTAKE TUBE (FILTER)	1
J	AG1008-00	HOSE CLAMP, #60	4
K	AI1678C-00	COUPLER	2
L	AL1314-00	INTAKE TUBE (THROTTLE BODY)	1
M	AI1709-00	HOSE BARB, 5/8"	1
N	AI1039-08	HOSE, 5/8" x 20"	1
O	AI1037-05	HOSE, 3/8" x 20"	1
P	AI1049-00	HOSE BARB, 3/8"	1
Q	AI1837-00	SCREW, SEMS, #8-32 x 3/4"	2
R	AI1822-00	MAF PLATE	1

S	AI1823-00	MAF GASKET	1
T	AI1212-00	ZIP TIE	2
U	AI1481-00	MAF EXTENSION HARNESS	1
V	AG1011-00	HOSE CLAMP, #88	1
W	AG1035-00	HOSE CLAMP, #10	2
PARTS BELOW ARE NOT SHOWN IN THE EXPLODED VIEW			
X	AI1327-00	T-20 TORX KEY	1

## STEP 1

With the ignition switched off and the parking brake set, disconnect the negative battery cable.

**IMPORTANT:** Failure to disconnect the battery for a minimum of 2 hours may cause the Check Engine Light to illuminate upon completion of the installation or subsequent operation. **DO NOT SKIP THIS STEP!**



## STEP 2

Disengage the red locking clip, press down on the tab, then pull out to disconnect the MAF sensor harness from the MAF sensor.



### **STEP 3**

Pop-out the two harness clips on the passenger side from the stock resonator intake tube.



## STEP 4

Remove CCV hose #1 from both the stock resonator intake tube and the hose barb near the firewall.

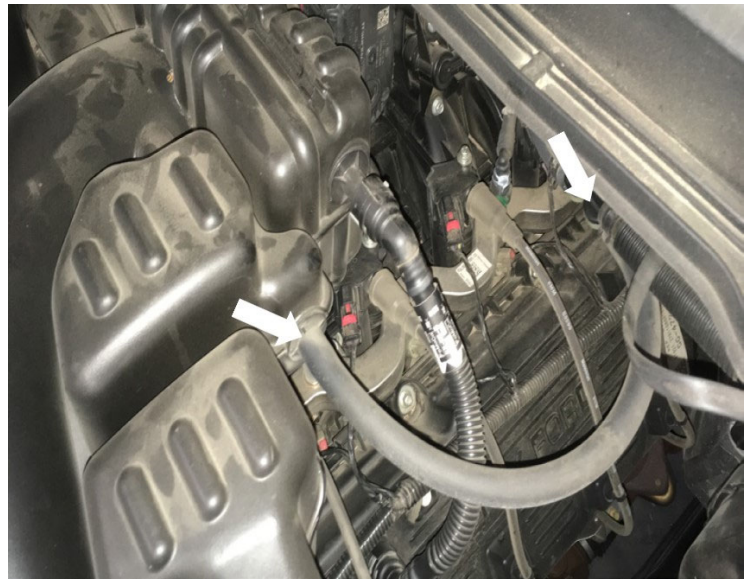

## STEP 5

Remove CCV hose #2 from both the stock resonator intake tube and the port attached to the engine. This hose has a connector that snaps onto a barb. Disengage the gray connector to release the connector from the barb.



## STEP 5 (IMAGE 2)

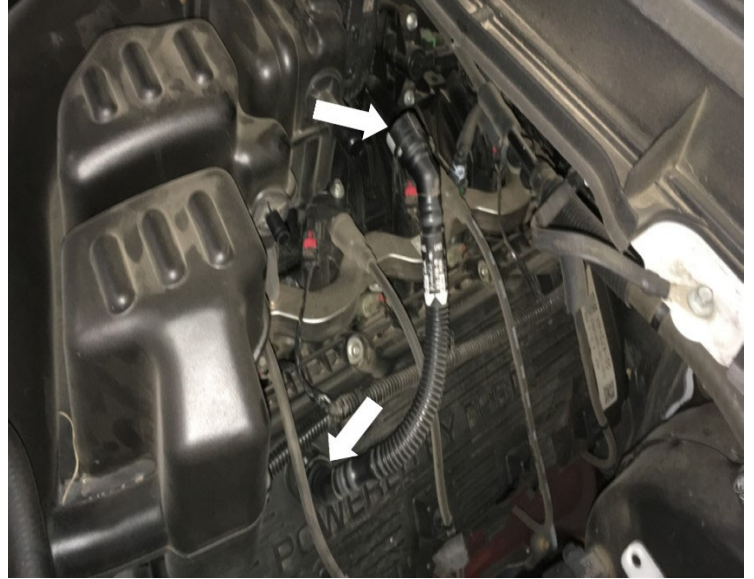

## STEP 6

Loosen the hose clamp on the stock resonator intake tube and throttle body. Disconnect the coolant hose from the hose clip on top of the stock resonator intake tube. Remove the stock resonator from the vehicle.



## STEP 6 (IMAGE 2)



## STEP 7

Unfasten the three latches securing the stock intake lid. Remove the stock intake lid and air filter from the vehicle.

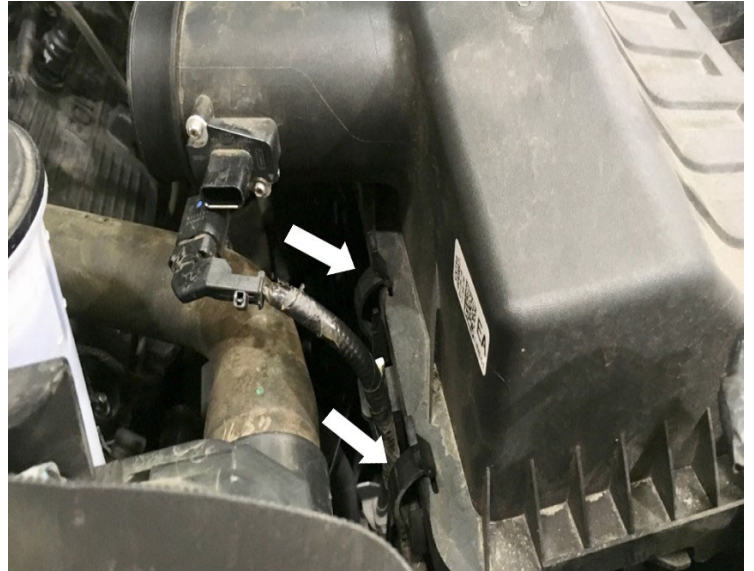

## STEP 8

Install the Rubber Cuff (G) and #104 Hose Clamp (H) onto the Intake Box Cover (C) making sure that the tab on the cuff aligns with the notch. Tighten the hose clamp. The rubber cuff will allow some movement of the

tube to accommodate engine vibrations.



## STEP 9

Insert the Air Filter Intake Tube (I) into the Intake Box Cover (C). Make sure that the tube is pushed up to the stop bead.



## STEP 10

Install the Air Filter (B) onto the Air Filter Intake Tube (I). Tighten the #88 Hose Clamp (V).



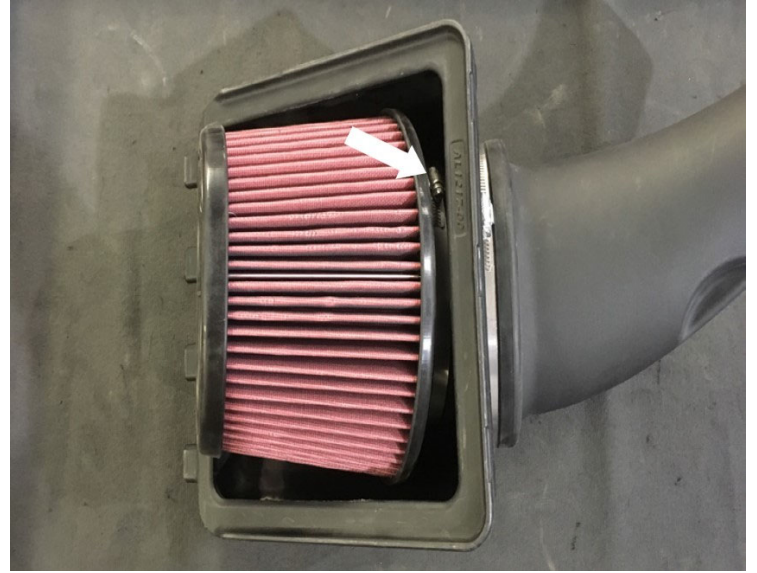

## STEP 11

Remove the protective covering from the Clear Lid (D).



## STEP 12

Install the Clear Lid (D) onto the Intake Box Cover (C) with 1/4-20 Screws (E) and Washers (F).

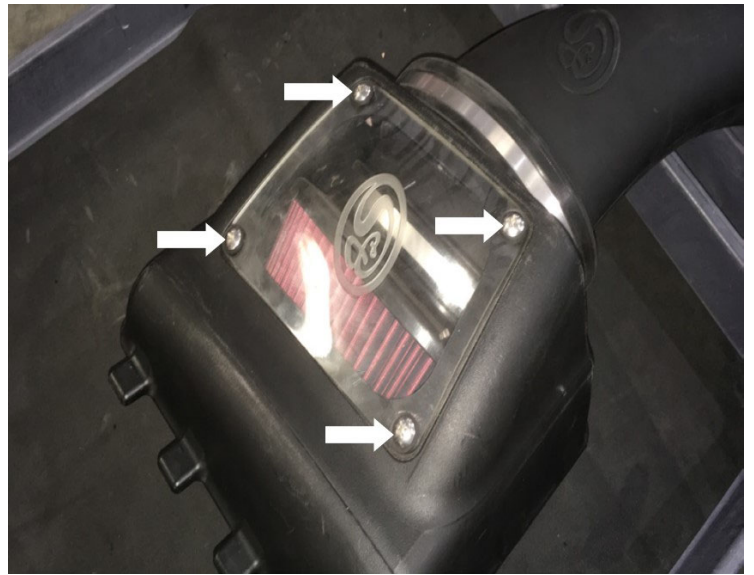

## STEP 13

Install the Coupler (K) with the #60 Hose Clamps (J) onto the Air Filter Intake Tube (I). Do not tighten any hose clamps yet. Slide the coupler onto the tube as much as possible to help make the installation easier.



## STEP 13 (IMAGE 2)



## STEP 14

Install the 3/8" Hose Barb (P) and 5/8" Hose Barb (M) into the Throttle Body Intake Tube (L) until finger tight and then give it one to two complete turns with a wrench. Install until snug and do not overtighten.



## STEP 15

Carefully remove the MAF sensor from the stock intake lid and install it onto the Throttle Body Intake Tube (L) with the 8-32 Screws (Q),

MAF Pad (R) and MAF Gasket (S).



## STEP 16

Install the Coupler (K) with the #60 Hose Clamps (J) onto the throttle body. Tighten the hose clamp on the throttle body side only. Leave the other one loose.

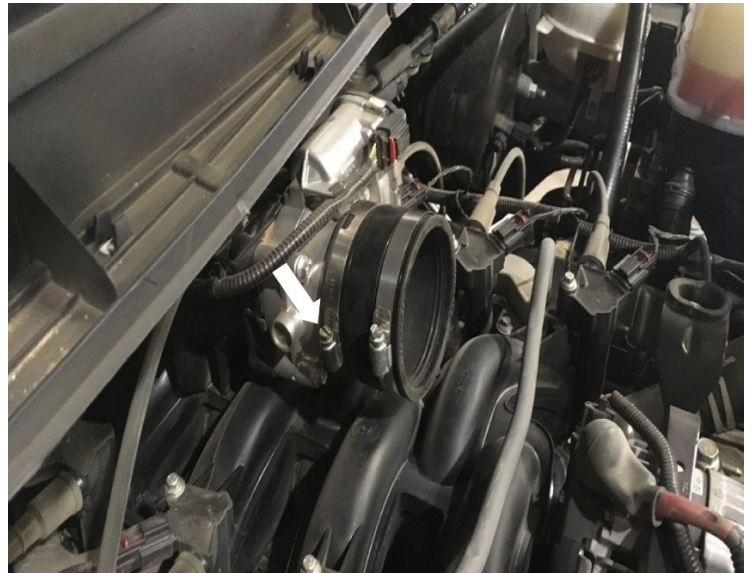

## STEP 17

Connect the MAF Extension Harness (U) into the factory MAF harness.



## STEP 18

Install the intake assembly into the factory intake box. Make sure that the tabs on the Intake Box Cover (C) are lined up with the slots on the factory intake box. Once the tabs are in the slots lower the whole intake assembly. Proper installation into the slots will reduce any vibrations.



## STEP 18 (IMAGE 2)



## STEP 19

Fasten the three latches to secure the Intake Box Cover (C).



## STEP 20

Install the Throttle Body Intake Tube (L) into the couplers on the throttle body and Air Filter Intake Tube (I). Make any final adjustments and tighten all #60 Hose Clamps (J).

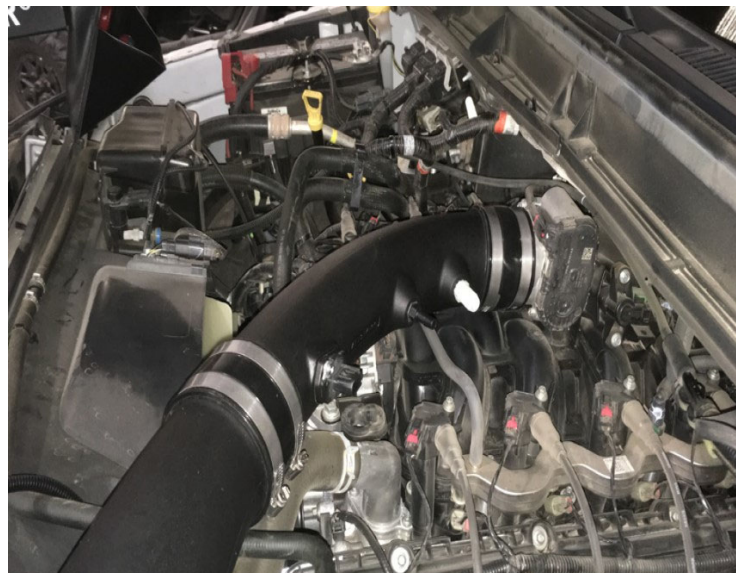

## STEP 21

Install the 3/8" Hose (O) and 5/8" Hose (N) with the two #10 Hose Clamps (W) onto the CCV port on the engine side and onto the 3/8 and 5/8 Hose Barbs (P & N) on the Throttle Body Intake Tube (L). Tighten both #10 Hose Clamps.



## STEP 22

Connect the other end of the MAF Extension Harness (U) into the MAF sensor.



## STEP 23

Secure the MAF Extension Harness (U) with the coolant hose line to away from moving or hot components that may cause damage.

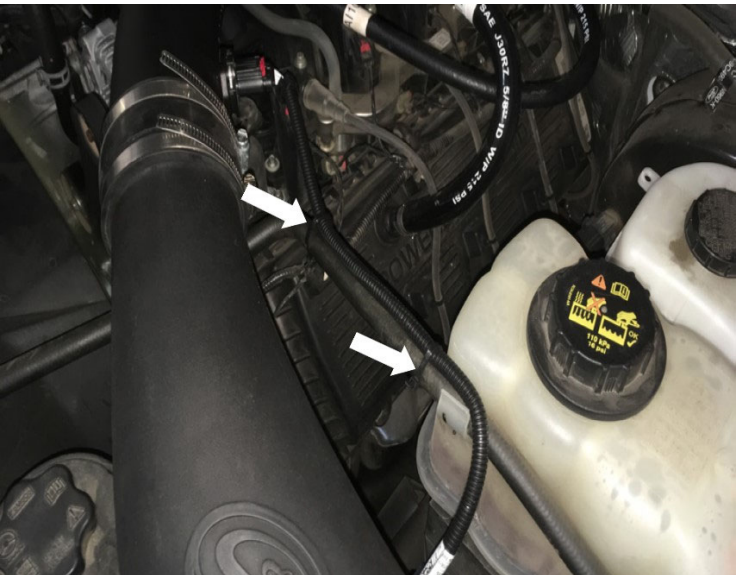

## STEP 24

Reconnect the negative terminal on the battery. Inspect your installation, make sure the kit is properly positioned and all fasteners are secure. Affix the ID/ CARB label near the intake kit. Keep all stock parts in



case you would ever need to  
reinstall the stock intake.  
The installation is now  
complete.

