

INSTALL INSTRUCTIONS FOR 75-5106

BEFORE YOU START

- Please read the entire product guide before proceeding.
- Ensure all parts are present.
- If you are missing any of the components, call our customer support at (909) 947-0015.
- Do not work on your vehicle while the engine is hot.
- Make sure the engine is turned off and the vehicle is in Park or the Parking Brake is set.
- Note: This intake kit may not fit with the following Aftermarket Parts installed: Body Lift or Lowering Kit, Custom Hood, Throttle Body Spacer / Upgrade

REQUIRED TOOLS

- 8mm, 10mm, 11mm, 13mm Wrench/Socket
- 1/16" Nut Driver or Flat Blade Screwdriver
- Phillips Screwdriver
- Panel Popper

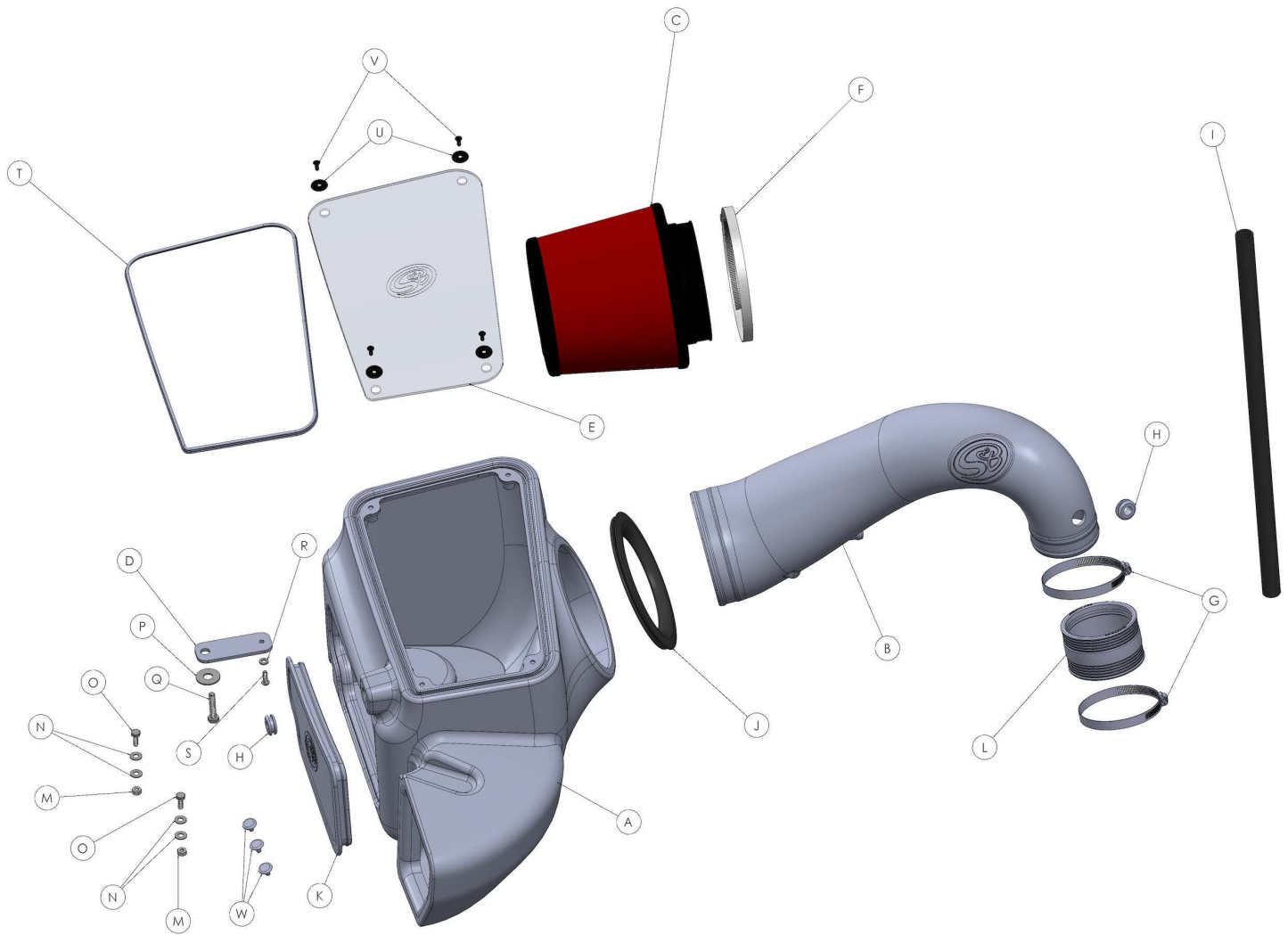

| ITEM | QTY | DESCRIPTION | PART NUMBER | HARDWARE PACKS |
|------|-----|-------------------------|-------------|----------------|
| A | 1 | AIR BOX | AL1309B-00 | HP1507-00 |
| B | 1 | INTAKE TUBE | AL1309-00 | AG1008-00 |
| C | 1 | AIR FILTER | KF-1056 | HP1295-00 |
| D | 1 | MOUNTING BRACKET | AI2009-00 | AI2005-00 |
| E | 1 | CLEAR LID | AI2008-00 | AI2006-00 |
| F | 1 | HOSE CLAMP, #104 | AG1012-00 | HP1246-00 |
| G | 2 | HOSE CLAMP, #56 | AG1008-00 | AI1068-00 |
| H | 2 | GROMMET | AI1563-00 | AI1074-00 |
| I | 1 | CCV HOSE | AI1040-06 | AI1073-00 |
| J | 1 | TUBE SEAL | AI1972C-00 | AI1163-00 |
| K | 1 | BOX PLUG | AI1947C-00 | AI1080-00 |
| L | 1 | COUPLER | AI1678C-00 | AI1563-00 |
| M | 2 | LOCKNUT, NYLOCK, 1/4-20 | AI1074-00 | AI1567-00 |
| N | 4 | WASHER, FLAT, 1/4 | AI1073-00 | HP1509-00 |
| O | 2 | SCREW, HEX, 1/4-20 | AI1068-00 | AI2009-00 |
| P | 1 | WASHER, FENDER, 1-1/4 | AI1080-00 | AI1755-00 |
| Q | 1 | SCREW, HEX, M8 | AI1163-00 | AI2014-00 |
| | | | | HP1508-00 |
| | | | | AI2008-00 |
| | | | | AI1766-06 |

| | | | |
|--------------------------------------|---|----------------------|-----------|
| R | 1 | WASHER, M6 | AI1755-00 |
| S | 1 | FLANGE BOLT, HEX, M6 | AI2014-00 |
| T | 1 | LID SEAL | AI1766-06 |
| U | 4 | WASHER, #10-24 | AI2006-00 |
| V | 4 | SCREW, #10-24 | AI2005-00 |
| W | 3 | PANEL RETAINER PIN | AI1567-00 |
| ITEMS NOT SHOWN IN THE EXPLODED VIEW | | | |
| X | 3 | ZIP TIES | AI1750-00 |

AM0352-00 REV-E 08/08/2018

STEP 1

With the ignition switched off and the parking brake set, disconnect the negative battery cable on the driver's side.

IMPORTANT: Failure to disconnect the battery for a minimum of 2 hours may cause the Check Engine Light to illuminate upon completion of the installation or subsequent operation. **DO NOT SKIP THIS STEP**



STEP 2

Disconnect the electrical harness at the Air Temperature Sensor.



STEP 3

Disconnect the crank case vent tube from the air box.

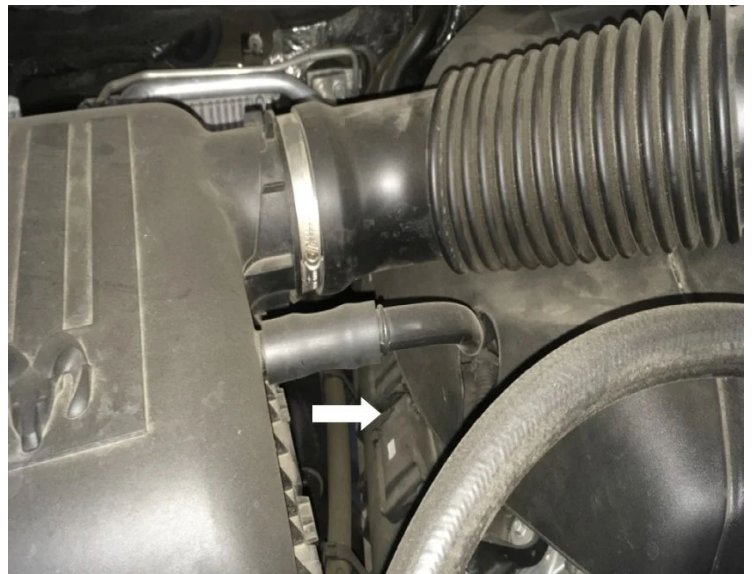

STEP 4

Loosen the clamp at the throttle body.



STEP 5

Loosen the clamp connecting the intake tube to the intake box then remove the intake tube from the vehicle.



STEP 6

Lift up on the intake box to unseat the prongs from the grommets then remove the intake box from the vehicle.



STEP 7

Lift up to remove the engine cover from the vehicle. If necessary remove the oil cap if it gets in the way.



STEP 8

Remove both the CCV hose and sleeve from the engine side.

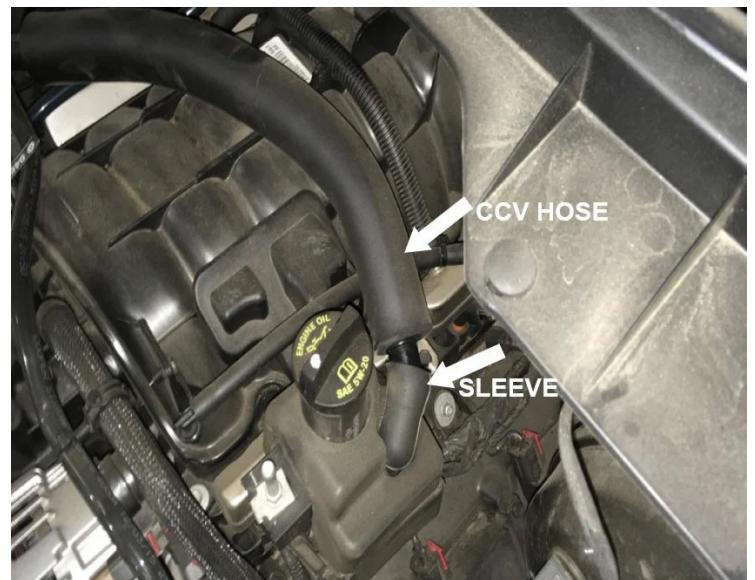

STEP 9

Remove the front passenger side wheel liner. There is a combination of screws and push pins that needs to be removed to take out the wheel liner. Before completely taking out the wheel liner, from inside the

engine compartment carefully pull out the plastic tab securing a wiring harness to the wheel liner. Remove the wheel liner from the truck. Set the screws aside, they will be reused in Step 20 when you reinstall the wheel liner.



STEP 9 (IMAGE 2)



STEP 10

Remove the four screws then remove the intake box tray from the vehicle. Set one screw aside, it will be reused

in Step 18.



STEP 10 (IMAGE 2)

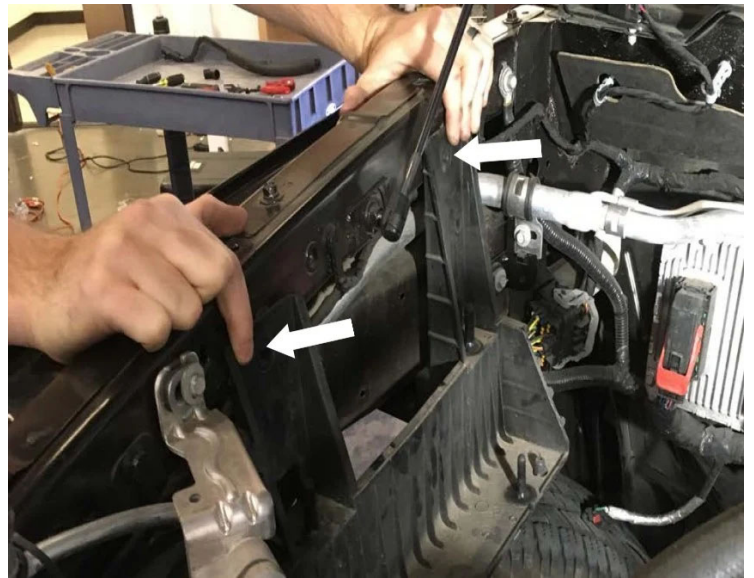

STEP 11

Install the Tube Seal (J) onto the Air Box (A).



STEP 12

Install the Grommet (H) onto the Air Box (A).



STEP 13

Install the Mounting Bracket (D) onto the Air Box (A) with the M6 Flange Bolt (S).



STEP 14

Determine if you want to install the Box Plug (K) onto the Air Box (A) or leave it open. See the "Air Box Plug" note on Page 2 for more information. If the Box Plug is desired, simply press the Box Plug into the box opening until it snaps into place.



STEP 15

Carefully rotate the IAT sensor counterclockwise and remove the sensor from the stock intake tube. Remove the O-Ring from the IAT sensor and install the IAT sensor into the Intake Tube (B) and Grommet (H). The tab on the IAT sensor on should be positioned straight up at 90 degrees.



STEP 15 (IMAGE 2)



STEP 16

Place the Air Box (A) into the vehicle. Line up the fender inlet and mounting holes.



STEP 17

Install the M8 Screw (Q) and Washer (P) through the Mounting Bracket (D) to secure the Air Box (A). Do not fully tighten yet.



STEP 18

Install the screw removed in Step 10 to secure the Air Box (A) to the side fender. Do not fully tighten yet.



STEP 19

If needed, move the AC line away from the Air Box (A) and line up the AC line with the cut out on the scoop by loosening the screw on the bracket. Make any final

adjustments then fully tightening the mounting screws in Step 17 & 18.



STEP 20

Reconnect the sensor into the wheel liner from Step 9 and secure the wheel liner with the airbox with the 1/4-20 Screws (O), Washers (N), and Locknuts (M). Leave the Screws loose so adjustments can be made while reinstalling the wheel liner. Reinstall the wheel liner and the screws. Use the Panel Retainer Pins (W) to replace any pins broken during the removal process. You will need two 11mm Socket or Wrench to tighten both the screw and locknut.



STEP 20 (IMAGE 2)



STEP 21

Install the Coupler (L) and #56 Hose Clamps (G) onto the throttle body. Tighten the hose clamp on the throttle body side only.



STEP 22

Insert the CCV Hose (I) into the CCV port on the engine side. Zip Tie (X) the CCV Hose to the fuel line on top of the intake manifold to ease the installation of the engine cover in Step 23.

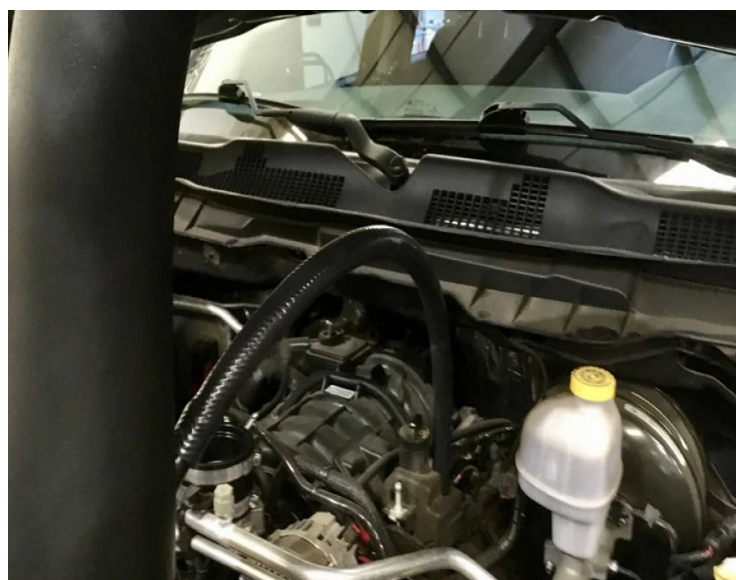

STEP 23

Reinstall the engine cover and route the other end of the CCV Hose (I) towards

the engine cover cutout on the passenger side.



STEP 24

Place the Air Filter (C) into the Air Box (A). When placing the air filter into the airbox, have the filter go in the long edge first.



STEP 25

If necessary, use some of the provided grease around the Tube Seal (J) so the Intake Tube (B) can go through the tube seal easier. Be careful not to get any of the grease on the Air Filter (C). Feed

the Intake Tube (B) into the Air Box (A) then connect the other end of the intake tube into the Coupler (L). Slide the Air Filter (C) onto the Intake Tube (B) and tighten the #56 and #104 Hose Clamps (G & F).

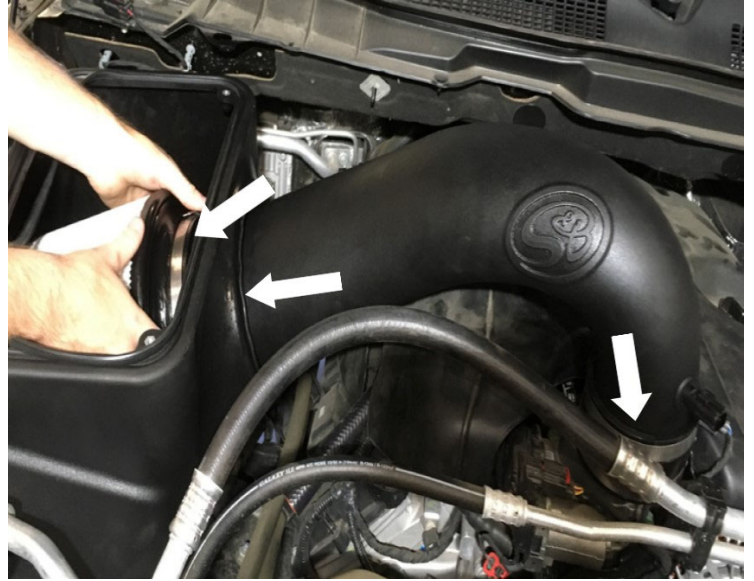

STEP 26

Insert the CCV Hose (I) onto the bung on the Intake Tube (B).



STEP 27

Install the Lid Seal (T) into the grooves on top of the Air Box (A).



STEP 28

Peel off the protective covering on the Clear Lid (E).



STEP 29

Place the Clear Lid (G) on top of the Intake Box (A) and secure with the 10-24 Screws (I) and Lid Washers (H).

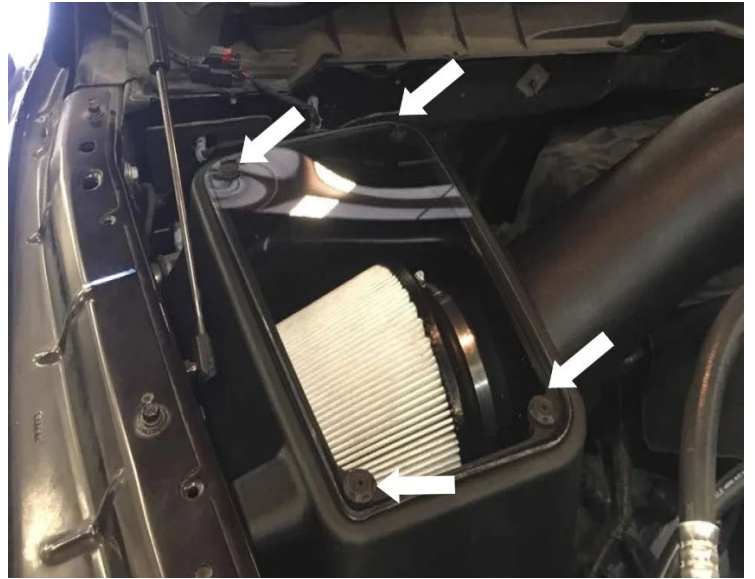

STEP 30

Reconnect the electrical connector back into the IAT sensor.



STEP 31

Reconnect the negative battery cable. Inspect your installation, make sure the kit is properly positioned and all fasteners are secured. Keep all stock parts in case you would ever need to

reinstall the stock intake assembly. Affix the ID label near the intake kit. The installation is now complete.

