

# INSTALL INSTRUCTIONS FOR 75-5088

## BEFORE YOU START

This intake kit may not fit with the following Aftermarket Parts installed:

Body Lift or Lowering Kit

Custom Hood

Throttle Body Spacer / Upgrade

## REQUIRED TOOLS

- 8mm, 10mm and 11mm Wrench/Socket
- 1/4", 5/16" Nut Driver or Flat Blade Screwdriver
- T20 Torx (**supplied**)
- Phillips Screwdriver
- Crescent Wrench
- Pliers
- Panel Popper

- Please read the entire product guide before proceeding.
- Ensure all parts are present.
- If you are missing any of the components, call our customer support at (909) 947-0015.
- Do not work on your vehicle while the engine is hot.
- Make sure the engine is turned off and the vehicle is in Park or the Parking Brake is set.

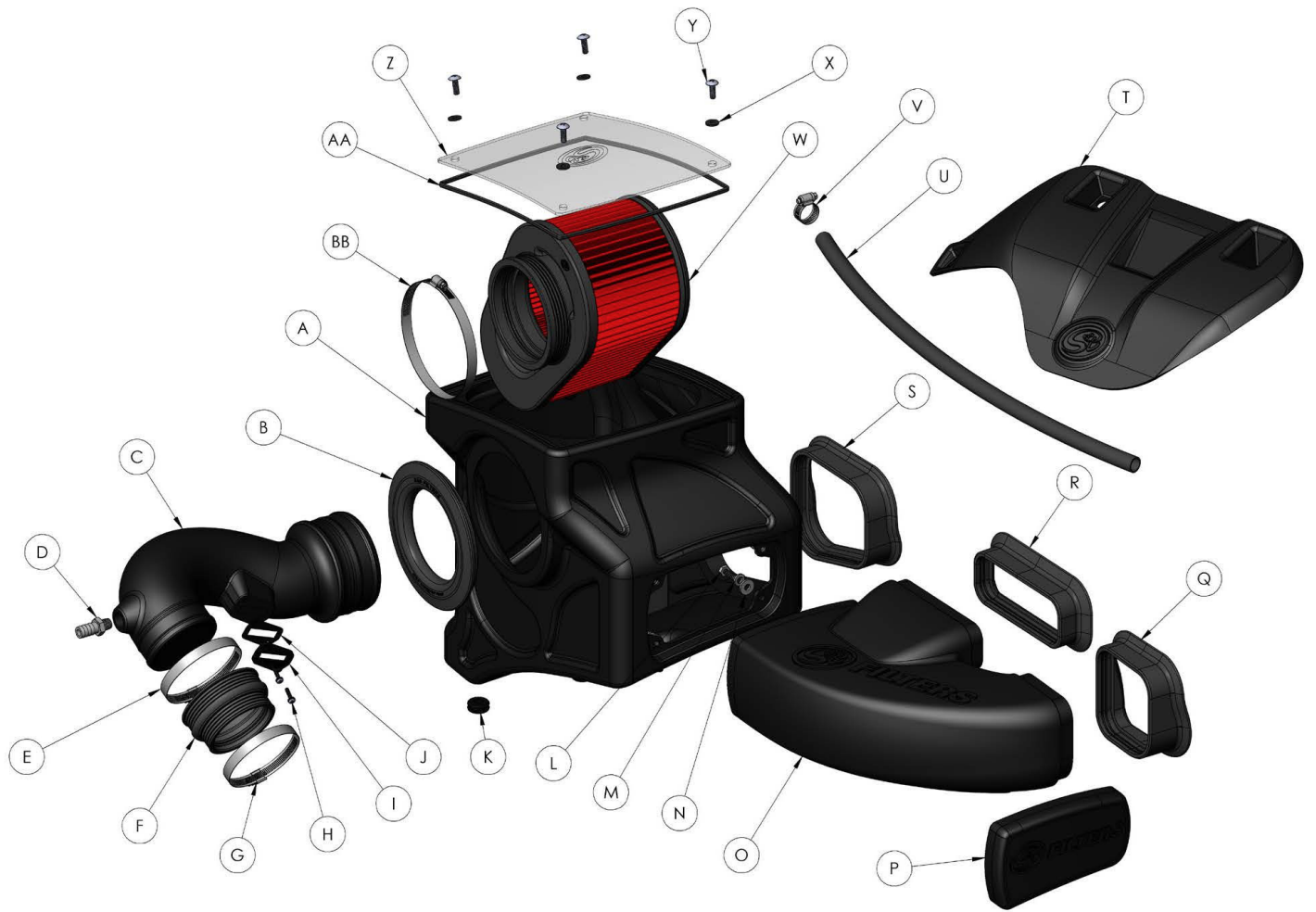

ITEM	QTY	DESCRIPTION	PART NUMBER	HARDWARE PACKS
A	1	AIR BOX	AL1260-00	HP1485-00
B	1	TUBE SEAL	AI1650C-00	AG1019-00
C	1	INTAKE TUBE	AL1294-00	AG1007-00
D	1	HOSE BARB, 1/2" BARB X 1/4" THREAD	AI1116-00	HP1295-00
E	1	HOSE CLAMP, #56	AG1019-00	AI2005-00
F	1	COUPLER	AI1316C-00	AI2006-00
G	1	HOSE CLAMP, #52	AG1007-00	HP1188-00
H	2	SCREW, SEMS, #8-32 X 3/4"	AI1837-00	AI1068-00
I	1	MAF PAD	AI1822-00	AI1309-00
J	1	MAF GASKET	AI1823-00	AI1073-00
K	2	AIR BOX GROMMET	AI1563-00	HP1444-00
L	4	SCREW, HEX, 1/4"-20 X 3/4"	AI1068-00	AI1563-00
M	4	WASHER, LOCK, 5/16"	AI1309-00	AI1327-00
N	4	WASHER, FLAT, 1/4"	AI1073-00	HP1407-00
O	1	AUXILIARY SCOOP	AL1262-00	AI1837-00
P	1	BOX PLUG	AL1263-00	AI1822-00
Q	1	SCOOP FENDER SEAL #2	AI1827C-00	AI1823-00
R	1	SCOOP FENDER SEAL #1	AI1826C-00	HP1486-00
				AI1116-00
				AG1000-00
				AI1038-03
				HP1487-00
				AI1893-00
				AI1766-04

S	1	AIR BOX FENDER SEAL	AI1825C-00
T	1	S&B ENGINE COVER	AL1296-00
U	1	RUBBER HOSE	AI1038-03
V	1	HOSE CLAMP, #8	AG1000-00
W	1	AIR FILTER	KF-1064
X	4	LID WASHER	AI2006-00
Y	4	SCREW, FLAT, #10-24 X 1/2"	AI2005-00
Z	1	CLEAR LID	AI1893-00
AA	1	LID SEAL	AI1766-04
BB	1	HOSE CLAMP, #80	AG1010-00
ITEMS BELOW ARE NOT SHOWN IN THE EXPLODED VIEW			
CC	1	T20 TORX KEY	AI1327-00

AM0342-00 REV-D 07/26/2018

## STEP 1

With the ignition switched off and the parking brake set, disconnect the negative battery cable.

**IMPORTANT:** Failure to disconnect the battery for a minimum of 2 hours may cause the Check Engine Light to illuminate upon completion of the installation or subsequent operation. **DO NOT SKIP THIS STEP!**



## STEP 2

Disengage the red locking

clip, press down on the tab, then pull out to disconnect the MAF sensor harness from the MAF sensor.

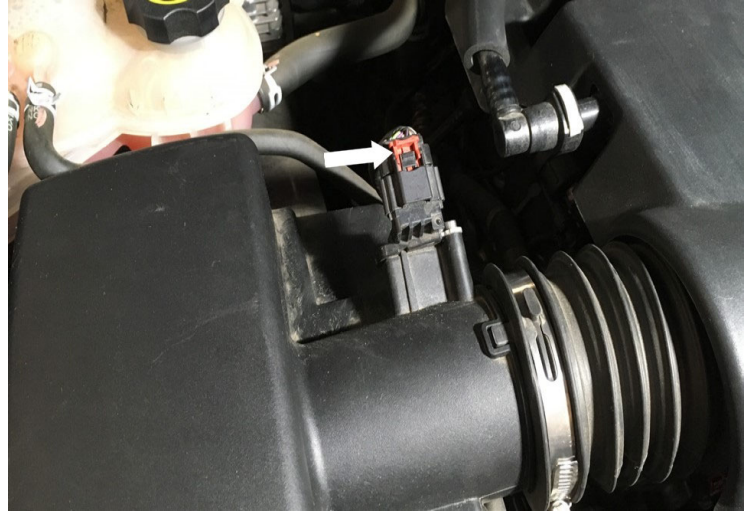

### STEP 3

Remove the CCV hose line connected to the stock engine cover by pressing down on the clip and pulling out. Remove the CCV port on the engine side by using pliers to open up the hose clamp and pulling off both the CCV hose line and rubber elbow.



### STEP 3 (IMAGE 2)



### STEP 4

Loosen the hose clamp connected to the stock intake box and disconnect the intake tube.

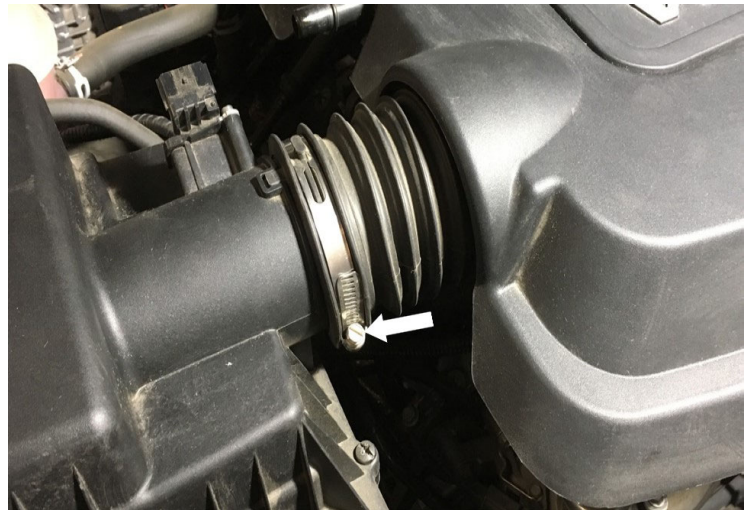

## STEP 5

Loosen the hose clamp connected to the throttle body. The throttle body is located underneath the engine cover.



## STEP 6

Loosen the four screws securing the engine cover.



## STEP 7

Twist and remove the oil cap.



## STEP 8

Lift up and remove the engine cover from the vehicle.



## STEP 9

Reinstall the oil cap.



## STEP 10

Disconnect the wire harness clip on the stock intake box lid.



## STEP 11

Loosen the four screws then remove the stock intake box lid.





## STEP 12

Remove the air filter from the stock intake box.

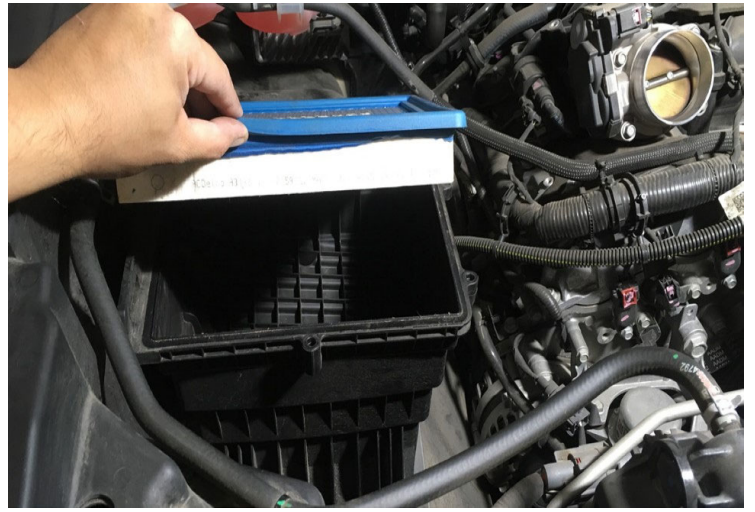

## STEP 13

Remove the two mounting nuts securing the stock intake box. Set the mounting nuts aside, they will be reused in Step 28.



## STEP 14

Disconnect the stock air inlet from the stock intake box by squeezing in the tabs. Remove the stock intake box from the vehicle first, then remove the stock air inlet from the fender wall.



## STEP 14 (IMAGE 2)



## STEP 15

Double-check to make sure the stock grommet is still on the truck and didn't fall out.



## STEP 16

Install the Hose Barb (D) into the Intake Tube (C) until finger tight, then turn it one to two complete turns.



## STEP 17

Carefully remove the MAF sensor from the stock intake box lid. Use the supplied 8-32 Screws (H), MAF Pad (I), Gasket (J) to install the sensor onto the Intake Tube (C). Do not overtighten.



## STEP 18

Remove the metal bushings from the stock intake box. Set the metal bushings aside, they will be reused in

Step 20.



## STEP 19

Install the Air Box Grommets (K) into the Airbox (A).



## STEP 20

Install the metal bushings removed in Step 18 into the Airbox Grommets (K).



## STEP 21

Insert the Airbox Fender Seal (S) into the Airbox (A).



## STEP 22

Install the Tube Seal (B) onto the Airbox (A).



## STEP 23

Determine if you want to install the Box Plug (P) “Step 23” or Auxiliary Scoop (O) “Step 24” onto the Airbox (A). See the “Air Box Plug” note to decide if this is the desired setup. To install the box plug, install the 1/4-20 Screws (L), Lock Washers (M), and Washers (N) from inside the airbox then proceed to Step 25.



## STEP 24A

To install the auxiliary scoop, first install the Scoop Fender Seal #1 and #2 (R & Q) onto the Auxiliary Scoop (O).



## STEP 24B

Place the Auxiliary Scoop (O) into the truck underneath the coolant tank. The Auxiliary Scoop will be secured to the Airbox (A) later, in Step 29.



## STEP 25

Install the Coupler (F) onto the throttle body with Hose Clamps #56 and #52 (E & G).

**Tighten the #52 Hose Clamp by the throttle body. Leave the #56 Hose Clamp loose.**



## STEP 26

Insert the Intake Tube (C) into the Airbox (A).



## STEP 27A

Installed the intake assembly into the truck. Ensure that the threaded studs go through the Airbox Grommets (K) and the prong on the airbox goes into the stock grommet. Insert the Intake Tube into the Coupler (F) up until the stop bead. Leave the hose clamps loose.



## STEP 27B

Make sure the Airbox Fender Seal (S) is sitting flat against



the fender wall and not being pushed upward.



## STEP 28

Reinstall the two mounting nuts removed in Step 13.



## STEP 29

Skip to Step 30 if you installed the Box Plug (P) in Step 23. If you installed the Auxiliary Scoop (O), install the 1/4-20 Screws (L), Lock Washers (M), and Washers (N) from inside the Airbox (A).



## STEP 30

Tighten the #56 Hose Clamp (E) on the Intake Tube (C) side.

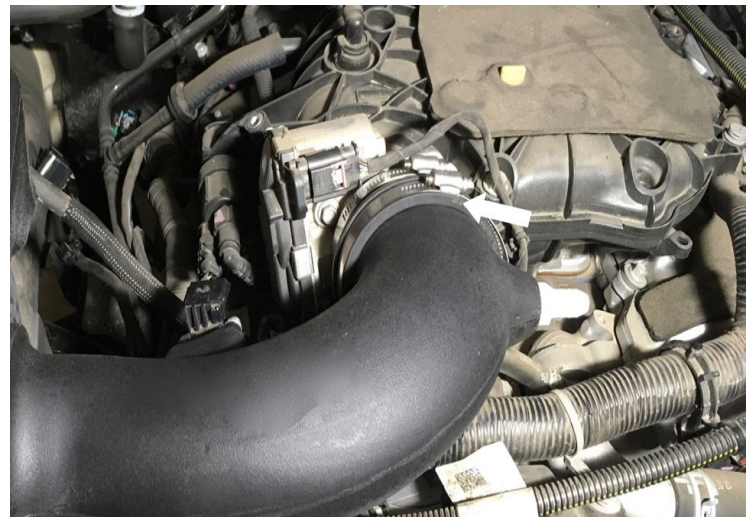

## STEP 31

Place the Air Filter (W) into the Airbox (A). Rotate the air filter into position as shown below and tighten the

#80 Hose Clamp (BB).

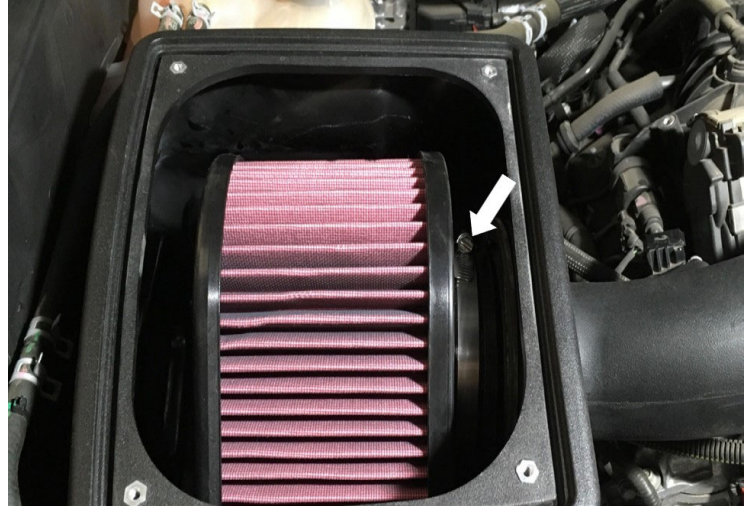

## STEP 32

Press the Lid Seal (AA) into the groove in the Airbox (A).

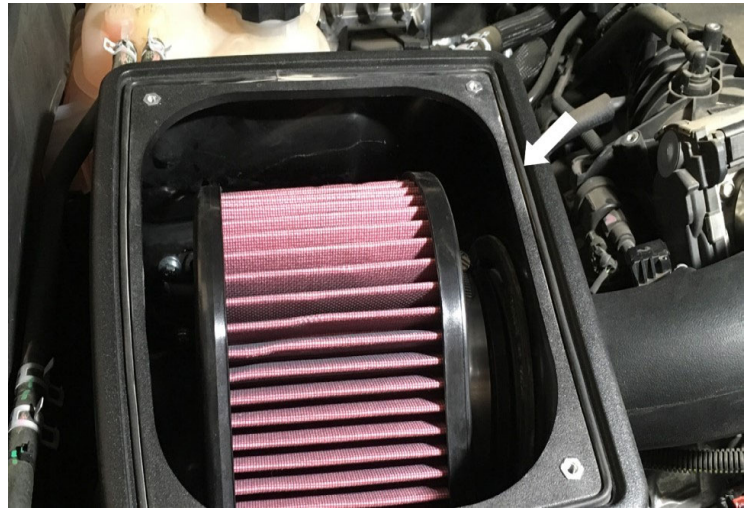

## STEP 33

Remove the protective covering on the Clear Lid (Z).



## STEP 34

Install the Clear Lid (Z) onto the Airbox (A) with the 10-24 Screws (Y) and Lid Washers (X).



## STEP 35

Reconnect the MAF sensor harness into the MAF sensor and engage the red locking clip.



## STEP 36

Install the Rubber Hose (U) into the Hose Barb (D) and into the CCV port on the engine side with a #8 Hose Clamp (V).

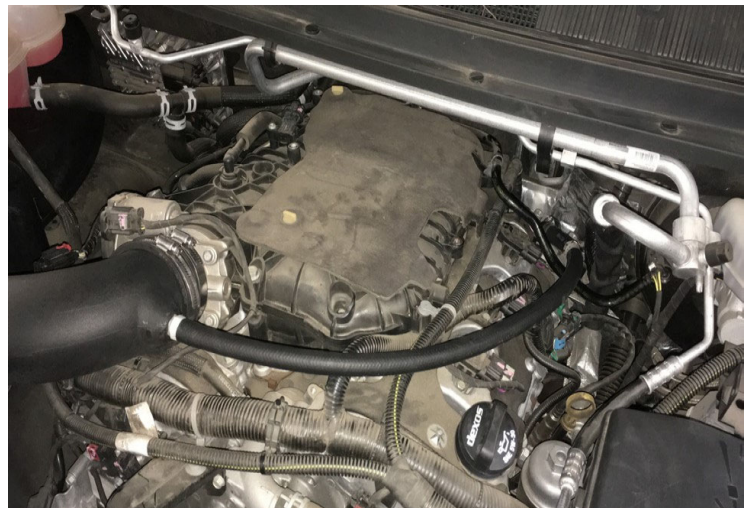

## STEP 37

(Optional) Decide whether or not you want to install the S&B Engine Cover (T). If you do not want to install the S&B Engine Cover (T), skip to Step 43. To install the

engine cover you have to transfer all the mounting hardware and grommets from the stock engine cover. The top two mounting points have a grommet and screw, the side mounting point has a bushing, grommet, and screw that needs removing.

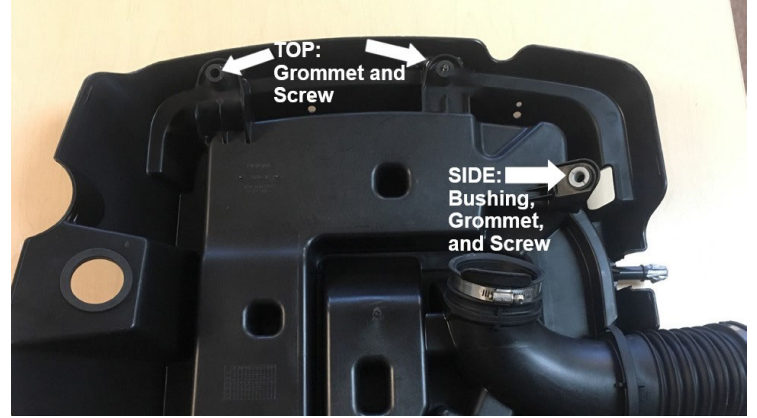

## STEP 37 (IMAGE 2)



## STEP 38

Press out the screws from the top two mounting locations, then remove the stock rubber grommets. Set these aside, they will be installed into the S&B Engine Cover (T) in Step 40.



**STEP 38 (IMAGE 2)**



## STEP 39

To remove the side mounting hardware on the side, remove the metal bushing first and then the rubber grommet. Set these aside, they will be installed into the S&B Engine Cover (T) in Step 41.



## STEP 40

Install the two grommets, removed in Step 38, onto the two mounting locations at the top of the S&B Engine Cover (T), then press the two stock screws into the grommets.



## STEP 41



Install the grommet removed in Step 39 onto the mounting location at the side of the S&B Engine Cover (T), then press the metal bushing into the grommet.



## STEP 42

Align the screws with the stock mounting locations and secure the S&B Engine Cover (T) by tightening all three screws.



## STEP 43

(Optional) Remove the stock front mounting bracket used to support the stock engine cover. This bracket is no longer needed. To remove it loosen the two screws and

disconnect the harness mounting clip.



## STEP 43 (IMAGE 2)



## STEP 44

Reconnect the negative terminal on the battery. Inspect your installation, make sure the kit is properly positioned and all fasteners are secure. Keep all stock parts in case you ever need to reinstall the stock intake assembly. Affix the ID label near the intake kit. The installation is now complete.

