

INSTALL INSTRUCTIONS FOR 75-5083

BEFORE YOU START

- Please read the entire product guide before proceeding.
- Ensure all parts are present.
- If you are missing any of the components, call our customer support at (909) 947-0015.
- Do not work on your vehicle while the engine is hot.
- Make sure the engine is turned off and the vehicle is in Park or the Parking Brake is set.
- This intake kit may not fit with the following Aftermarket Parts installed: Body Lift or Lowering Kit, Custom Hood, Throttle Body Spacer / Upgrade

REQUIRED TOOLS

- 10mm, 13mm Wrench & Socket
- 5/16" Nut Driver & 1/4" Nut Driver or Flat Blade Screwdriver
- Phillips Screwdriver, Pliers or Channel Locks

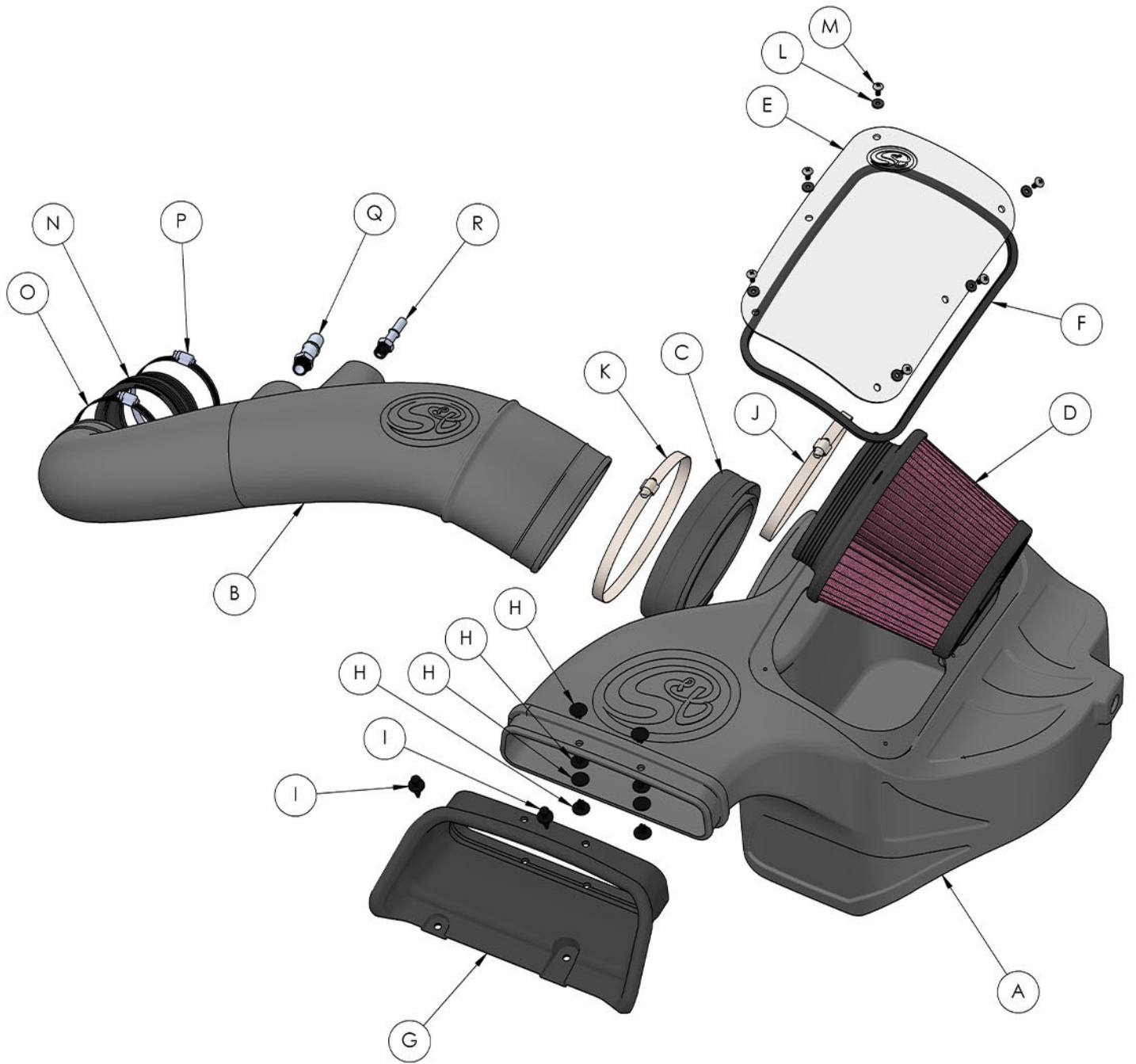

ITEM NO.	QTY.	PART NUMBER	Description
A	1	AL1246B-00	Air Box
B	1	AL1256-00	Intake Tube
C	1	AI1604C-01	Rubber Cuff
D	1	KF-1058	Air Filter
E	1	AI1760-00	Clear Lid
F	1	AI1636-07	Lid Seal
G	1	AI1758C-00	Front Inlet
H	8	AI1762-00	Plastic Rivet, Interlocking Shank, 1/4" dia
I	2	AI1763-00	Plastic Rivet, 11/16 dia head, 1/4 dia x 7/8 long stem
J	1	AG1011-00	Hose Clamp, #88
K	1	AG1012-00	Hose Clamp, #104
L	6	AI1540-00	Sealing Washer, #10, .50 OD x .078" THK, Santoprene
M	6	AI1539-00	Truss Head Philips Machine Screw, #10-24 x .50" Lg, 18-8 SS
N	1	AI1581C-00	Coupler, Step, Silicone, 3.75 X 3.375 X 2.00 Long
O	1	AG1008-00	Hose Clamp, #60
P	1	AG1019-00	Hose Clamp, #56
Q	1	AI1701-00	Fitting, Quick Connect, 5/8 Dia-3/8 NPT
R	1	AI1776-00	Fitting, Quick Connect, 3/8 Dia-1/4 NPT

STEP 1

With the ignition switched off and the parking brake set, disconnect the negative battery cable on the battery.

IMPORTANT: Failure to disconnect the battery for a minimum of 2 hours may cause the Check Engine Light to illuminate upon completion of the installation or subsequent operation. **DO NOT SKIP THIS STEP!**



STEP 2

Loosen the hose clamp by the stock airbox and pull the tube out.

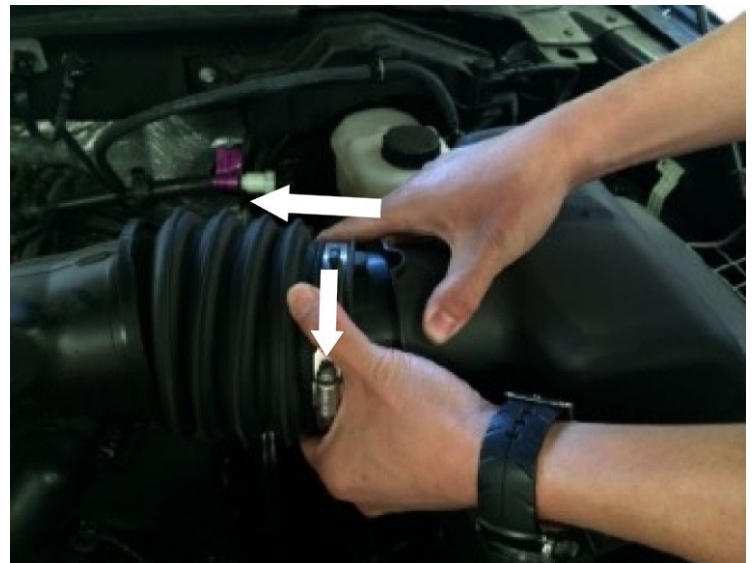

STEP 3

Unlatch the two latches on the stock airbox.

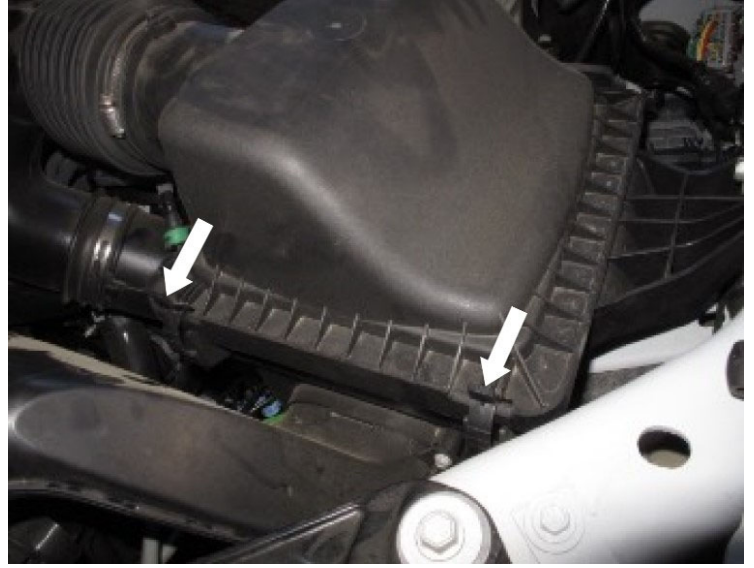

STEP 4

Lift and remove both the lid and air filter.



STEP 5

Disconnect the vacuum line. Push down on the black clip and pull the hose connector out of the hose barb.

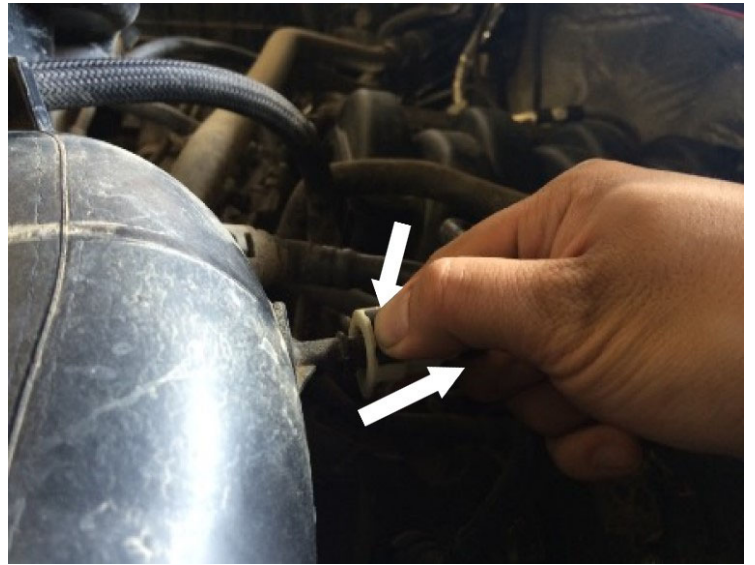

STEP 6

Pull-on the lever to remove the PCV hose from the hose barb.



STEP 7

Remove the retaining bolt on the stock air box using a 13mm socket.

Note: The retaining bolt will be reused again in Step 18. Disconnect any harness clips attached to the stock airbox.

Use a panel popper or flat blade screwdriver.



STEP 7 (IMAGE 2)



STEP 8

Remove the plastic rivets on the stock air scoop using a flat head screwdriver.



STEP 9

Lift and remove the stock airbox.



STEP 10

Loosen the hose clamp at the throttle body.



STEP 11

Remove the stock air tube.



STEP 12

Remove the grommet and metal bushing from the stock airbox. Removing the metal bushing first will help make removing the grommet easier.

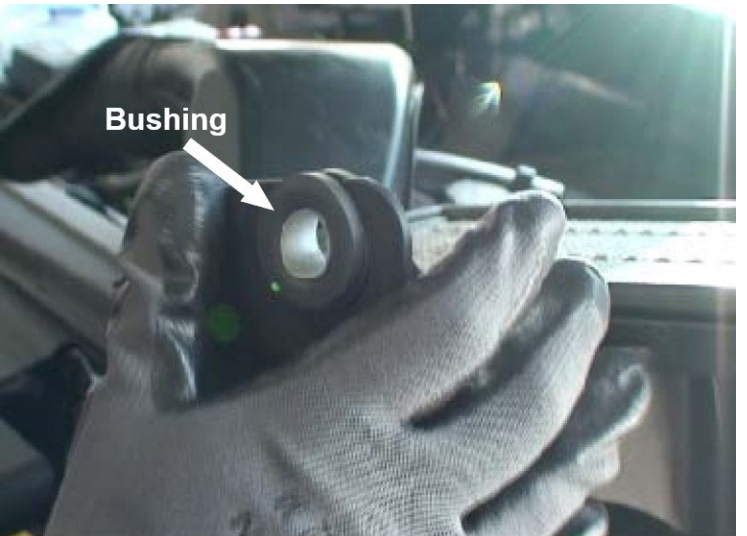

STEP 13

Install the grommet into Airbox (A) first and then install the metal bushing from the inside.



STEP 14

Install the Rubber Cuff (C) and Hose Clamp #104 (K) onto the side of the Airbox (A). Make sure that the rubber pull tab on the tube seal is on the bottom. Tighten the hose clamp.

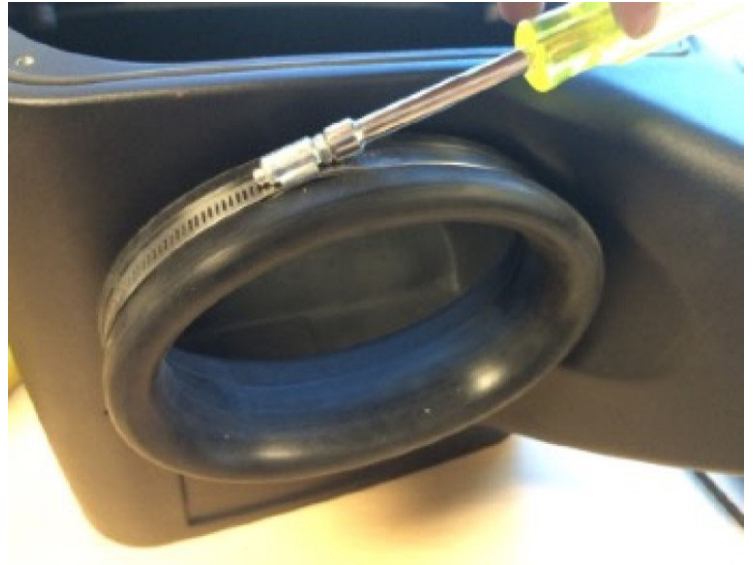

STEP 15

Install the Front Inlet (G). Use the supplied Plastic Rivet (H) to secure the front inlet to the Airbox (A). Use

two plastic rivets on each hole and pinch them together to lock them in place.



STEP 16

Install the two Quick Connect Fittings (Q & R) on to Intake Tube (B) until hand tight then use a crescent wrench and tighten it another one to two complete turns.

IMPORTANT: Do not over tighten, as the Quick Connect Fittings can break or the threaded inserts may strip!



STEP 17

Install the Airbox (A). Make sure that the box prongs are aligned with the factory grommets. Push down on the airbox to make sure that the prongs are completely seated.



STEP 17 (IMAGE 2)

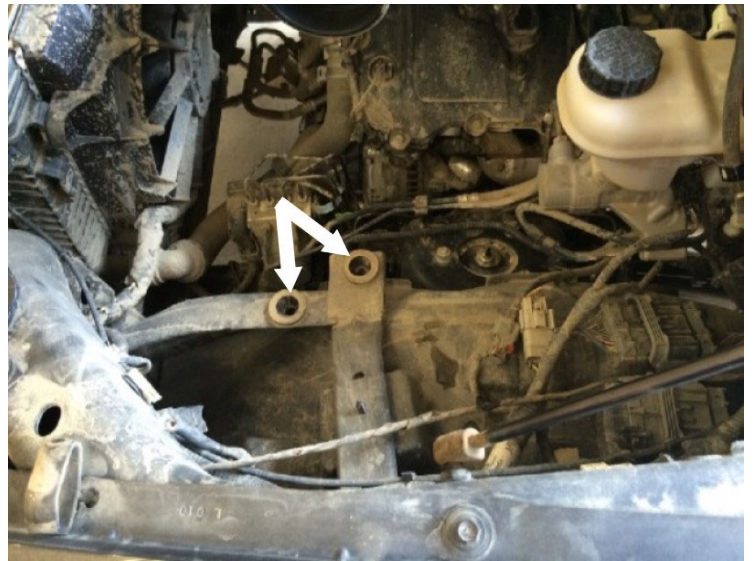

STEP 18

Reinstall the retaining bolt removed in Step 7 and tighten the bolt to secure the Airbox (A). Install the retaining bolt from inside the airbox.



STEP 19

Install the Silicone Step Coupler (N) and two Hose Clamp #60 & #56 (O & P) onto the throttle body.



STEP 20

Place the Air Filter (D) and Hose Clamp #88 (J) inside the Airbox (A). Turn the filter sideways and slide it into the airbox.



STEP 21

Feed the Air Intake Tube (B) underneath the coolant line through the Rubber Cuff (C) until the bead on the air intake tube meets up to the rubber cuff. Slide the Air Filter (D) over the tube until the tube bottoms out on the filter flange step.



STEP 21 (IMAGE 2)



STEP 21 (IMAGE 3)

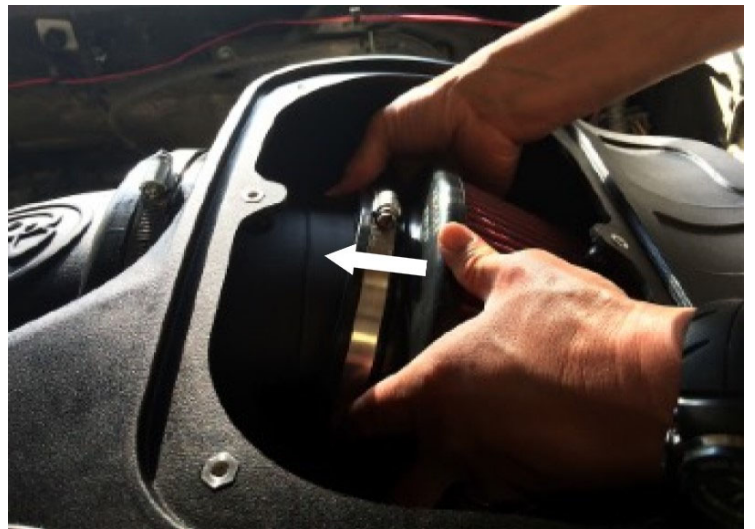

STEP 22

Tighten the Hose Clamp #88 (J) at the Air Filter (D).



STEP 23

Insert the Air Intake Tube (B) into the Silicone Step Coupler (N) at the throttle body. Once everything is in place, tighten Hose Clamp #56 & #52 (O & P).

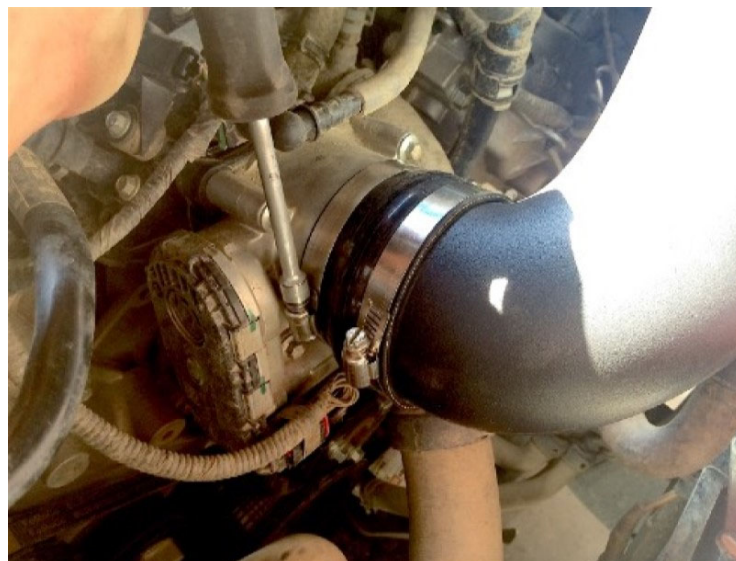

STEP 24

Reconnect the vacuum line. Push in the connector over the Quick Connect Fitting (R) until you hear it snap into place.

IMPORTANT: Do not over tighten, as the Quick Connect Fittings can break or the threaded inserts may strip!



STEP 24 (IMAGE 2)

Reconnect the PCV hose.
Push in the connector over
the Quick Connect Fitting
(Q) until you hear it snap
into place.



STEP 25

Insert the two-wire clips
disconnected in Step 7
(Image 2) into the holes on
the side of the Airbox (A).
Use zip ties to secure any
loose wires or harnesses
away from any hot surfaces
and/or moving components
that may cause damage.



STEP 26

Secure the Front Inlet (G).
Firmly push down on the
center pin of the Plastic

Rivet (I) until it locks into the closed position.



 **STOP! READ THIS BEFORE CONTINUING THE INSTALL**

If your kit came with our new snap-in lid design, please proceed to **STEP 30** to install your snap-in lid. If your lid is the traditional screw in lid, please proceed to the next step.

STEP 27

Remove the protective covering from the Clear Lid

(E).



STEP 28

Install the Lid Seal (F)
around the Clear Lid (E).



STEP 29

Install the Clear Lid (E) on top of the Airbox (A) and secure the lid using the six provided Truss Head Phillips Screw (M) and Sealing Washer (L). Do not over tighten.



STEP 30

For Snap-In Lids Only

Remove the protective covering from the Clear Lid.



STEP 31

For Snap-In Lids Only

The notch on the lid and the tab of the lid seal should mate in the same corner.



STEP 32

For Snap-In Lids Only

Stretch silicone lid seal around the perimeter of the clear lid. It should be a snug fit.



STEP 33

Reconnect the negative terminal on the battery. Inspect your installation, make sure the kit is properly positioned and all fasteners are secure. Affix the ID/ CARB label near the kit under the hood. The

installation is now complete.

