

INSTALL INSTRUCTIONS FOR 75-5067

BEFORE YOU START

- 8mm, 10mm, 13mm Wrench & Socket
- Pin Removal Tool or Flat Blade Screwdriver
- 7/16" Wrench and Socket
- 5/16" Nut Driver or Flat Blade Screwdriver
- Phillips Screwdriver
- 1 Set of Torx Wrenches & Allen Wrenches
- 1 Pair of Pliers or similar tool
- Note: This intake kit may not fit with the following
Aftermarket Parts installed: Body Lift or Lowering Kit,
Custom Hood

REQUIRED TOOLS

- 8mm, 10mm, 13mm Wrench & Socket
- Pin Removal Tool or Flat Blade Screwdriver
- 7/16" Wrench and Socket
- 5/16" Nut Driver or Flat Blade Screwdriver
- Phillips Screwdriver
- 1 Set of Torx Wrenches & Allen Wrenches
- 1 Pair of Pliers or similar tool

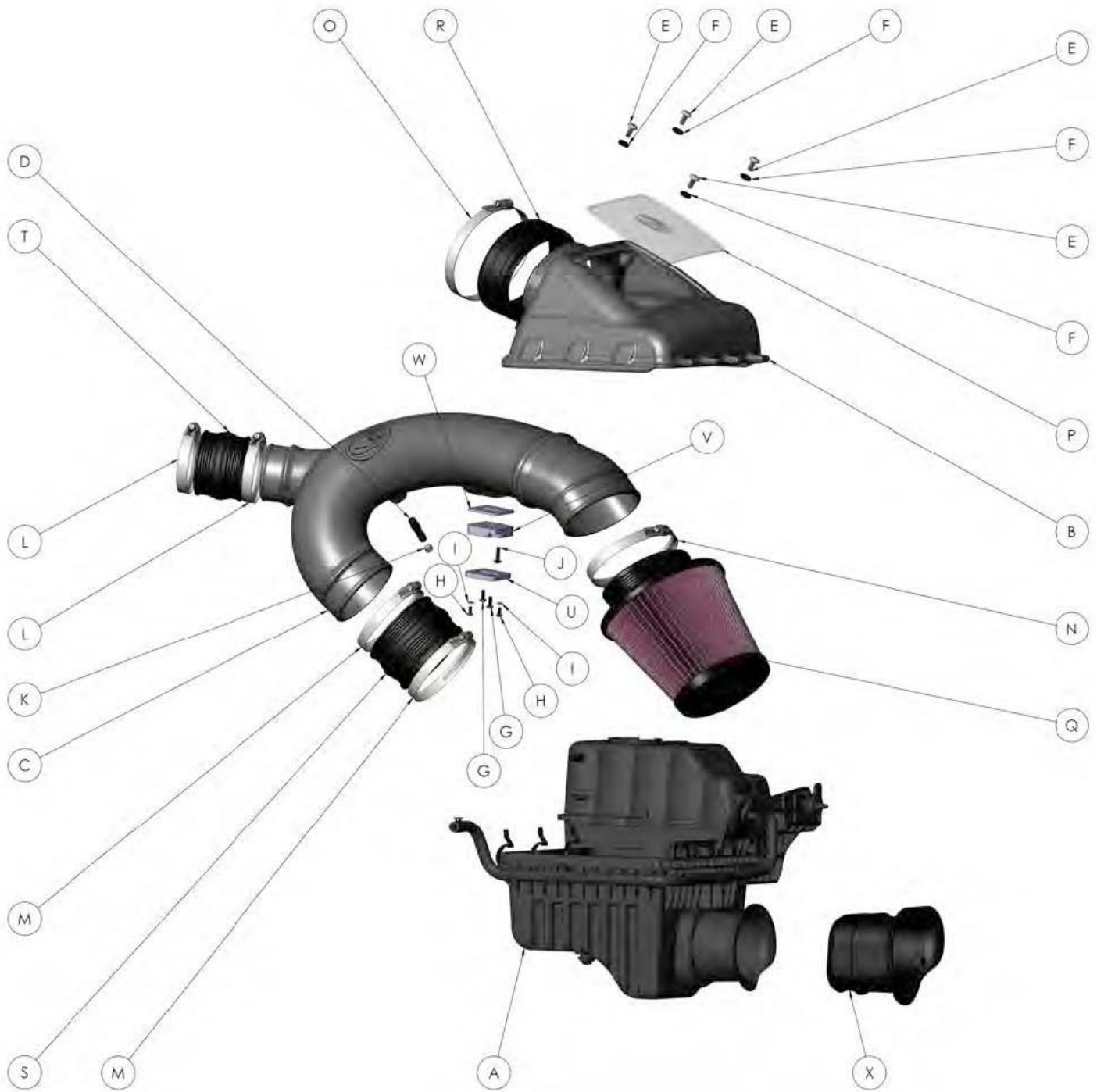

ITEM	QTY.	DESCRIPTION	P/N
A	1	Factory Intake Box	-----
B	1	Air Box Cover	AL1217-00
C	1	Intake Tube	AL1216-00
D	1	Hose Barb 3/8" x 1/8" NPT	AI1643-00
E	4	Truss Head 1/4-20 x 5/8"	AI1569-00
F	4	Sealing Washer	AI1571-00
G	2	S.S. Pan Head 10-32 x 1/2"	AI1640-00
H	2	S.S. Pan Head 8-32 x 3/8"	AI1639-00
I	2	Rubber Washer	AI1200-00
J	1	S.S. Truss Head 10-32 x 3/4"	AI1641-00
K	1	Hex Socket Plug 1/8" NPT	AI1398-00
L	2	Hose Clamp #52	AG1007-00
M	2	Hose Clamp #72	AG1009-00

ITEM	QTY.	DESCRIPTION	P/N
O	1	Hose Clamp #104	AG1012-00
P	1	Lid	AI1607-00
Q	1	S&B Filter	KF-1058
R	1	Rubber Cuff	AI1604C-00
S	1	Straight Coupler	AI1333C-00
T	1	Hump Coupler	AI1601C-00
U	1	Adapter Plate (Early Models)	AI1209-00
V	1	Adapter Plate (Late Models)	AI1605-00
W	1	Adapter Plate Gasket	AI1637-00
X	1	Fender Inlet	AI1635C-00

STEP 1

With the ignition switched off and the parking brake set, disconnect the negative battery cable on the passenger side.

IMPORTANT: Failure to disconnect the battery for a minimum of 2 hours may cause the Check Engine Light to illuminate upon completion of the installation or subsequent operation. **DO NOT SKIP THIS STEP!**



STEP 2

This vehicle is equipped with one of two different sensors depending on which year your vehicle is.

Older Models 2011



STEP 2 (IMAGE 2)

Newer Models 2012-14



STEP 3

The sensor must be removed from the factory intake tube.

-The sensor for the older vehicles requires a Torx wrench to remove the sensor from the tube.



STEP 3 (IMAGE 2)

-On newer vehicles use a pair of pliers or female Torx to unscrew the bolt and remove the sensor from the tube.



STEP 3 (IMAGE 3)

-Be careful about the removal of the sensor to not damage the wiring connections on the harness.



STEP 4

Once the sensor is removed from the tube it must be removed from the harness also.

(Older Vehicle Sensor) pull the **Red** tab out and press down on the release button while pulling out.



STEP 4 (IMAGE 2)

(Newer Vehicle Sensor) press down on the release button and pull out to remove the sensor from the connector and harness.



STEP 5

With the sensor removed
loosen all three hose clamps
that are on the factory
intake tube.



STEP 6

Remove the top tube by pulling out and away from the factory airbox.



STEP 7

Pull the rest of the factory intake tube out by moving it to the side and lifting up.

Note: on some vehicles, there is a hose from the crankcase that also must be removed.



STEP 8

Remove the factory airbox cover by disconnecting the three metal latches that are on the side of the factory airbox.



STEP 9

Once all three latches are disconnected lift the cover up and out to the side to remove.



STEP 10

Remove the factory air filter.



STEP 11

Remove the factory airbox by removing both bolts and lifting up on the box. The other connections to the box do not need to be removed to gain access to the side inlet.



STEP 12

Once access is available to the side inlet remove by pushing down on the tabs. A screwdriver may be required to loosen the 2 tabs on top and 1 tab underneath.



STEP 13

Install the S&B fender Inlet (X) by pushing in firmly, wait until it snaps into place.

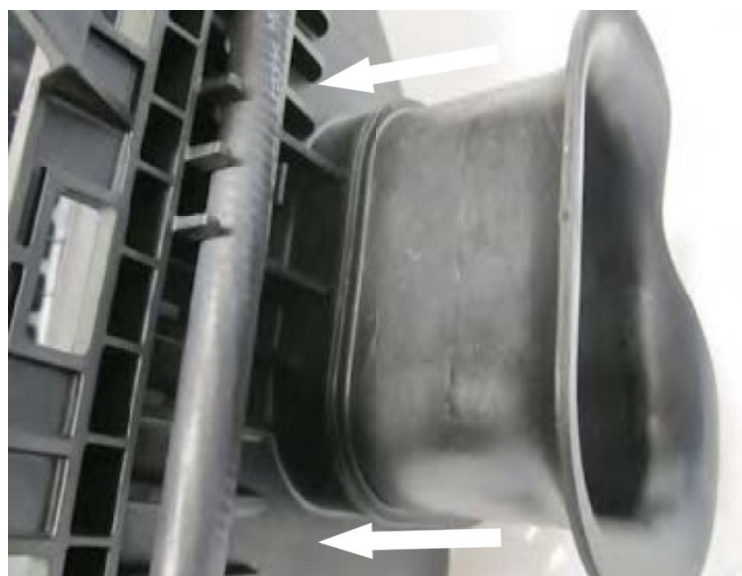

STEP 14

After the S&B inlet is installed, lower the factory airbox back down and reinstall the factory bolts. Make sure the S&B inlet (X) is pushed through the side skirt.



STEP 15

Attach coupler (T) to intake tube (C) using hose clamps (L). Only tighten the hose clamp on the S&B intake tube side while leaving the other hose clamp loose.



STEP 16

Attach coupler (S) to intake tube (C) using hose clamps (M). Again only tighten the hose clamp on the tube side while leaving the other hose

clamp loose.



STEP 17

Attach the hose clamp (O) to the intake rubber cuff (R).



STEP 18

Install the cuff (R) onto the S&B airbox cover (B) making sure that the tab on the cuff aligns with the notch on the S&B Airbox Cover.



STEP 19

Insert the intake tube assembly into the cuff. Please make sure that the tube is pushed all the way to the stop hump of the tube. This will not be an air tight fit to allow for engine movement.



STEP 20

Once the tube is pushed flush against the stop hump

of the tube the hose clamp (O) on the cuff can be tightened down.



STEP 21

Flip over the assembly and install the S&B air filter (Q) and tighten the hose clamp (N). Position the clamp so that it can be accessed through the lid in the future.



STEP 22

Once the filter is installed, use the correct adapter plate for the correct model year.

-Early Models (U) 2011

-Newer Models (V) 2012-14



STEP 23

Install the adapter plate (U) or (V) and gasket (W) using the two 10-32 screws (G). Please make sure that the arrows are aligned to ensure proper installation.

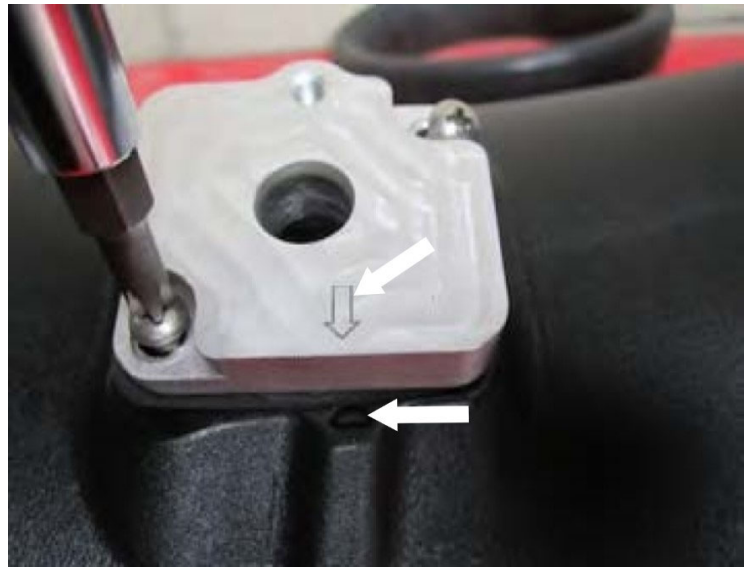

STEP 24

Once the adapter plate is connected install the factory sensor to the plate using the provided hardware (J) or (H

& I).



STEP 25

Note: Check to see if your vehicle has a hose connected to the crankcase from the intake tube. If so connect the Hose Barb (D) to the crankcase inlet on the S&B intake tube. If not install the Hex Plug Socket (K) into the crankcase inlet using the correct Allen wrench (use Teflon tape around whichever fitting is used).



STEP 25 (IMAGE 2)



STEP 26

The S&B intake is now ready for installation.



STEP 27

Place the whole intake assembly and lower it down into the stock intake box. Please make sure that the tabs on the S&B airbox cover fit correctly into slots on the factory box on the right-hand side. Once the tabs are in the slots lower the whole intake assembly into place.



STEP 27 (IMAGE 2)



STEP 28

Lower the complete assembly and make sure the S&B Airbox Cover (B) sits

inside the factory airbox slots. Proper installation into the slots will reduce movement.



STEP 29

Attach the bottom tube to the bottom turbo inlet and push in completely. After the tube is pushed in all the way tighten the hose clamp.



STEP 30

Attach the top turbo inlet tube completely and again tighten the hose clamp.



STEP 31

After all the hose clamps are tightened remember to reconnect the three latches on the side of the intake box.

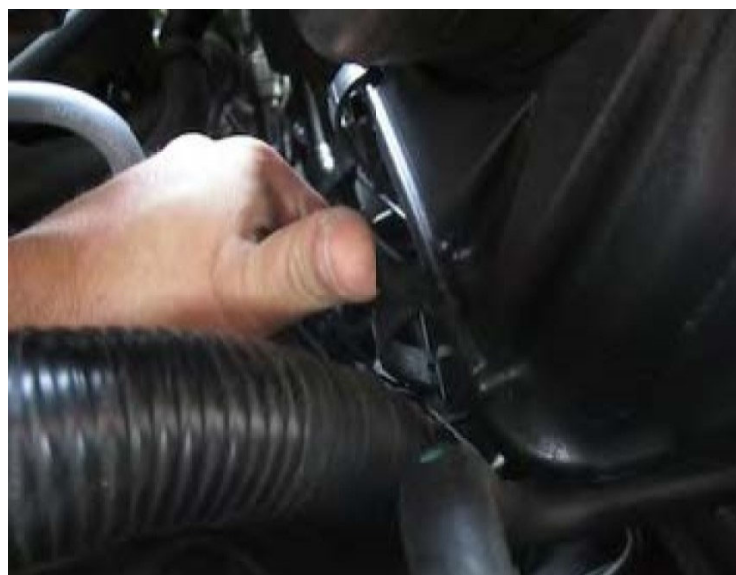

STEP 32

Plug the harness into the sensor under the intake tube. Press in firmly till it locks.

Note: older vehicles must

also press in the **Red** lock tab after the harness is connected



STEP 33

Note: if your vehicle has a hose that connects from the intake tube to the crankcase remember to connect the hose firmly to the S&B hose fitting (D).



STEP 34

Fasten the airbox lid (P) using the provided hardware (E & F).



STEP 35

Reconnect the battery. Inspect your installation, make sure the kit is properly positioned and all fasteners are secure.



STEP 36

Affix the CARB and ID label near the intake kit. Keep all stock parts in case you would ever need to reinstall the stock intake. The installation is now complete.

