

INSTALL INSTRUCTIONS FOR 75-5060

BEFORE YOU START

Vehicle Applications:

2012-2018 Jeep Wrangler JK 3.6L, Gas

Note: This intake kit may not fit with the following Aftermarket Parts installed: Body Lift or Lowering Kit, Custom Hood, Throttle Body Spacer / Upgrade, Aftermarket turbocharger

REQUIRED TOOLS

- 10mm Wrench & Socket
- 5/16" Nut Driver & 1/4" Nut Driver or Flat Blade Screwdriver
- Phillips Screwdriver, Pliers or Channel locks

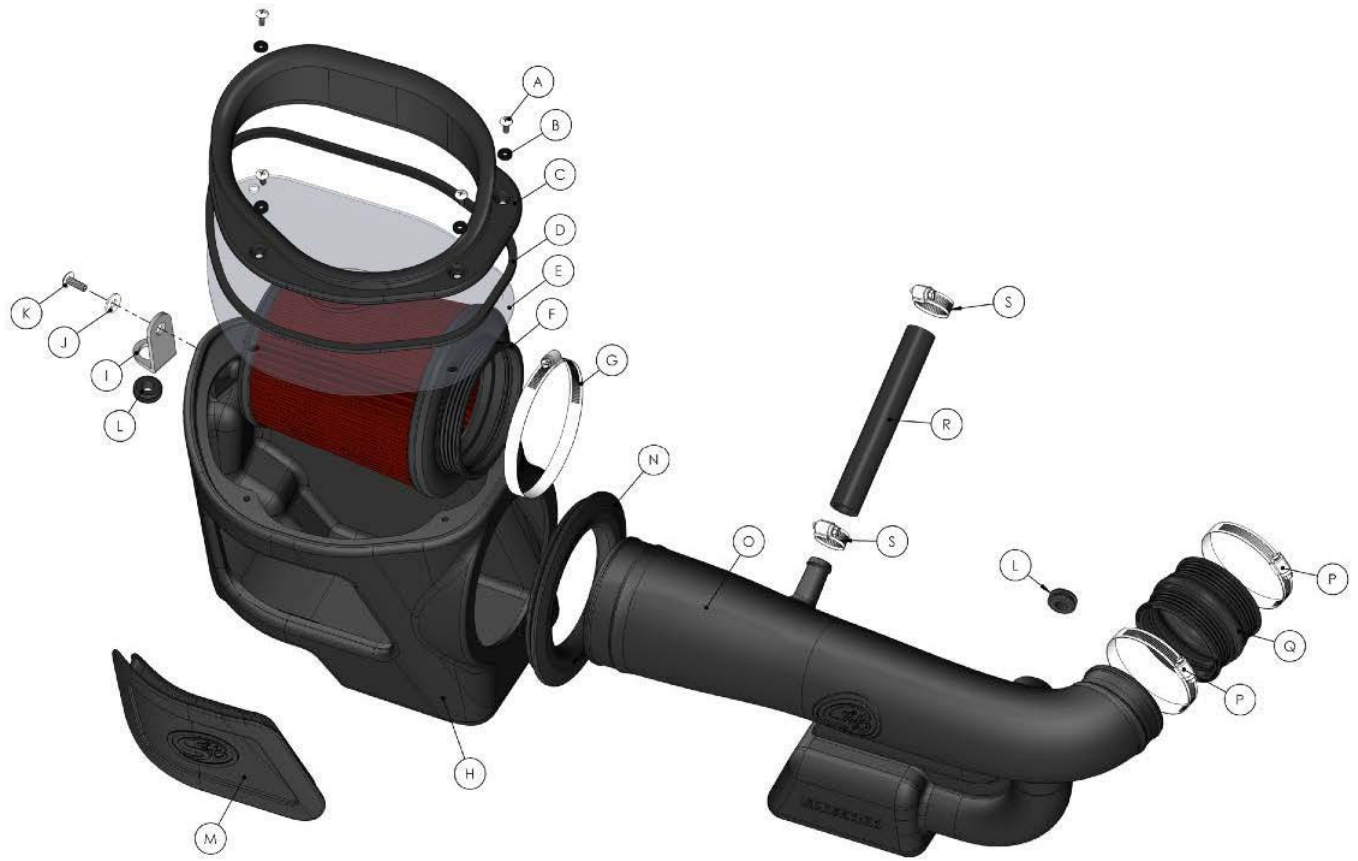

ITEM	QTY.	DESCRIPTION	P/N	ITEM	QTY.	DESCRIPTION	P/N
A	4	#10-24 X 5/8" Truss Head Screw	AI1539-00	O	1	Air Tube	AL1231-01
B	4	#10-24 Rubber Washers	AI1540-00	P	2	Hose Clamp, #52	AG1007-00
C	1	Silicone Hood Seal	AI1681C-00	Q	1	Hump Coupler	AI1601C-00
D	1	Lid Edge Trim	AI1636-06	R	1	Crank Case Hose	AI1040-08
E	1	Lid	AI1680-00	S	2	Hose Clamp, #12	AG1030-00
F	1	Air Filter	KF-1057	U	1	Loctite Thread Locker	AI1595-00
G	1	Hose Clamp, #80	AG-1009-00	ITEMS NOT SHOWN IN THE EXPLODED VIEW			
H	1	Air Box	AL1231B-00	T	2	Loop Clamp	AI1511-00
I	1	Bracket	AI1696-00				
J	1	1/4"-20 Washer	AI1073-00				
K	1	1/4"-20 x .625" Truss Head Screw	AI1569-00				
L	2	Grommets	AI1563-00				
M	1	Silicone Box Seal	AI1682C-00				
N	1	Tube Seal	AI1650C-00				

STEP 1

With the ignition switched off and the parking brake set, disconnect the negative battery cable on the battery.

IMPORTANT: Failure to disconnect the battery for a minimum of 2 hours may cause the Check Engine Light to illuminate upon completion of the installation or subsequent operation. **DO NOT SKIP THIS STEP!**



STEP 2

Lift and remove the plastic engine cover.



STEP 3

Loosen the hose clamp at

the throttle body and pull the tube out.



STEP 4

Remove the two retaining bolts on the stock intake tube.

Note: You will need to reuse the retaining bolts to secure the radiator hose on Step 24.



STEP 5

Loosen the hose clamp at the stock airbox and pull the tube out.



STEP 6

Once everything is loosened, pull the intake tube out exposing the IAT sensor.



620IAT%20sensor%20and%20use%20pliers%20if%20necessary%20to%20turn%20it%20counterclockwise%20to%20remove%20the%20sensor%20from%20its%20harness.%20Pull%20the%20intake%20tube%20out%20and%20remove%20the%20IAT%20sensor.

STEP 7 (IMAGE 2)



STEP 7 (IMAGE 3)



STEP 8

Pull the stock CCV hose from the air box and the breather line. For the breather line, use a flat blade screwdriver if necessary to pry the hose off the line. Be careful not to damage the breather line. Remove the hose completely.

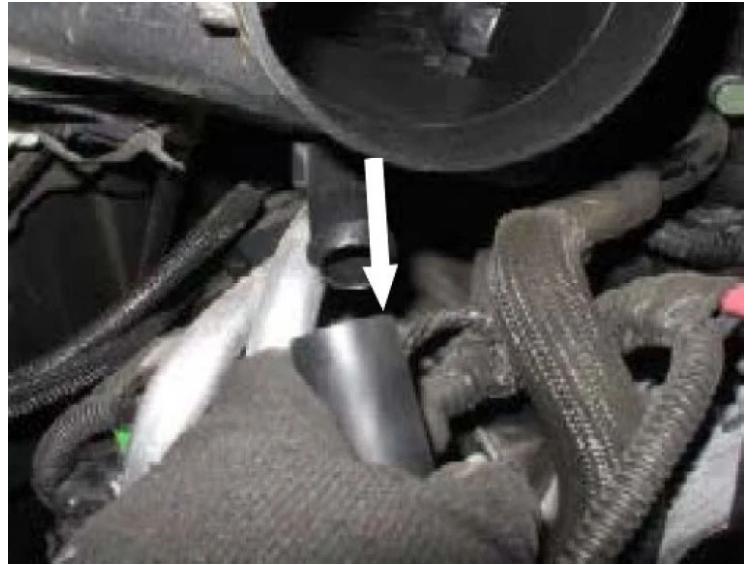

STEP 8 (IMAGE 2)



STEP 9

Once the sensor and breather are out, remove the stock airbox completely by pulling up. Be careful not to

break the factory box tabs.

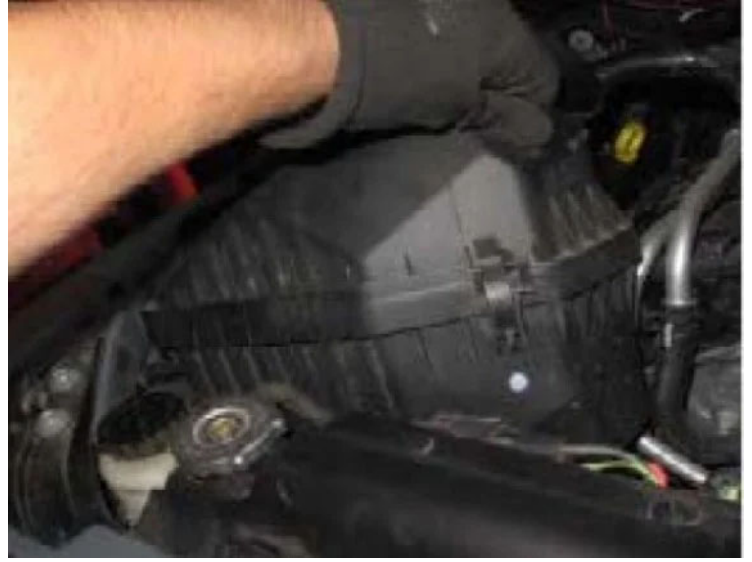

STEP 10

Install the Tube Seal (N) by pushing the seal into the Airbox (H).



STEP 11

Install the Air Tube (O) into the Airbox (H) by pushing the tube through the Tube Seal (N).



STEP 12

Slip the Air Filter (F) over the Air Tube (O) and tighten down the #80 Hose Clamp (G).



STEP 13

Install the Hump Coupler (Q) to the Air Tube (O) and tighten down the #52 Hose Clamp (P) on the tube end. Leave the other clamp on the coupler that goes into the throttle body lose.



STEP 14

Install the Bracket (I) to the side of the Airbox (H) with the supplied Screw (K) and Washer (J). Apply Loctite Thread Locker (U) to the threads on the Screw (K) before installing the bracket. Insert the Grommet (L) in between the hole on the bottom end of the bracket.



STEP 14 (IMAGE 2)



STEP 15

Install the Grommet (L) to the bottom of the Air Tube (O).



STEP 16

Reinstall the IAT sensor into the Air Tube (O) by pushing the sensor into the Grommet (L). Seat the sensor into the grommet until the O-ring is not visible.



STEP 17

Locate the bolt on the side of the plastic tray that holds the stock intake box and remove it.



STEP 18

Choose the setup you prefer.

- Configuration 1: Silicone Hood Seal (C) and Silicone Box Seal (M) Installed.

- Configuration 2: Silicone Hood Seal (C) Installed and Silicone Box Seal (M) Not Installed.

- Configuration 3: Lid (E) Installed and Silicone Box Seal (M) Not Installed.

- **Note:** **Configuration 3** is the default setup for this installation instructions.

Warning: Do not install the Polycarbonate Lid with the Silicone Airbox plug. Doing this will cause your filter to collapse and will void your warranty.

STEP 19

Drop in the Air Tube (O) and reinstall the harness back into the IAT sensor.



STEP 20

Install the Airbox (H) until the tabs snap into the factory grommets. Align the bracket with the hole on the plastic tray. Reuse the bolt from the plastic tray to tighten down the airbox.

Note: If Configuration 1 is chosen, insert the Box Seal (M) before installing the Airbox (H)



STEP 21

Install the Hump Coupler (Q) into the throttle body and

tighten down the #52 Hose
Clamp (P).



STEP 22

Install the Crankcase Hose
(R) onto the Air Tube (O)
and tighten the #12 Hose
Clamp (S).



STEP 23

Slip the other end of the Crankcase Hose (R) onto the crankcase vent tube. Tighten down the #12 Hose Clamp (S) to secure the hose.

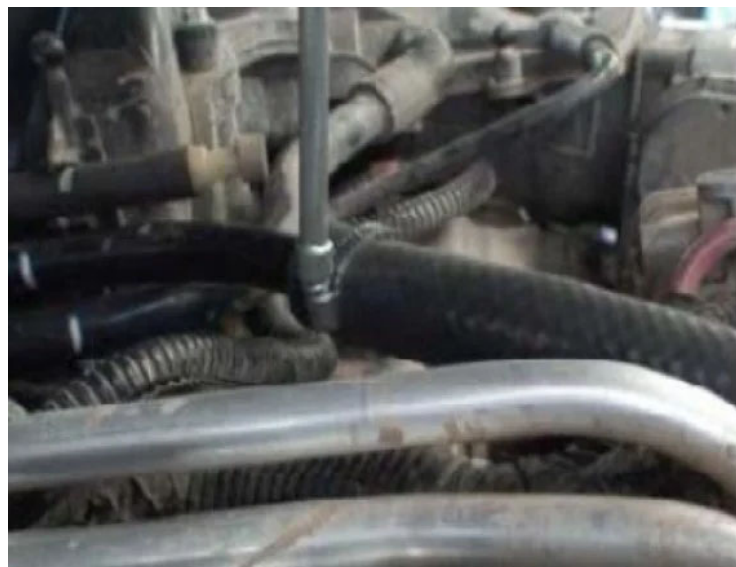

STEP 24

Use the two provided Loop Clamp (T) and reuse the retaining bolt to secure the radiator hose.



STEP 25

(Optional Step) Remove the protective covering from the Lid (E) and install the Lid Edge Trim (D). Place the lid on top of the Airbox (H) and secure the lid using the four

provided Screw (A) and Washer (B).

Note: Install your Silicone Hood Seal (C) using the provided screws and washers if Configuration 1 or 2 was chosen.



STEP 25 (IMAGE 2)



STEP 26

Reinstall the plastic engine cover.



STEP 27

Reconnect the battery. Inspect your installation, make sure the kit is properly positioned and all fasteners are secure. The installation is now complete.



KIT SPECIFIC FEATURES

*The 75-5060 kit has three airflow configurations that you can choose from depending on your airflow requirements.

The airflow restriction for all three configurations are very similar. Choosing one over another would have minimal effect on performance.

Warning: Do not install the Polycarbonate Lid with the Silicone Airbox plug. Doing this will cause your filter to collapse and will void your warranty.

CONFIGURATION 1

- **Configuration 1:** Silicone Hood Seal and Silicone Airbox Plug installed.



CONFIGURATION 2

- **Configuration 2:** Silicone Hood Seal installed and Silicone Airbox Plug not installed.



CONFIGURATION 3

- **Configuration 3:** Polycarbonate Lid installed and Silicone Airbox plug not installed.



CARB EO LABEL

Please affix the included CARB-approved EO label in an area under the hood. We recommend placing it on the radiator shroud, or the underside of the vehicle's hood near the S&B product.