

INSTALL INSTRUCTIONS FOR 75-5050

BEFORE YOU START

- Please read the entire product guide before proceeding.
- Ensure all parts are present.
- If you are missing any of the components, call our customer support at (909) 947-0015.
- Do not work on your vehicle while the engine is hot.
- Make sure the engine is turned off and the vehicle is in Park or the Parking Brake is set.
- Note: This intake kit may not fit with the following Aftermarket Parts installed: Body Lift or Lowering Kit, Custom Hood, Throttle Body Spacer / Upgrade

REQUIRED TOOLS

- 10mm, 13mm, 5/16" Wrench or Socket
- Phillips head Screwdriver
- 5/16" Nut Driver or Flat Blade Screwdriver
- Teflon tape
- Ford approved engine coolant (To top off new coolant reservoir if needed)

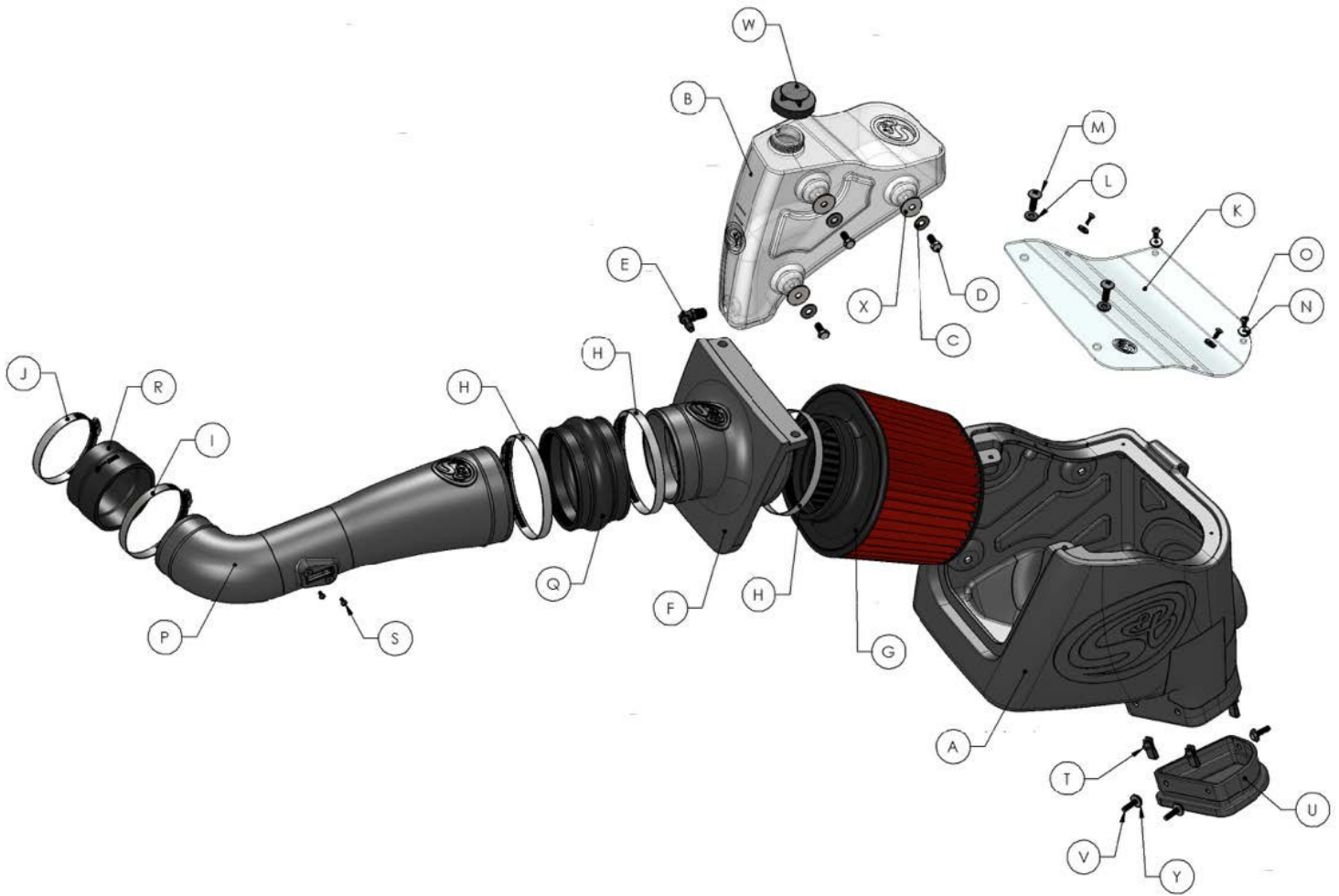

ITEM	QTY.	DESCRIPTION	P/N
A	1	Air Box	AL1142-00
B	1	Coolant Recovery Tank	AL1143-00
C	3	Washer, Flat, 5/16"	AI1093-00
D	3	Hex Head Bolt, 5/16-18 x 3/4"	AI1467-00
E	1	Hose Barb, 90deg. 1/4"NPT	AI1307-00
F	1	Adapter Tube	AL1141-00
G	1	S&B Filter	KF-1035
H	3	Hose Clamp, #80	AG1010-00
I	1	Hose Clamp, #60	AG1008-00
J	1	Hose Clamp, #56	AG1019-00
K	1	Clear Lid	AI1482-00
L	2	Rubber Sealing Washer, 5/16"	AI1434-00
M	2	Truss Screw, 5/16-18 x 1"	AI1297-00
N	4	SS Sealing Washer, #10	AI1272-00

ITEM	QTY.	DESCRIPTION	P/N
O	4	Pan Head Screw, 10-24 x 1/2"	AI1287-00
P	1	Intake Tube	AL1140-00
Q	1	Hump Hose, 5.0"ID	AI1338-00
R	1	Silicone Step Adapter	AI1489S-00
S	2	Pan Screw, M4x0.7x8mm	AI1360-00
T	3	Clip Nut, #1/4-20	AI1059-00
U	1	Box Plug	AL1147-00
V	3	Hex Head Screw, 1/4-20 x 1.0"	AI1131-00
W	1	Cap, Coolant Reservoir	AI1526-00
X	3	Fender Washer, 1.25"OD	AI1080-00
Y	3	Washer, Flat, M6	AI1535-00
Z	1	MAF Wiring Harness Extension (not pictured)	AI1481-00

**THREAD LOCKER
USE**

We have provided a small tube of thread locker in your kit. Whenever you see the symbol above on a step of the instructions apply 1 small drop of the thread locker to the threads of the screws or bolts. This will keep your hardware from vibrating loose during rough driving. If the hardware ever needs to be removed, do so slowly to avoid having the inserts strip out from the plastic.



STEP 1

Be sure the engine is cool before starting!

With the ignition switched off and the parking brake set, disconnect the negative battery cable.

IMPORTANT: Failure to disconnect the battery for a minimum of 2 hours may cause the Check Engine Light to illuminate upon completion of the installation or subsequent operation.

DO NOT SKIP THIS STEP!



STEP 2

Loosen the hose clamp at the throttle body.

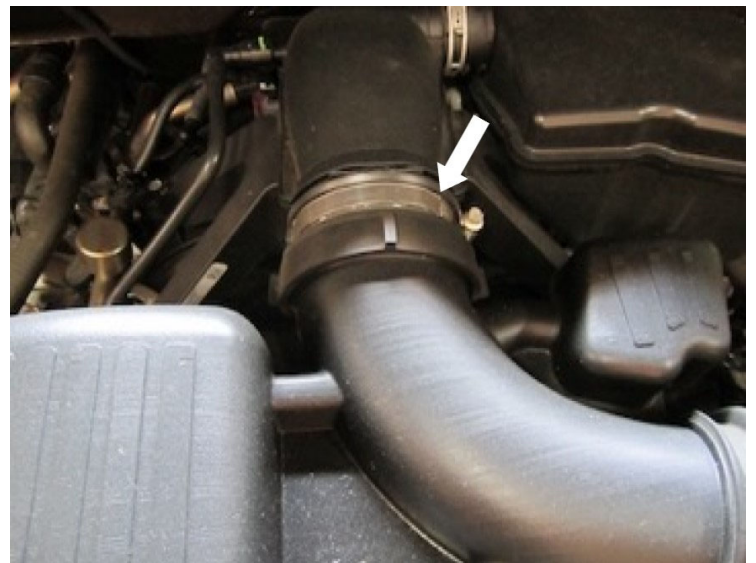

STEP 3

Disconnect the MAF sensor by sliding the red locking pin back, press in the bottom of the harness and pull out the male connection.

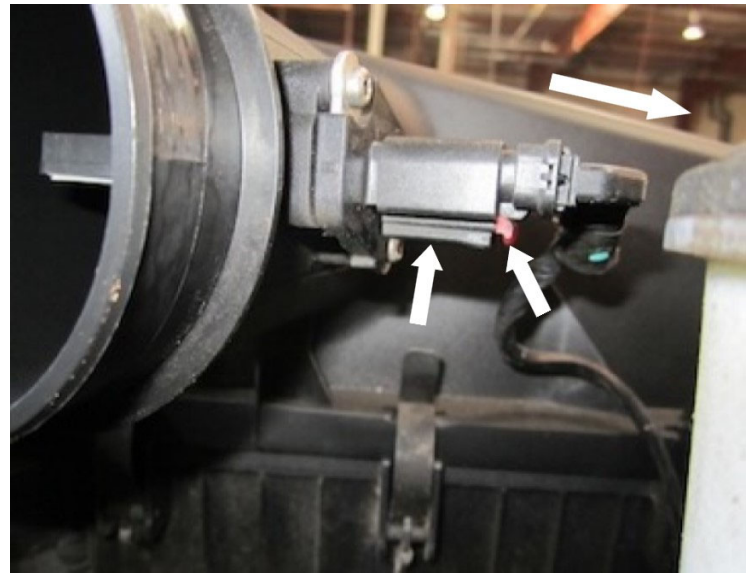

STEP 4

Loosen the hose clamp at the airbox/ intake tube connection. Then remove the intake tube assembly from the truck.



STEP 5

Undo the three clips holding the airbox cover to the airbox. Remove the airbox lid and air filter from the truck.

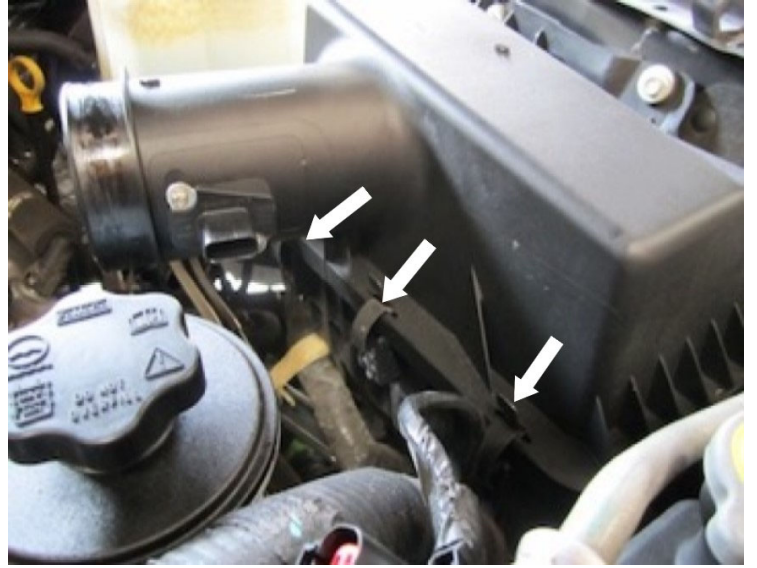

STEP 6

Using a 13mm socket, remove the rear airbox mounting bolt. Then carefully remove the coolant overflow tube from the reservoir and use the mounting bolt as a temporary plug for the tube.



STEP 7

Remove the other airbox mounting bolt using a 13mm socket. Carefully tip the airbox assembly away from

the fender so that coolant isn't spilt.



STEP 8

Pull the assembly out of the factory grommets and remove from the truck.

Note: You will have to remove the bolt from the rubber tube to fit through the airbox assembly.



STEP 9

Remove the mounting insert and rubber grommet from the OE airbox assembly.



STEP 10

Insert the OE rubber grommet and insert it to the Airbox (A) as shown.



STEP 11

For those concerned about minimal engine heat; insert the three Clip Nuts (T) over the holes on the bottom opening of the Airbox (A), insert the Box Plug (U) into the end of the Airbox (A). Attach using the supplied 1/4-20 Hex Screws (V) and

Flat Washers (Y) from the inside of the Airbox using 5/16" socket or ratcheting wrench. For those seeking additional airflow, set the Airbox End Cap aside.



STEP 11 (IMAGE 2)



STEP 12

Apply Teflon tape to the threads of the 90deg. Hose Barb (E). Insert the Hose Barb into the Coolant Recovery Tank (B) as shown. Be sure the connection is tight.



STEP 13

Place the three Large Fender Washers (X) into the indents on the side of the Airbox (A).



STEP 14

Place the Coolant Recovery Tank (B) on the side of the Airbox (A). Attach it using the supplied 5/16" Hex Bolts (D) and 5/16" Flat Washers (C).



STEP 15

Install the Airbox/ Coolant Tank assembly into the truck. Push the prongs on the bottom of the airbox into the OE grommets set in the frame. Secure using the OE bolt removed in Step #7.



STEP 16

Remove the OE bolt that was inserted into the rubber coolant tube in Step #6 and push the tube end over the

end of the 90deg. Hose Barb
(E).



STEP 17

Remove the coolant from the OE reservoir and pour it into the Coolant Recovery Tank (B).

Note: It may be necessary to add coolant to meet fill range of the new tank. Be sure to use Ford approved coolant.



STEP 18

Attach the Reservoir Cap (W) to the Recovery Tank (B).



STEP 19

Insert the Adapter Tube (F) to the S&B Air Filter (G) as shown. Tighten the #80 Hose Clamp (H).



STEP 20

Slide the filter assembly into the Airbox. Install two #80 Hose Clamps (H) over the Hump Adapter (Q). Push the Hump hose over the end of the Adapter Tube (F).



STEP 21

Install the small end of the Silicone Adapter (R) over the throttle body outlet. Secure using a #56 Hose Clamp (J). Loosely slide the #60 Hose Clamp (I) around the opposite end.



STEP 22

Remove the MAF sensor from the OE airbox lid using

the supplied Torx tool. With the small rubber OE ring gasket in place, install the MAF sensor into the Intake Tube (P) using the M4 Screws (S).

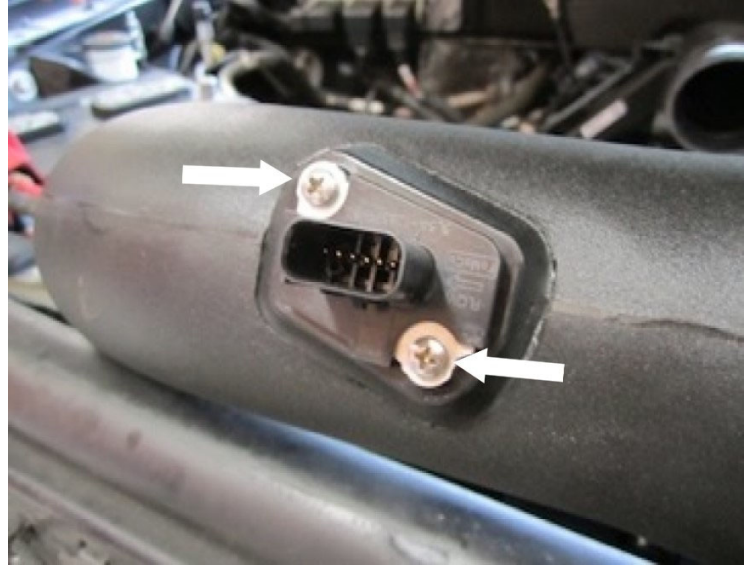

STEP 23

Install the Intake Tube (P) into the Silicone Adapter (R) and then slide the Hump Adapter (Q) over the opposite end. Secure all the hose clamps at this time.



STEP 24

Install the supplied MAF sensor extension harness (Z) between the MAF sensor and the OE MAF connector.

Use the supplied wire tie to position the harness away from any potential hazards.

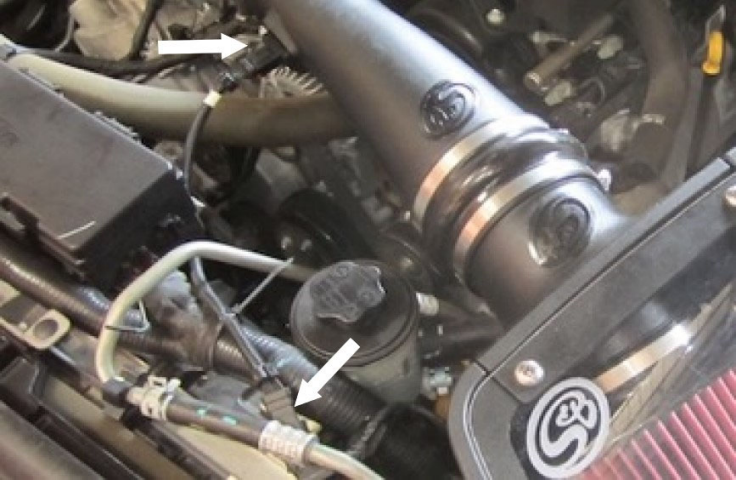

STEP 25

Remove the protective covering from the Clear Lid (K), then install the lid. Secure using the four 10/24" Screws (O), Sealing Washers (N), and two 5/16" Screws (M) and Rubber washers (L). **Do not over tighten.**

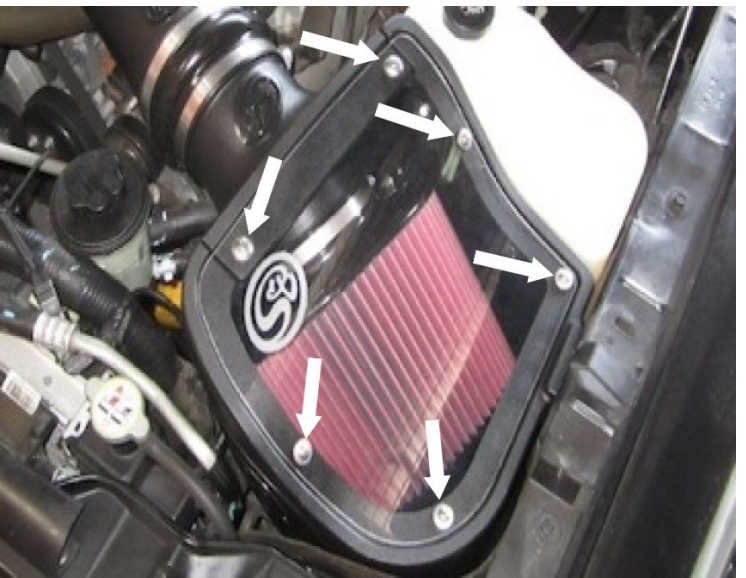

STEP 26

Reconnect the battery. Inspect your installation, make sure the kit is properly positioned and all fasteners

are secure. The installation is now complete.

