



INSTALL INSTRUCTIONS FOR 75-5016



BEFORE YOU START

Please read the entire product guide before proceeding.

Ensure all parts are present.

If you are missing any of the components, call our customer support at (909) 947-0015.

Do not work on your vehicle while the engine is hot.

Make sure the engine is turned off and the vehicle is in Park or the Parking Brake is set.

Note: This intake kit may not fit with the following Aftermarket Parts installed: Body Lift or Lowering Kit, Custom Hood, Throttle Body Spacer / Upgrade

REQUIRED TOOLS

8, 10, 13mm Wrench or Socket

1/2" Wrench or Socket

T-20 Security Torx Wrench (Supplied w/ Kit)

5/16" Nut Driver or Flat Blade Screwdriver

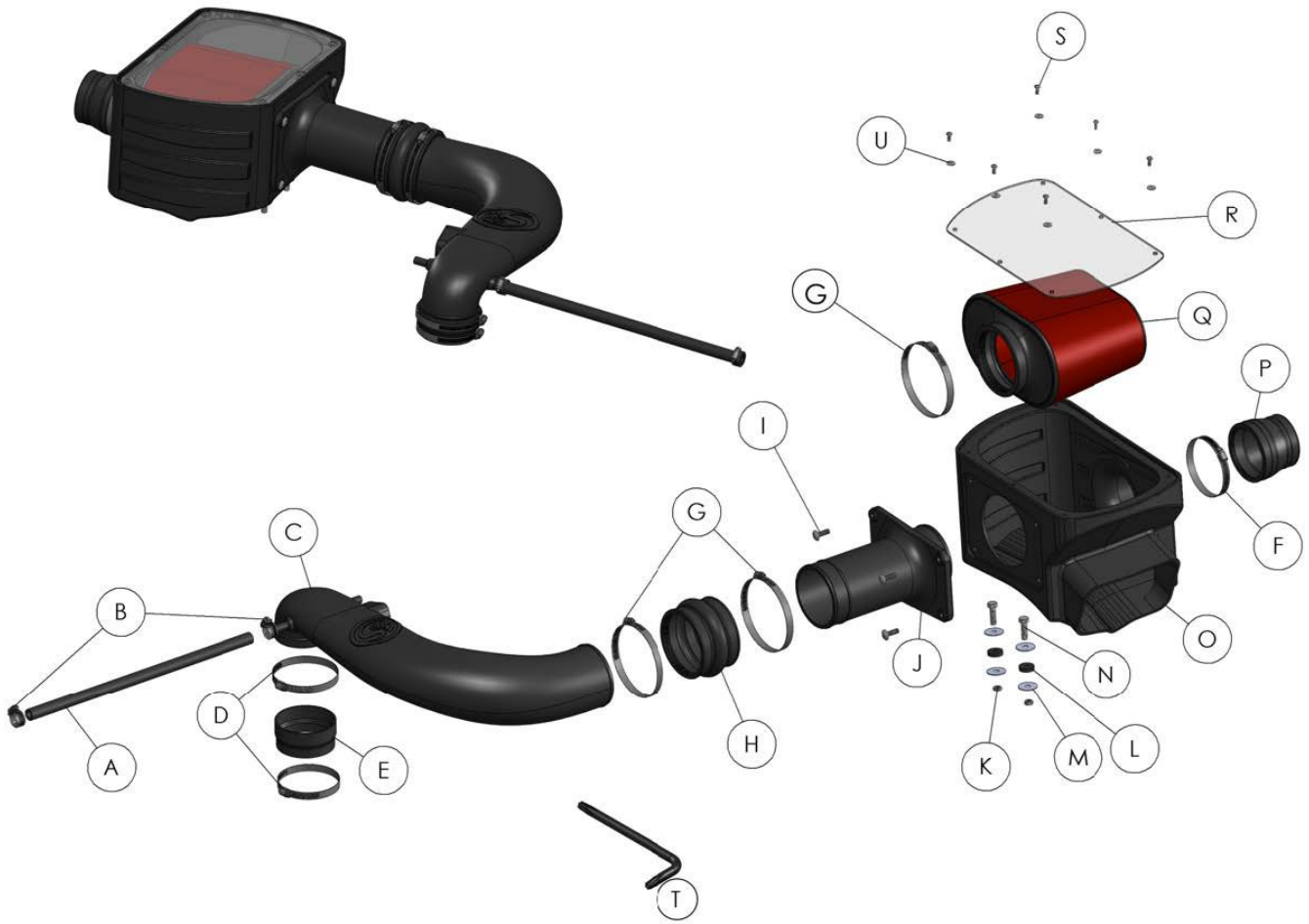

ITEM	QTY.	DESCRIPTION	P/N
A	1	Hose, 18" Crank Case Vent	AI1038-00
B	2	Hose Clamp, #8	AG1000-00
C	1	Intake Tube	AL1121-00
D	2	Hose Clamp, #60	AG1008-00
E	1	Adapter, Step, 3.50"-3.75"	AI1306S-00
F	1	Hose Clamp, #56	AG1019-00
G	2	Hose Clamp, #72	AG1009-00
H	1	Adapter, Hump,	AI1286-00
I	4	Screw, Pan Head, 5/16-18x1"	AI1297-00
J	1	Air Filter Adapter	AL1122-00
K	2	Nut, Lock, 5/16"-18	AI1298-00
L	2	Rubber Spacer, 1.75"OD	AI1471-00
M	4	Washer, Fender, 5/16"	AI1080-00
N	2	Bolt, Hex, 5/16-18x1.0"	AI1199-00

ITEM	QTY.	DESCRIPTION	P/N
O	1	Air Box	AL1149-00
P	1	Adapter, Step, 3"-3.50"	AI1088-00
Q	1	S&B Air Filter	KF-1049A
R	1	Clear Lid	AI1296-00
S	6	Screw, Pan Head, 10-24x1/2"	AI1287-00
T	1	T-20 Security Torx Wrench	AI1327-00
U	6	Washer, Sealing, #10	AI1272-00

STEP 1

With the ignition switched off and the parking brake set, disconnect the negative battery cable.

IMPORTANT: Failure to disconnect the battery for a minimum of 2 hours may cause the Check Engine Light to illuminate upon completion of the installation or subsequent operation.

DO NOT SKIP THIS STEP!



STEP 2

Disconnect the crankcase vent line from the passenger side valve cover and airbox and remove it.



STEP 3

Disconnect the electrical connection for the MAF sensor, at the airbox on the Driver's side.

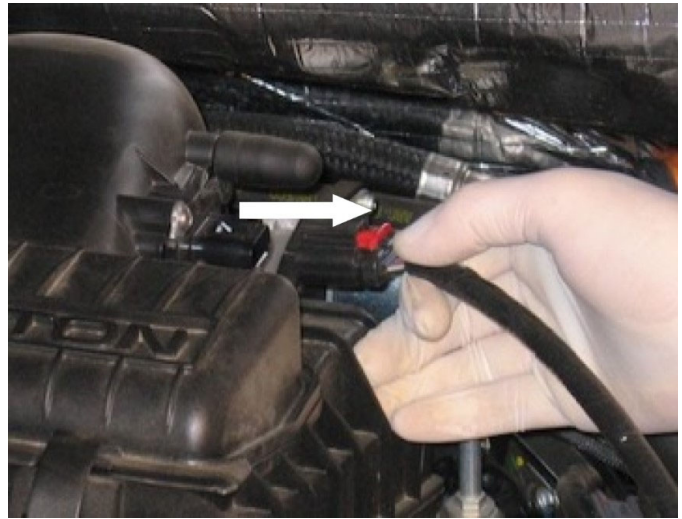

STEP 4

IF EQUIPPED: Disconnect the brake booster vacuum line from the airbox on the Driver's side.

Note: ONLY IF EQUIPPED, the S&B Intake Tube (C) must be cut at the trim line prior to installation.



STEP 5

IF EQUIPPED: Remove the

bolt that secures the OE intake tube assembly to the engine



STEP 6

Remove the 4 studded bolts that secure the OE airbox to the intake manifold.

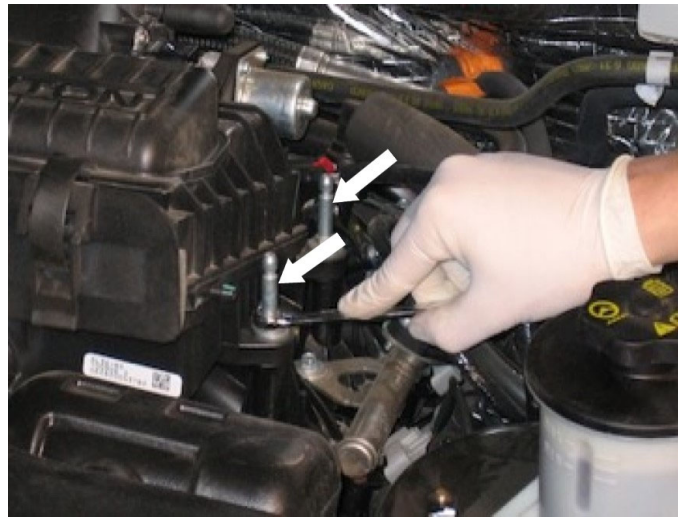

STEP 7

Unclip the wire loom from the OE airbox.



STEP 8

Pull up at the throttle body to remove the intake assembly from the vehicle.



STEP 9

IF EQUIPPED: Remove the OE tube bracket only. Re-install the lower nut on the mounting stud and tighten.



STEP 10

IF EQUIPPED: Remove the OE rubber grommets from the inner fender on the Driver's side

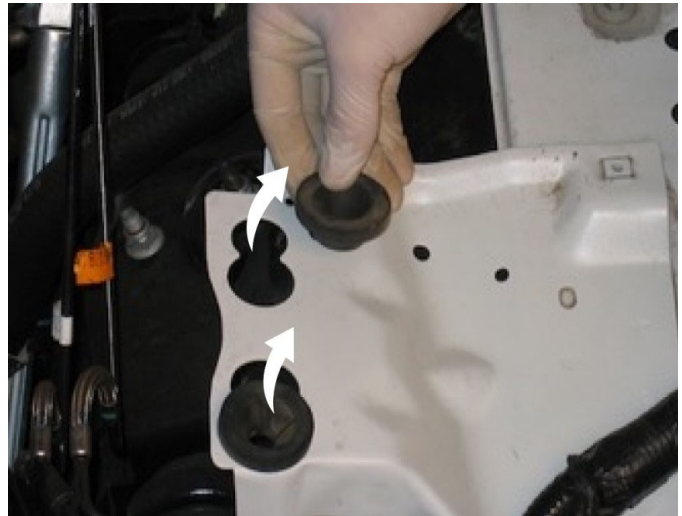

STEP 11

Relocate the wire loom closer to the inner fender.



STEP 12

Install the Step Adapter (P) on the Airbox (O) fender snout, push on as far as it will go and secure with a #56 Hose Clamp (F).



STEP 13

Place the Rubber Spacer (L) over the holes on the fender.



STEP 14

Install the Airbox (O) and secure using the 5/16" Bolt (N), Fender Washer (M), Rubber Spacer (L) and Lock Nut (K). SEE DIAGRAM.



STEP 14 IMAGE 2

Airbox Mounting Diagram

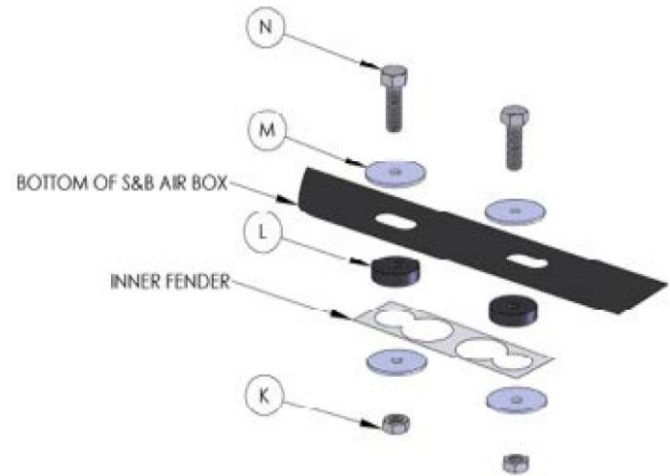

STEP 15

Place the Air Filter (Q) inside the Airbox (O). Offset flange is toward the front of the vehicle. Snap the Filter Adapter (J) into the Air Filter (Q) and secure with #72 Hose Clamp (G).

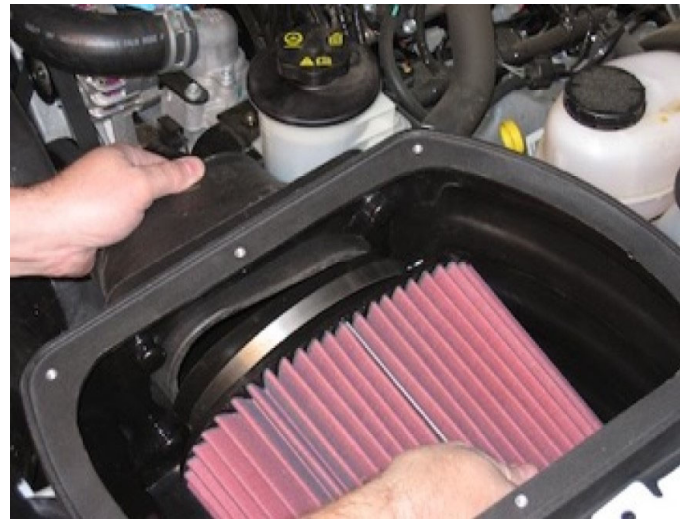

STEP 16

Secure the Filter Adapter (J) to the Airbox (O) using the 4 supplied 5/16" Phillips Head Screw (I).

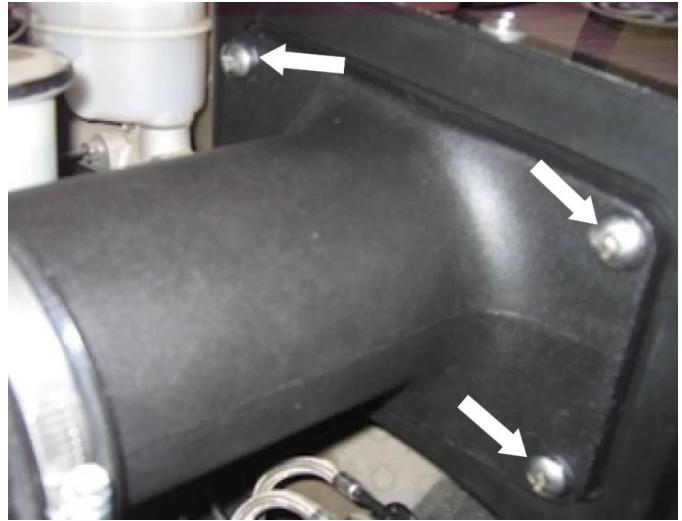

STEP 17

Place the Hump Adapter (H) and #72 Hose Clamp (G) over the Filter Adapter (J).
Do not tighten at his time.



STEP 18

Install the Step Adapter (E) over the Intake Tube (C) and secure using a #60 Hose Clamp (D).

Note: You may find it easier to install the Adapter (E) on the throttle body first then install the Intake Tube (C) in Step #21.



STEP 19

Remove the MAF sensor from the OE airbox using the supplied #T-20 Torx wrench. Note the direction of the sensor related to airflow.



STEP 20

Install the MAF sensor into

the Intake Tube (C), evenly secure using the OE screws. **DO NOT OVERTIGHTEN.**



STEP 21

With #60 Hose Clamp (D) in place, install the Intake Tube (C) and adapter over the throttle body. Install the opposite end of the intake tube into the Hump Adapter (H). Tighten all clamps, starting with the throttle body.



STEP 22

Reconnect the MAF sensor electrical connection.



STEP 23

Install the Crank Case Vent Hose (A) at the valve cover and Intake Tube (C) on the Passenger's side. Secure both ends using the #8 Hose Clamp (B).



STEP 24

IF EQUIPPED: Attach the OE brake boost vacuum line to the Intake Tube (C) on the Driver's side and secure

using a #8 Hose Clamp (B).

Caution: Intake Tube (C) must be modified if equipped with a vacuum line. See step #4



STEP 25

Remove the protective covering from the Clear Lid (R) and install it on the Airbox (O). Secure using the 10/24 Screw (S) and Sealing Washer (U). **Do not overtighten.**



STEP 26

Reconnect the battery.
Inspect your installation,
make sure the kit is properly
positioned and all fasteners
are secure. Affix the CARB
sticker near the intake kit.
The installation is now
complete.

