

Ranch Hitch Adapter

INSTALLATION MANUAL

For Part #3100 (straight) & #3139 (8" offset) • 24,000 lbs GTWR - 6,000 lbs Tongue

IMPORTANT! DEALER OR INSTALLER: Please make sure your customer receives this manual for safety tips, warranty, and future removal or installation information



Table of Contents

Important Safety Information	Page 2
Parts Illustration	Page 2
Tools Needed for Installation	Page 2
Section 1: Preparation	Page 3
Section 2: Installing the Base Unit	Page 3
Section 3: Attaching the Remote Latch Cable Bracket	Page 5
Section 4: Installing Quick Release & Hitch Hookup	Page 6
Warranty Information	Page 7

Want to see a video of the install?



Use your Smart Phone to scan the QR Code above and to go to our Installation Videos on the web.

Ranch Hitch

Adapter

ANDERSEN



andersenhitches.com

**100%
USA
MADE**



**SUPPORT
USA JOBS**

Contact Customer Service: 1-800-635-6106
customerservice@anderseninc.com





IMPORTANT SAFETY INFORMATION



Read the entire manual before using the Ranch Hitch Adapter to tow.

Before each trip—and regularly during a trip—check all hardware, bolts and nuts for wear and fatigue, and make sure that they are all properly tightened and secured in place.

The Ranch Hitch Adapter is **NOT** recommended for cushioned or moveable pin boxes, only on static pin box applications. If you have a cushioned pin box you may want to use our Ultimate 5th Wheel Connection fifth wheel hitch instead.



As with any 5th wheel hitch, there is a point beyond which every trailer *will* contact the tow vehicle. Each trailer is unique, so become familiar with your specific vehicle/trailer limitations.

Because Andersen Manufacturing has no control over your trailers' pin box and frame construction, we ask you to use caution on your first towing experience with the Ranch Hitch Adapter. Be aware of what your trailer is telling you. If you are feeling undue chucking, or if you feel significant surging when stopping or starting, additional reinforcing gussets may need to be positioned in or on your pin box. A good welder will be able to shore things up, and you will be safely on your way. If you are unsure, please feel free to call us.

PARTS ILLUSTRATION – Ranch Hitch Adapter

Straight Adapter - Part #3100

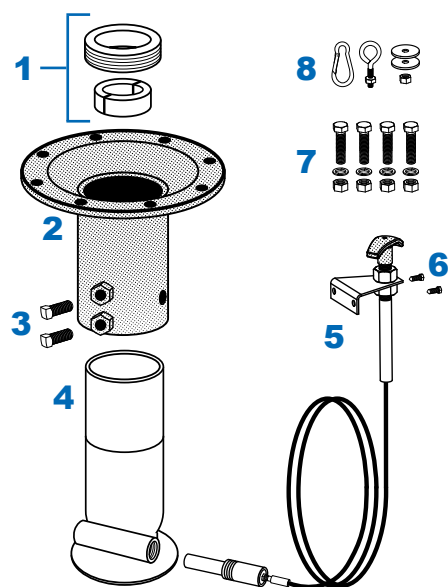

Installation Tools

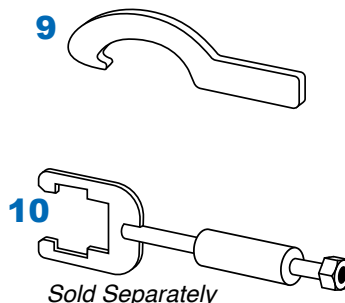

8" Offset Adapter - Part #3139

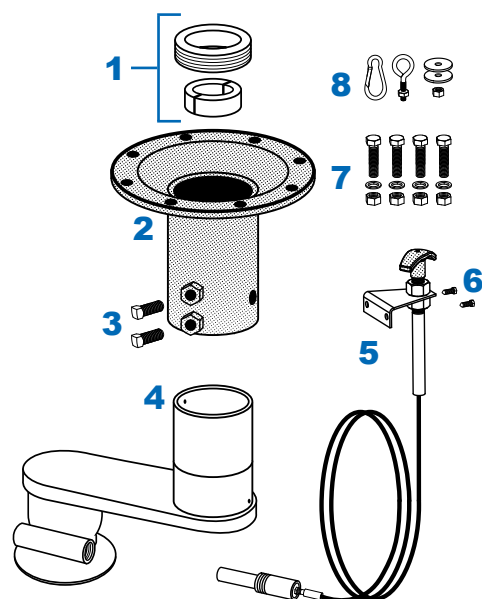

1. **Threaded Collar Assembly** (one threaded collar and two split collar halves) #3110
2. **Ranch Hitch Adapter Base** #3102
3. **Set Bolts** (2 pcs) #3107
4. **Ranch Hitch Stinger** (straight or 8" offset) #3101 or #3140
5. **Remote Cable Latch and Bracket** #3112
6. **Self Tapping Screws** (2 pcs) #3107
7. **3/4" Grade 8 Bolts** with washers and nuts (4 sets) #3107
8. **Safety Brake Cable Kit** (quick release snap, two 1/4" flat washers, two 1/4" nuts, 1 eye bolt) #3107
9. **Spanner Wrench** #3104
10. **Slide Hammer** (optional install tool, not included in kit) #3103

Tools Needed for Installation

- Anti-Seize Grease
- Spanner Wrench (included)
- Slide Hammer or Gear Puller
- "Cheater Pipe" (1.25" IM, less than 4' long)
- Electric Drill with 9/16" drill bit
- 3/4" Socket for grade 8 bolts
- 5/16" Socket for self-tapping screws
- 3/4" Crowfoot Socket or Socket Adapter for set bolts
- Torque Wrench capable of at least 180 ft-lbs of torque

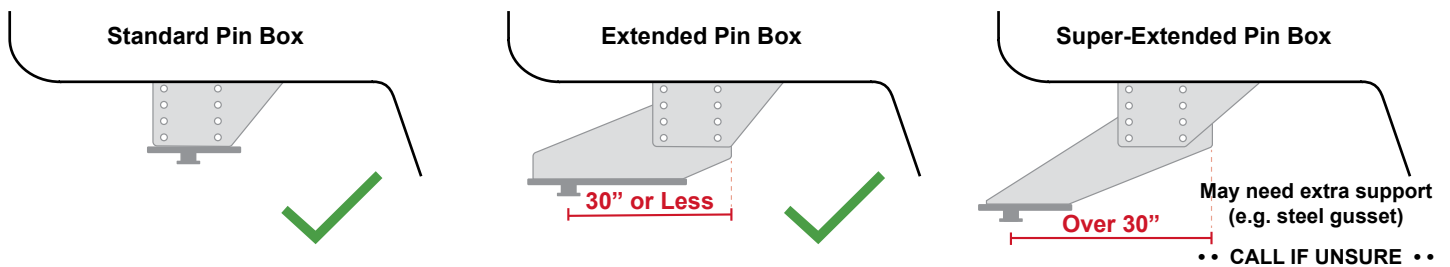

SECTION 1 : PREPARATION

Trailer Preparation

- Thoroughly inspect the trailer's pin box and frame for cracks or broken welds before installing the Ranch Hitch Adapter. Repair any problems before installation.
- On used trailers, inspect the king pin for wear and file any misshapen metal round again or the Ranch Hitch split collar will not install properly.
- If present, remove the plastic anti-friction plate as it is important that the Ranch Hitch adapter base be mounted directly to the metal of the pin box.
- Use your good judgment in determining that the Ranch Hitch Adapter and the Trailer will work together to achieve the desired results (e.g. the heavier a trailer is, the shorter or stouter your pin box should be).

1-1. Unpack the Ranch Hitch adapter box and make sure there are no missing parts by comparing items to the Parts List on page 2 in this manual. Note that the threaded collar is screwed into the black base at the factory to keep the threads from getting damaged in shipping. Contact Andersen's Customer Service Dept. if any parts are missing or damaged.

SECTION 2: INSTALLING THE BASE UNIT

2-1. Liberally apply anti-seize grease to the split collets and threaded collar (shown right) and the trailer king pin. This will make removal easier if you ever find the need.

NOTE: The threaded collar and each split collet is stamped with an 'X' on the bottom. **When assembling, ensure that all 'X' marks point down because the threaded collar and split collets are tapered.**

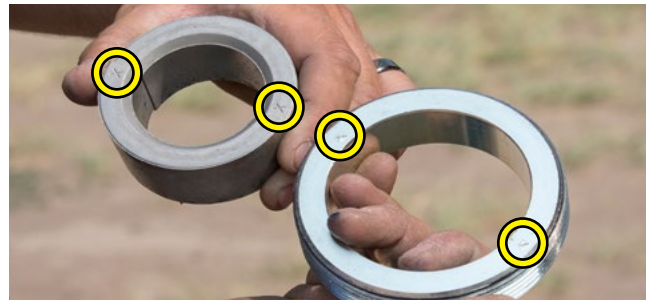

2-2. With the marked 'X' pointing down on each piece, slide the threaded collar over the king pin and, while holding the collar up, place the split collets around the narrow neck of the king pin. Slide the threaded collar down over the split collets and pull tight.

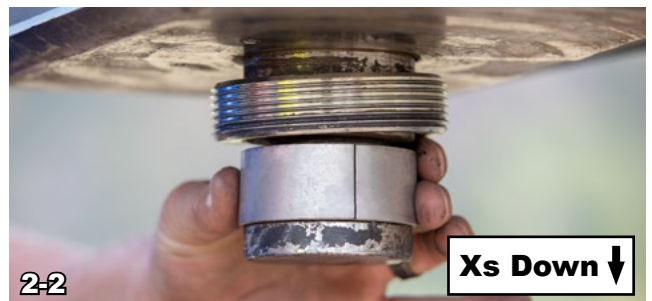

2-3. Seat the threaded collar over the split collets with enough force that it does not slide up or spin when you thread the black base onto the threaded collar. You can accomplish this by using our Slide Hammer (*sold separately, part # 3103*) or a gear puller to lightly seat the threaded collar onto the split collets. If you are using a gear puller, one full turn from finger-tight is sufficient to seat the collar and collets.

NOTE: Our Slide Hammer makes both installation AND removal of the Andersen Ranch Hitch Adapter easier.



2-4. Apply anti-seize grease to the inner threads of the Ranch Hitch Adapter base. Thread it clockwise onto the seated collar, being careful not to cross-thread the base. Spin the base onto the collar — it should spin very easily — until the base contacts the bottom of the pin box. Inspect the base/pin box contact area and make sure the two touch each other without any gaps.

2-5. Locate the spanner wrench and “cheater pipe” (not to exceed 4 ft). Insert spanner wrench into the punched hole near the bottom of the base. Place cheater pipe over spanner wrench and tighten to about 400 ft-lbs torque (this will be about as much as two men can generate by pulling together on the end of your cheater pipe). This will finish seating the threaded collar onto the split collar and ensure a very strong grip on the king pin.

2-6. Locate the grade 8 bolts, lock washers and nuts. There are 8 holes drilled in the Ranch Hitch Adapter Base, but only four need to be used. You will be responsible to choose which 4 holes will be used to accept the Grade 8 Bolts. Try to evenly spread the load as much as possible. Take care to locate the bolts where they will not interfere with any gusseting that might be inside the pin box. Drill the four holes using a 9/16” drill bit. Insert the bolts into each hole and secure with a lock washer and nut. Tighten to 55 ft-lbs.

NOTE: Some pin boxes are enclosed and cannot be accessed for placement of the washers and nuts. In this case, or in any other application, the Grade 8 Bolts can be replaced by 4 one-inch tack welds placed by a certified welder. **Drilling and tapping the pin box metal to accept the grade 8 bolts will not offer sufficient strength and is not acceptable.**

2-7. Place the stinger into the base and lightly tighten the set bolts enough to hold the stinger in place.

❖ **IMPORTANT** The silver stinger tube has a scribed line about half way up the tube. **This line must not be visible when the stinger is in its final or lowest adjustment position in the base** or there will not be sufficient stinger material inside the base for the set bolts to engage.



2-8. Back the tow vehicle under the trailer and determine the necessary position of the stinger to ensure the trailer is level and the overshoot has sufficient clearance from truck bed sideboards.

- If you are installing the #3100 Ranch Hitch Adapter, install it so the open end of the cable receiver points toward the pin box.
- If you are installing the #3139 8" offset Ranch Hitch Adapter, the extension needs to be carefully positioned parallel to the centerline of the trailer with the coupler closer to the cab of the tow vehicle.

When you have determined the final position of the Stinger, tighten the set bolts to 180 ft-lbs of torque.

2-9. Insert the pin and cylinder of the Remote Cable Latch into the horizontal cable receiver on the stinger. Twist the entire cable unit until the cylinder is tightly fitted. Then, tighten the nut located at the cable insertion point until snug.

❖ IMPORTANT DO NOT OVERTIGHTEN THE CABLE CONNECTION NUT as it can apply undue stress to the cable and weaken it.



SECTION 3: ATTACHING THE REMOTE LATCH CABLE BRACKET

NOTE: We suggest installing the remote latch cable bracket at the back of the pin box brackets, as shown right. If this location does not work on your trailer, make sure that the latch cable bracket is installed securely and that the cable and bracket will not come in contact with the truck side rails.



3-1. Use a 5/16" socket to install the two self-tapping screws provided.

❖ IMPORTANT The remote latch cable bracket should be installed so that the cable does not have any sharp turns or kinks in it. This allows the cable to operate correctly and prevents it from binding. For best results, we suggest installing the latch cable bracket on the opposite side of the pin box from where the cable enters the stinger.



3-2. Once installed, test the cable to ensure that the handle moves freely in and out. This will make sure that the pin attached to the kingpin coupler block is able to engage and disengage correctly.

Using the remote latch cable:

To engage, simply turn the handle in either direction to unlock it, push the handle until it's all the way in and then turn it fully in either direction to lock in place.

To disengage, turn the handle to unlock it, pull the handle until it's all the way out and then turn it fully in either direction to lock in place.

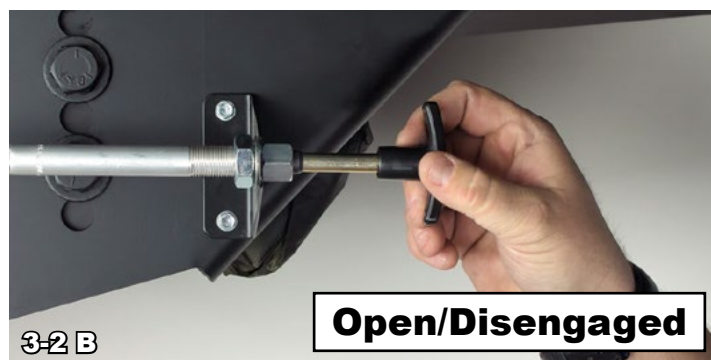
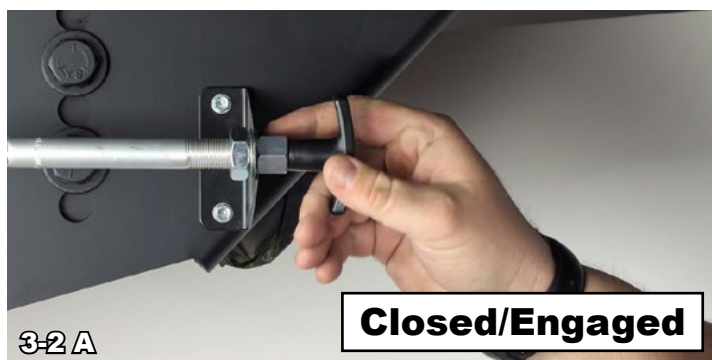

SECTION 4: INSTALLING QUICK RELEASE & HITCH HOOKUP

4-1. Most 5th wheel trailers are equipped with break-away brakes that need to be attached to your tow vehicle. A hardware package included with the Ranch Hitch Adapter can be used to create an attachment point. First, install the eye bolt into one of the tow vehicle's stake pockets — or location of your choice — using an existing hole or by drilling your own. Make sure you put a flat washer on each side of the hole. Place the quick release snap on the end of the break-away brake cable for easy connecting. (Do not forget to detach the cable when uncoupling the trailer from the tow vehicle.)

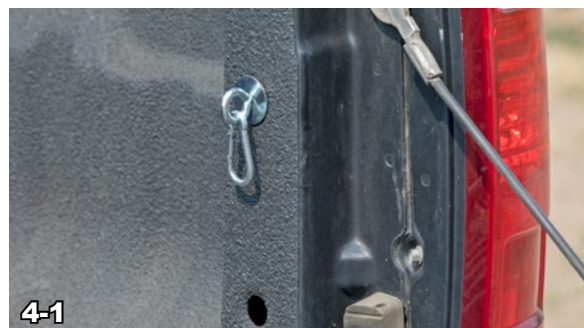

4-2. Make sure the Ranch Hitch Adapter coupler is open by twisting the T-handle in either direction and pulling it out. Couple the trailer and the tow vehicle together and engage the latch by pushing the T-handle in and turn it in either direction to lock it. Ensure the trailer and tow vehicle are fully coupled by lifting the trailer with its jack to assure the Ranch Hitch Adapter has locked onto the tow ball and the adapter doesn't slide off the ball. Then, connect the trailer break-away brake cable.



❖ IMPORTANT Because Andersen Manufacturing has no control over your trailers' pin box and frame construction, we would ask you to use caution on your first towing experience with the Ranch Hitch Adapter. Be aware of what your trailer is telling you. If you are feeling undue chucking, or if you feel significant surging when stopping or starting, additional reinforcing gussets may need to be positioned in or on your pin box. A good welder will be able to shore things up, and you will be safely on your way (see the support section of our website for sample). If you are unsure, please feel free to call us.

Some states require safety chains. Andersen offers heavy-duty Safety Chains (part #3109) that will fulfill this requirement.

Warranty Registration and Validation

Andersen Ranch Hitch Adapter

Send to: Andersen Hitches Registration

3125 N. Yellowstone Hwy, Idaho Falls, ID 83401

*All information must be completed and sent or faxed to Andersen Hitches 208-523-6562

OR simply go to www.AndersenHitches.com/register and complete your registration online.

Name: _____

Address: _____

City: _____ State: _____ Zip: _____

Phone: _____ E-mail: _____

Purchase Date: _____ Installed by: ☐ Dealer ☐ Self

Dealer name: _____ City: _____ State: _____

Ranch Hitch Adapter Limited Warranty

Andersen Manufacturing, an Idaho Corporation, having its principal place of business at 3125 N. Yellowstone Highway, Idaho Falls, Idaho 83401 ("Manufacturer") warrants its Ranch Hitch Adapter Product (the "products") for one year from the date of purchase as follows (Subject to the Conditions and Limitations listed herein):

Limited Warranty. Manufacturer warrants the Products sold hereunder will be free from defects in material, and workmanship when subject to normal and proper use for one year from date of purchase. If the Products do not conform to this Limited Warranty during the warranty period (as herein above specified), buyer shall notify Manufacturer in writing of the claimed defects and demonstrate to Manufacturer satisfaction that said defects are covered by this Limited Warranty. If the defects are properly reported to Manufacturer within the warranty period, and the defects are of such type and nature as to be covered by this warranty, Manufacturer shall at its own expense, furnish, replacement Products or, at Manufacturer's option, replacement parts for the defective Products. Removal, shipping and installation of the replacement Products or replacement parts shall be at Buyer's expense. The warranty card must be filled out and received by the manufacturer.

Other Limits. THE FOREGOING IS IN LIEU OF ALL OTHER WARRANTIES, EXPRESSED OR IMPLIED, INCLUDING BUT NOT LIMITED TO THE IMPLIED WARRANTIES OF MERCHANTABILITY AND FITNESS FOR A PARTICULAR PURPOSE. Manufacturer does not warrant against damages or defects arising out of improper or abnormal use of handling of the Products; against defects or damages arising from improper installation, including bolting the Ranch Hitch Adapter to the pin box as described in the instructions; against sudden impact arising from a collision of other abnormal occurrences; nor against any damage incurred to the trailer from the use of this adapter.

Since it is beyond the Manufacturer's control as to what trailers the Ranch Hitch Adapter may be installed on, and what condition the trailer frame or pin-box may be in, the Manufacturer will not warrant or assume liability for damages incurred. It has been the experience of the Manufacturer that if the trailer is a recently built model and the frame is in good condition, and the trailer brakes work properly, there should not be excess stress or damages to the frame. It is the responsibility of the purchaser to have the trailer braking system checked and maintained on a regular basis. The Manufacturer does not warrant against discontinuation of products, acts of God, defects in products or components not manufactured by Manufacturer, or against damages resulting from such non-Manufacturer made products or components. Manufacturer passes on to Buyer the warranty it received (if any) from the maker thereof of such non-Manufacturer made products or components. This warranty also does not apply to Products upon which repairs have been affected or attempted by persons other than pursuant to written authorization by Manufacturer. The weight ratings and certifications on the enclosed andersen hitch accessory is intended to represent only the product capability and in no way reflects the capacity or ratings of any towing system it is used with. In many cases, the rating of our hitch will be greater than those of the vehicle towing system, hitch, and trailer being used with our accessory. Manufacturer strongly advises the consumer and operator to learn the ratings of the various components of the towing system and to NOT exceed the limits of the lowest rated component.

Exclusive Obligation. THIS WARRANTY IS EXCLUSIVE. The sole and exclusive obligation of Manufacturer shall be to repair or replace the defective Products in the manner and for the period provided above. Manufacturer shall not have any other obligation with respect to the Products or any part thereof, whether based on contract, tort, strict liability or otherwise. It is understood the seller's liability, whether in contract, in tort, under any warranty, in negligence or otherwise, shall not exceed the return of the wholesale amount of the purchase price paid by the purchaser. Under no circumstances, whether based on this Limited Warranty or otherwise, shall Manufacturer be liable for incidental, special, or consequential damages. The price stated for the product is considered in limiting sellers liability.

Other Statements. Manufacturer's employees or representative's ORAL OR OTHER WRITTEN STATEMENTS DO NOT CONSTITUTE WARRANTIES, shall not be relied upon by Buyer, and are not a part of the contract for sale or this limited warranty. As mentioned above, Purchaser is responsible to maintenance checks on the braking system on a regular basis.

Entire Obligation. This non-Prorated Limited Warranty states the entire obligation of Manufacturer with respect to the Products. If any part of this Limited Warranty is determined to be void or illegal, the remainder shall remain in full force and effect. Notice of any warranty situation must be sent to Manufacturer by registered mail in writing and include a photograph of the defective or damaged part.

Return Merchandise Authorization (RMA) and warranty procedure may be obtained by visiting Andersen's website at www.andersenhitches.com and clicking on 'Return Policy' at the bottom of the page, or by calling our customer service department at 1-800-635-6106.

ANDERSEN HITCHES



Premier Towing Products

See our full line of towing products at
www.AndersenHitches.com



Aluminum Rapid Hitch
Greaseless & Standard
2" or 2-1/2" shank available



Ultimate Trailer Gear Duffel Bag
The must-have 14-pc kit for all Trailers
Kit includes 1 Rapid Jack (with rubber pad),
1 Clean Step, 2 Camper Levelers, 4 TUFF Pads,
4 TUFF Chocks and heavy-duty Duffel Bag!



EZ Adjust Hitch & EZ HD
from 10K to 16K Heavy Duty
2", 2-1/2", or 3" shank available



Camper Leveler
Level your trailer on the first try!
Each kit includes chock and leveler



Ultimate Connection 5th Wheel Hitch
Smoothest ride for 5th Wheel RV's
Connects your Kingpin to a Gooseneck ball
or standard Rails



Trailer Jack Block
Stabilize your RV or Trailer
Attaches to Your Jacks with Magnets

SUPPORT USA JOBS



Made in USA



www.AndersenHitches.com • 1.800.635.6106