

Troubleshooting Guide

PACBRAKE®

www.pacbrake.com 800.663.0096

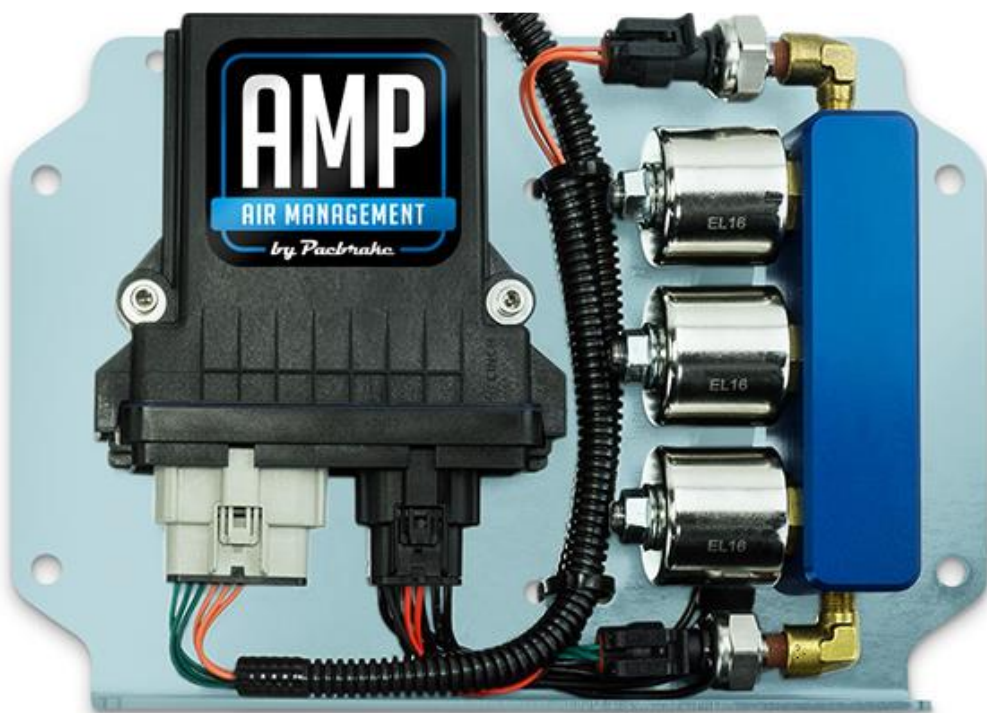

HP10316 KIT

AMP Wireless Air Controls

Take control of your air springs through the AMP Wireless Control application. Requires Air Springs and Onboard Air Systems (sold separately)

For use with Android™ Devices





IMPORTANT: Prior to proceeding:

- Ensure all wiring harness and airline connections are secure.
- Inspect all wiring for signs of damage or wear that could cause electrical shorts or discontinuities.

Mobile device does not pair to the AMP Controller

Cause	Solution
Incorrect/unsupported device or operating system	<ul style="list-style-type: none"> • Ensure the device operates on Android 4.2 (Jellybean) or newer
Insufficient power applied to the controller	<ul style="list-style-type: none"> • Ensure the power wires are connected to the correct terminals, and the vehicle ignition is on • Check the 10A fuse in the wiring harness
Communication issue between the controller and the phone	<ul style="list-style-type: none"> • Ensure the controller is within Bluetooth range (10, 30ft) and that the AMP controller is not mounted within a metal surround (trunk/engine bay) • Some mobile devices may discover the controller as its unique Bluetooth address in the following format: XX:XX:XX:XX:XX:XX Pair normally and rename the controller to PACBRAKE AMP • Cycle ignition power to reset the controller and refresh the communication

Cannot connect to the AMP Controller from within the Application

Cause	Solution
Incorrect/unsupported device or operating system	<ul style="list-style-type: none"> • Ensure the device operates on Android 4.2 (Jellybean) or newer
Insufficient power applied to the controller	<ul style="list-style-type: none"> • Ensure the power wires are connected to the correct terminals and the vehicle ignition is on • Check the 10A fuse in the wiring harness
Communication issue between the controller and the phone	<ul style="list-style-type: none"> • Ensure the controller is within Bluetooth range (10m, 30ft) and that the AMP controller is not mounted within a metal surround (trunk/engine bay) • Check device's Bluetooth Settings and ensure the controller is named PACBRAKE AMP • Ensure that only one PACBRAKE AMP device is paired (un-pair other devices) • Certain phones may have difficulty connecting, turn off other wireless communications and retry • Cycle ignition power to reset the controller and refresh the communication

Air solenoids are not activating

Cause	Solution
Insufficient power applied to the controller	<ul style="list-style-type: none"> Ensure the power wires are connected and the vehicle ignition is on Check the 10A fuse in the wiring harness
Solenoids have frozen	<ul style="list-style-type: none"> Humidity in the air may condense and freeze at low temperatures

System does not hold pressure

Cause	Solution
A leak may exist in one or more of the connections.	<ul style="list-style-type: none"> Spray soapy water on all airline connections to detect any air leaks. Repair as necessary and retest

Air springs will not stop filling or draining

Cause	Solution
App/signal connection is dropping intermittently	<ul style="list-style-type: none"> Ensure the controller is within Bluetooth range and that the AMP controller is not mounted within a metal surround (trunk/engine bay)

App shows pressure in the Air Springs when empty

Cause	Solution
Pressure sensors are out of calibration	<ul style="list-style-type: none"> Recalibrate

Select BOTH

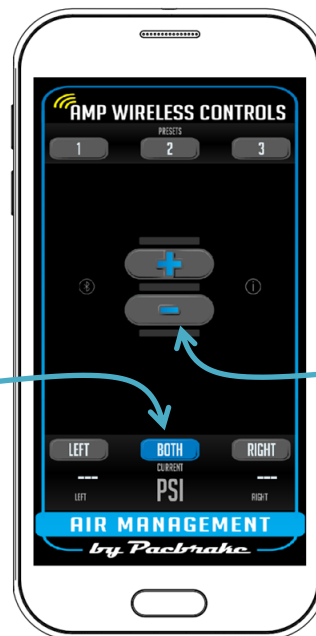

Hold for 60sec



Air springs fill or drain unevenly

Cause	Solution
Air lines between the AMP wireless control board and the Air Springs are different lengths	<ul style="list-style-type: none">Adjust the length of the lines to be as equal as possible

Air springs fill or drain in opposite orientation

Cause	Solution
Air lines are plugged into the incorrect LEFT and RIGHT ports	<ul style="list-style-type: none">Swap LEFT and RIGHT airlines by pressing down the collar of the fittings to remove the lines

Legal

- Google Play and the Google Play logo are trademarks of Google LLC
- Android is a trademark of Google LLC
- The Android robot is reproduced or modified from work created and shared by Google and used according to terms described in the Creative Commons 3.0 Attribution License.