

S5520

2004-2006 JEEP
WRANGLER/RUBICON (TJ) UNLIMITED
(EXTENDED),
4.0L, CAT BACK, SINGLE TURN DOWN

MBRP®

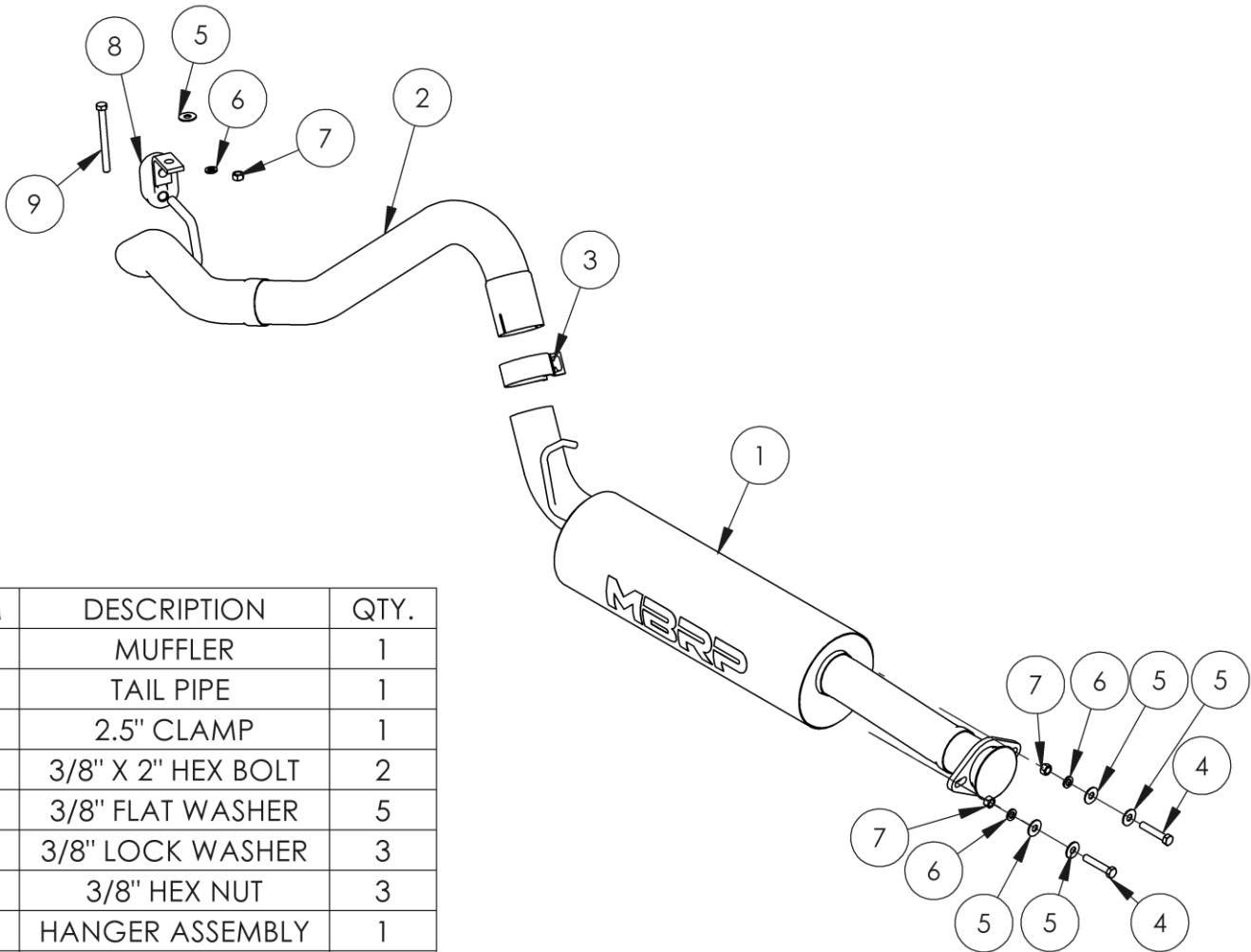

ITEM	DESCRIPTION	QTY.
1	MUFFLER	1
2	TAIL PIPE	1
3	2.5" CLAMP	1
4	3/8" X 2" HEX BOLT	2
5	3/8" FLAT WASHER	5
6	3/8" LOCK WASHER	3
7	3/8" HEX NUT	3
8	HANGER ASSEMBLY	1
9	3/8" HEX BOLT X 4"	1

PLEASE READ BEFORE STARTING INSTALLATION

While MBRP has made every effort to ensure that all components of this system are of superior quality and properly packaged, it is the installer's responsibility to ensure the following before removal of the factory exhaust:

- that ALL components shown above are present.
- that ALL mating components fit together.
- that there are no damaged components.
- that the system you have purchased is appropriate for your vehicle year, model and configuration.
- that the system will not interfere with any modifications previously installed or planned.
- that you have read and understand these instructions.

If you have any questions or are uncertain about any aspect of the installation of this system to your vehicle please contact your dealer before commencing installation.

MBRP[®]

Removal of Stock System:



Figure 1



Figure 2



Figure 3

1. Apply a penetrating lubricant liberally to all exhaust fasteners, hangers and rubber insulators.

2. Cut the exhaust pipe after the muffler to be able to remove it from the vehicle. **Refer to Figure 1.**

3. Remove the tail section of the exhaust by removing it from the rubber isolators. **Refer to Figure 2.**

4. Remove the hardware from the flange and remove the muffler. **Refer to Figure 3.**

MBRP®



Figure 4



Figure 5



Figure 6



Figure 7

Installation of MBRP Performance Exhaust:

1. Install the **Muffler** to the existing flange using the fasteners provided. Slide the **Muffler** hanger into the existing rubber isolator. **Refer to Figure 4.**

2. Slide the 2 ½” **Clamp** over the **Muffler** outlet then install the **Tail Pipe** to the **Muffler**. Use the fasteners provided to install the **Exhaust Hanger** through the existing hole in the frame located just above the **Tail Pipe** hanger. Install the **Tail Pipe** hanger into the rubber isolator. **Refer to Figures 5 & 6.**

3. The existing Tail pipe hanger can be removed from the outside frame rail. **Refer to Figure 7.**

4. Tighten all hardware and clamps, starting at the front and working rearward to secure the system. Check along the full length of the exhaust system to ensure there is adequate clearance for fuel lines, vent lines, brake lines, frame, bodywork, suspension and any wiring, etc. If there is any interference detected, relocate or adjust to provide adequate clearance. Ensure all clamp connections are secure and components are unable to rotate or slide. Band clamps require approximately 45 lb-ft (60 N-m) of torque. Verify clearances, system security and band clamp torque after 30- 60 miles (50-100 km) of driving.

Congratulations! You are ready to begin enjoying the improved performance and driving experience of your **MBRP** Performance Exhaust system. We hope you enjoy your purchase!