

INSTALLATION INSTRUCTIONS

PRODUCT: 2003 – 2018 Dodge Cummins Auxiliary Fuel Filter Kit

FPE-2019-36
October, 2019
Page 1 of 3

FITMENT: 2003 – 2018 Dodge Cummins

KIT P/N: FPE-34783

KIT CONTENTS:

Item	Description	Qty
1	Donaldson 3 Micron Fuel Filter	1
2	Single filter base mount	1
3	Distribution filter block to filter coupler	1
4	-8 to 3/4"-16 straight fitting	3
5	3/4"-16 hex plug socket	1
6	M12 to -8AN fitting (used with 5.9L pumps only)	1
7	-8, 45deg to hose barb fitting	3
8	-8, 90deg to hose barb fitting	1
9	1/8" NPT socket plugs	2
10	1/2" push lock hose	16 ft
11	12mm sealing washer	1
12	Fuel line retaining clip	1
13	Zip ties	10
14	CP3 feed fitting (use with 6.7L pumps only)	1
15	Mounting bracket and fasteners	1
16	Zip ties	10



WARNINGS:

- USE OF THIS KIT REQUIRES THE USE OF THE APPROPRIATE MODEL YEAR FUEL FILTER DELETE KIT.
- Fuel lines must be clean before installation.
- The purchaser and end user releases, indemnifies, discharges, and holds harmless Fleece Performance Engineering, Inc. from any and all claims, damages, causes of action, injuries, or expenses resulting from or relating to the use or installation of this product that is in violation of the terms and conditions on this page, the product disclaimer, and/or the product installation instructions. Fleece Performance Engineering, Inc. will not be liable for any direct, indirect, consequential, exemplary, punitive, statutory, or incidental damages or fines cause by the use or installation of this product.

INSTALLATION INSTRUCTIONS

FILTER BLOCK AND PLUMBING:

FPE-2019-36
October, 2019
Page 2 of 3

To injection pump feed
(use new sealing washer)

For 5.9L engines – Use the
12mm to -8AN fitting

For 6.7L engines – Use the
CP3 barbed feed fitting

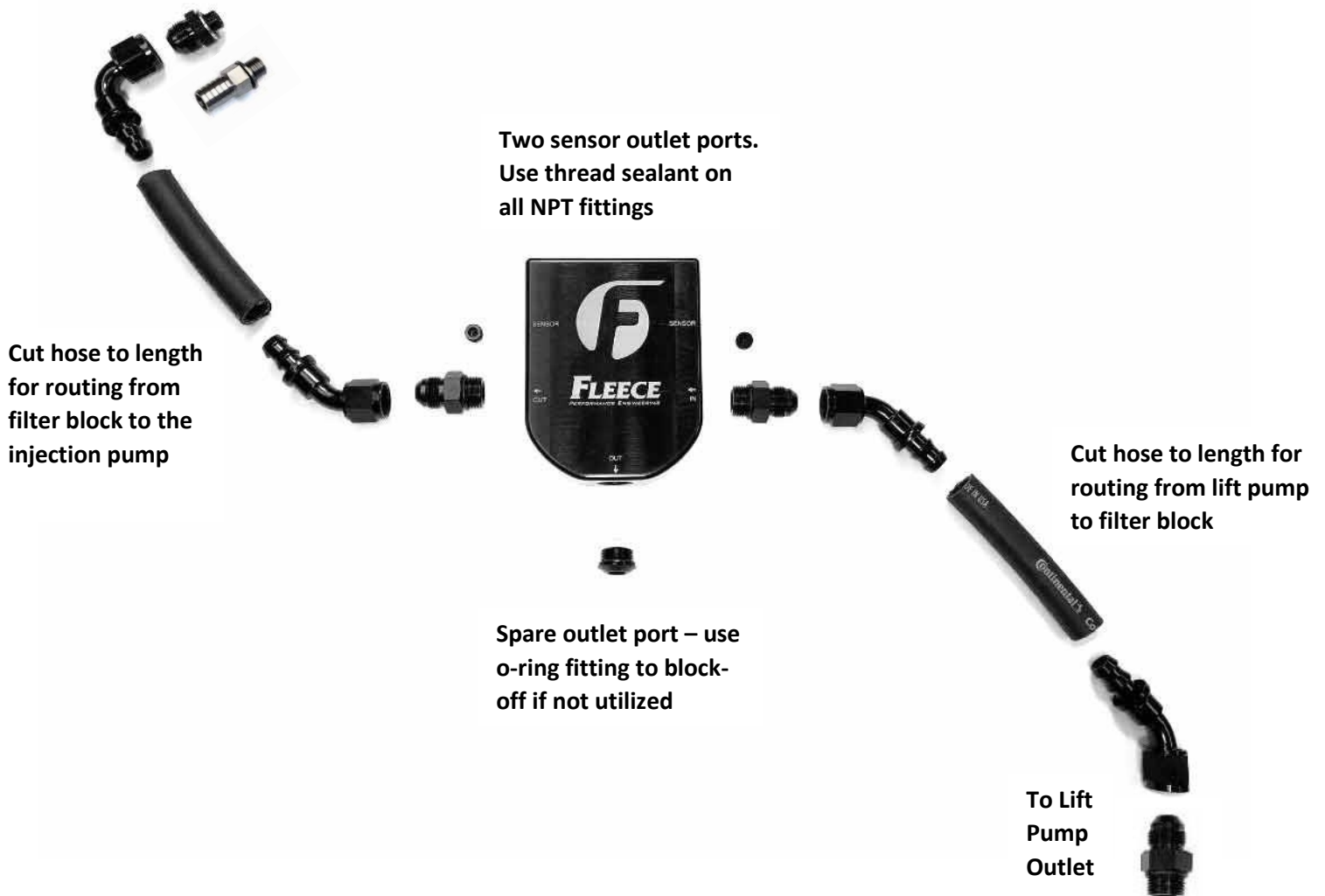

FILTER BLOCK AND PLUMBING INSTRUCTIONS:

STEP 1: If equipped, remove the stock fuel bowl from the engine bay. Disconnect electrical connectors for the Water in Fuel Sensor and Heater. A FUEL FILTER DELETE (NOT INCLUDED WITH THIS KIT) IS REQUIRED FOR THE USE OF THIS KIT.

STEP 2: Disconnect fuel lines

STEP 3: Remove the fuel bowl that is retained with two 10 mm bolts.

STEP 4: Install all fittings and new filter onto the Fleece filter block. Mount the filter block in the same location as the OE fuel bowl using the two cap head bolts provided (see images below).

STEP 5: Route the fuel line from the fuel tank to the filter block housing. Retain the fuel line to the chassis using zip ties. Avoid routing the line near moving components. Install a 45 degree pushlock fitting at either end of the hose.

STEP 6: Install the new 12mm sealing washer and 12mm to -8AN fitting onto the high pressure pump for 5.9L engines. Install the CP3 barbed feed fitting onto the high pressure pump for 6.7L engines. Ensure that the original sealing washer has been removed from the pump surface.

STEP 7: Route the fuel hose from the filter block to the high pressure pump. Use the 45 deg pushlock fitting on the filter block end.

STEP 8: Bleed the fuel system all the way to the injectors.

STEP 9: Start the engine and check for leaks.



Visit <http://fleeceperformance.com/resources/> for the latest installation instructions.

For Technical Assistance contact Fleece Performance Engineering at 855-839-5040.