



# INSTALLATION INSTRUCTIONS



2007.5-2017 DODGE 2500/3500 6.7L | PART NO. 17874

### BILL OF MATERIALS:

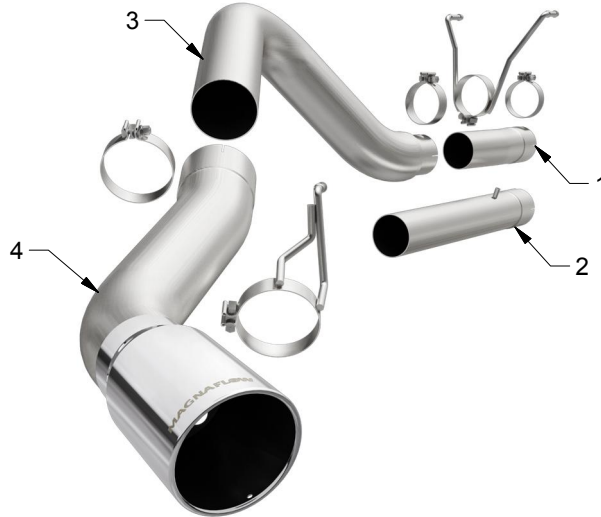

- 1. 2013-UP MEGA CAB INLET PIPE
- 2. 2013-UP CC/LB INLET PIPE  
2007.5-2012 CC/SB INLET PIPE  
2007.5-2012 MC/SB INLET PIPE
- 3. OVER AXLE PIPE
- 4. TAILPIPE ASSY



WEAR SAFETY GLASSES



READ INSTRUCTIONS THOROUGHLY BEFORE INSTALLING PRODUCT

### SHOP SUPPLIES:



SPRAY LUBRICANT

To ease removal of existing exhaust components (especially on older vehicles) spray penetrating lubricant on all fasteners and hangers/insulators that will be loosened or removed and let soak before disassembly.

### HARDWARE KIT:

- 1. [2] 4.00" Clamp
- 2. [1] 5.00" Clamp
- 3. [1] Hanger Clamp #1 - 4"
- 4. [1] Hanger Clamp #2 - 5"

### MINIMUM REQUIRED TOOLS:



15mm



Hanger Tool (Or Pry Bar)



Sawzall or other cutting tool

## MAGNAFLOW RECOMMENDS PROFESSIONAL INSTALLATION ON ALL THEIR PRODUCTS



**WARNING:** When working on, under, or around any vehicle exercise caution. Please allow the vehicle's exhaust system to cool before removal, as exhaust system temperatures may cause severe burns. If working without a lift always consult vehicle manual for correct lifting specifications. Always wear safety glasses and ensure a safe work area. Serious injury or death could occur if safety measures are not followed.

**ATTENTION:** Always install any supplied band or U-bolt clamps to the proper torque specifications of 40-45 ft-lbs for band clamps and 30-35 ft-lbs for U-bolt clamps. Over tightening will result in the clamp breaking and will NOT be warranted by MagnaFlow.

# INSTALLATION INSTRUCTIONS



**Step 1.** Begin removal of the OEM system by unclamping the OEM Extension Pipe and muffler from the junction behind the DPF. You can then disengage the welded hangers from the rubber insulators, working rearward finish removing the system. Do not damage or discard the rubber insulators or sensor bracket and fastener, as they will be reused to mount the new system.

EXTENSION PIPE TRIMS			ITEM
2013 AND LATER	CC/SB	NO EXTN.	N/A
	CC/LB	CUT 3.25"	2
	MC/SB	MC PIPE	1
2007.5 - 2012	CC/SB	CUT 16.75"	2
	CC/LB	NO CUT	N/A
	MC/SB	CUT 11.00"	2

**Step 2.** Before installing the new system determine which extension pipe configuration you will require. If you are cutting the Inlet Pipe [Item 2] to size measure from the end without the notches. Be sure to deburr and clean the cut edge.



**Step 3.** Begin installation of the Magnaflow system by clamping the Inlet Pipe or Over Axle Pipe (depending on vehicle configuration) to the outlet of the DPF using a supplied 4.00" clamp. Locate the alignment notch to the OEM outlet. Slide the Hanger Clamp Assembly over the pipe and locate the welded hangers in the rubber insulators (leave all clamps loose for final adjustment of the complete system).

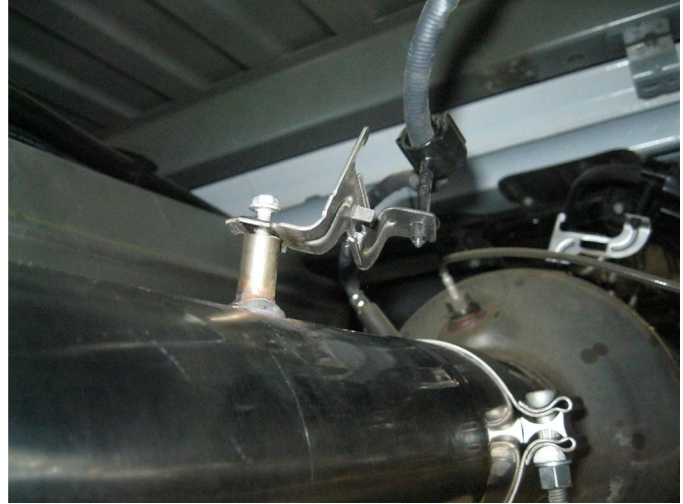

**Step 4.** For year spread 2013 and later with a long bed configuration attach the OEM cable bracket using the OEM bolt. This step is not required on other years or configurations.



**Step 5.** The shorter Inlet Pipe [Item 1] will be needed for all 2013 and later Mega Cab applications only.

## INSTALLATION INSTRUCTIONS



**Step 6.** Next, loosely slip the Hanger Clamp Assembly over the Tail Pipe Assembly and Install using the supplied clamps and by fitting the welded hangers into the rubber insulators.

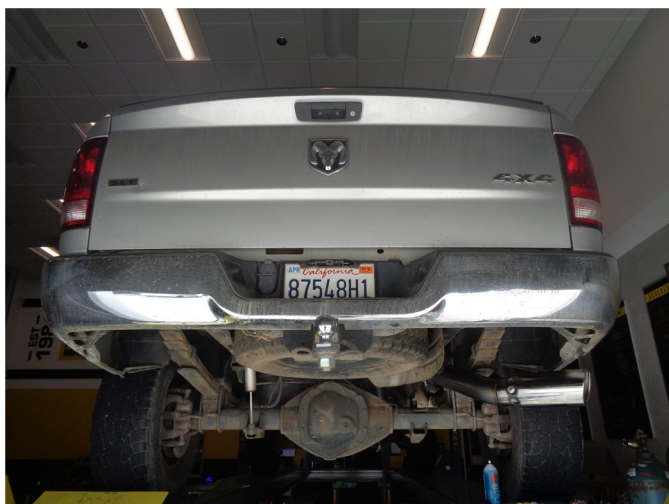

**Step 7.** Once a final position has been chosen for the new exhaust system, evenly tighten all clamps from front to rear using the torque specifications on page one of the instructions. Inspect all fasteners after 25-50 miles of operation and re-tighten if necessary.