



## INSTALLATION INSTRUCTIONS

MAKE: RAM

MODEL: 2500 / 3500

YEAR: 1994 - 2002

ENGINE: L6-5.7L (td)

FITS: All wheelbase, except cab & chassis

SATURN 4S Exhaust System

49-22004NM



### RACE ONLY DISCLAIMER

This is a Race Only product that is to be used solely for competition, it cannot be used on vehicles that are operated on public streets, roads or highways. Its use is limited to closed-course and open-course racing that is formally sanctioned by a recognized racing organization. Any other use, including recreational off-road use, could be in violation of local, state and federal laws. A competition acknowledgement / liability release form must be filled out and submitted.

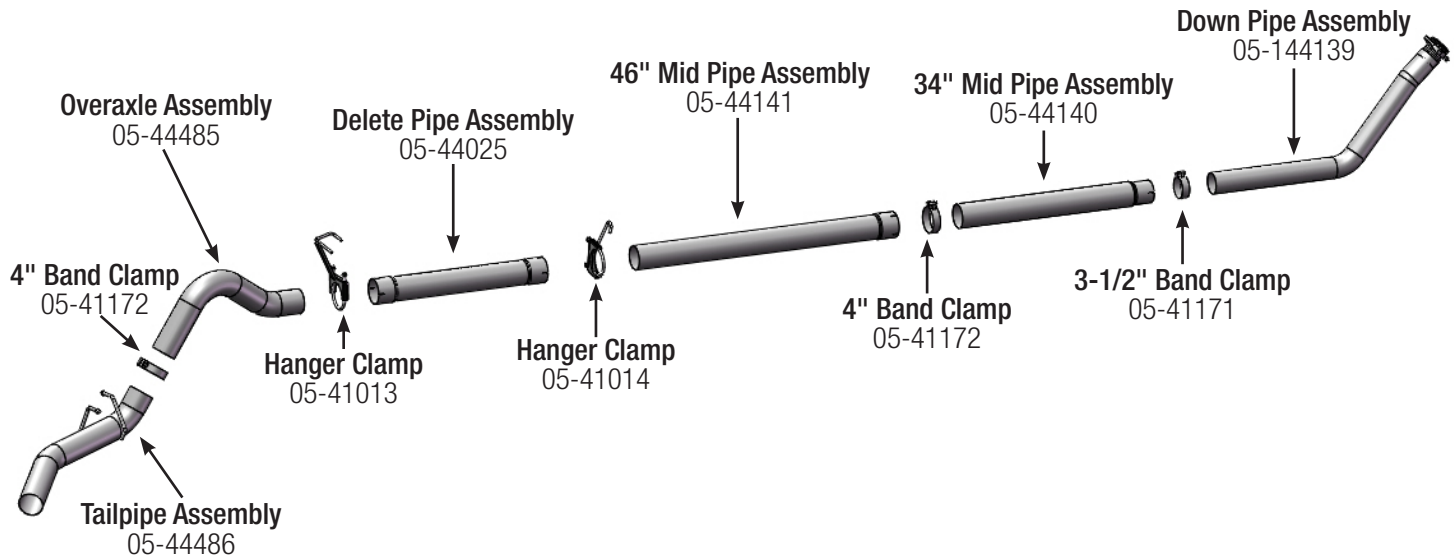

**Caution:** aFe recommends professional installation on our products. Allow time for your vehicle to cool down prior to installation. When working on or under your vehicle proceed with caution. Exhaust systems reach high temperatures and may cause serious burns. Wear protective safety equipment; eye goggles and gloves to ensure a safe installation.

**Step 1: (Read instructions prior to installation.)** Remove the stock exhaust from the rear of the truck working your way forward. It may be necessary to cut the pipes if the slip joints are stuck. Take caution not to damage the factory isolation mounts as they will be reused. Disconnect sensors at the connections. Take caution as not to damage any sensors. **It is recommended to not fully tighten the clamps until the entire system has been installed.**

**Step 2:** For faster installation spread the pieces of the exhaust along side of your vehicle according to the diagram shown.

**Step 3:** First install the down-pipe, then install the mid-pipe with a band clamp. Be sure to select the correct mid-pipe depending on the wheelbase length.

**Step 4:** Now jump to the installation of the rear of the exhaust system. Utilizing the factory isolation mounts install the overaxle/tailpipe. For 94-97 model year trucks use tailpipe hanger kit P/N: 49-02001BR. Next install the muffler delete pipe using the two clamps indicated. **Do not fully tighten.**

**Step 5:** Now that the front and rear of the system are installed test fit the 46" mid-pipe as this pipe will need to cut at the muffler end to fit shorter wheelbases. After test fitting and cutting, install the 46" mid-pipe using the band clamp and hanger clamp as shown.

**Step 6:** Adjust for alignment making sure the isolation mounts are angled forward slightly and tighten all connections. Your installation is now complete. It is recommended to re-tighten all exhaust components after the first 50-100 miles.