



FILTERS

www.sbfilters.com

INSTALLATION INSTRUCTIONS

S&B P/N 75-5027

1994-1997 Ford

F-250, F-350

7.3L PowerStroke Diesel

- * Kit may not fit vehicles with the following **Aftermarket Parts** installed.
- * **Body Lift**
- * **Custom Hood**
- * **Turbo Upgrade**
- * **Intercooler Upgrades**

QTY PARTS LIST

1	(H) S&B Filter Adapter
1	(F) S&B Air Box
1	(J) Hump Adapter
1	(C) S&B Air Filter
1	(D) Clear Lid
2	(I) # 64 Hose Clamp
2	(G) 5/16-18 SS Screw
3	(K) Grommet
4	(A) 10/24 SS Screws
4	(B) 10/24 SS Concave Washer
1	(E) # 72 Hose Clamp

TOOLS REQUIRED

Phillips Head Screwdriver
Flat Head Screwdriver
5/16", 7/16" Socket
8mm Wrench or Socket
Socket Extension

Your S&B Air Filter is factory oiled and ready to use. Air Filter P/N KF-1041 will require 72g of oil for main body and 4g of oil for the top when serviced.

1. Remove the OE bolt and washer from the OE intake air scoop. Then remove the air scoop from the vehicle.



2. With the ignition switched off, disconnect the negative battery cable.



3. Loosen the OE hose clamp at the air intake tube to turbo inlet tube.



4. Remove the 2 OE air filter retaining fasteners. Use a flat head screwdriver.



5. Remove the OE air box lid and tube assembly, then remove the OE air filter.



6. Remove the OE air box mounting nut and washer.



7. Pull up, then push the OE air box toward the engine to gain access to the air temp. sensor, disconnect the sensor.



8. Pull up and push towards the firewall to release the OE air box from the rubber grommets, remove it and the grommets from the vehicle.



9. Twist a 1/4 turn to remove the OE temp. sensor from the OE air box.



10. Install the OE temp. sensor onto the side of the S&B air box (F). **Type "A"** will require a Grommet (K) to be installed in the S&B air box (F) first. **Type "B"** will not, simply unscrew the sensor's 1/4 turn adapter nut and place the sensor through the hole in the box and secure using the 1/4 turn adapter nut.

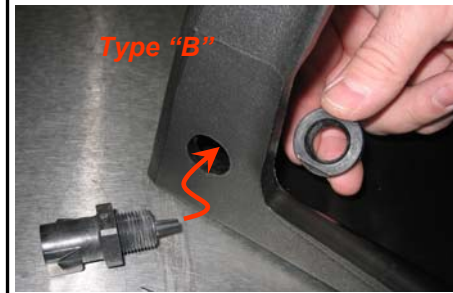
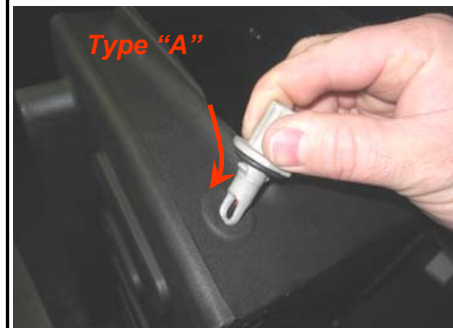

11. Install 2 S&B Grommets (K) into the bottom of the S&B air box (F)



INSTALLATION INSTRUCTIONS (continued)

12. Slide the S&B hump adapter (J) with both # 64 hose clamps (I), over the S&B air box adapter (H) until flush with the end.



13. Attach the S&B air box adapter (H) to the S&B air box (F), latch the bottom and use the 5/16 screws (G) to secure the top.

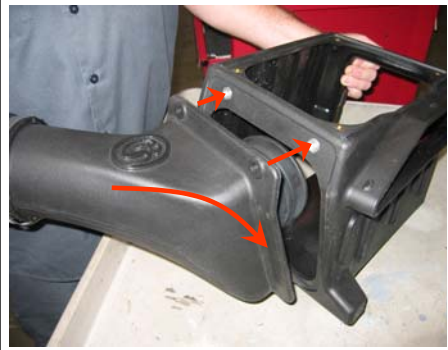

14. Place the S&B air box assembly in the vehicle. Before seating the grommets, reconnect the temp. sensor electrical connector.



15. When the S&B air box is in place, secure using the OE nut and washer.

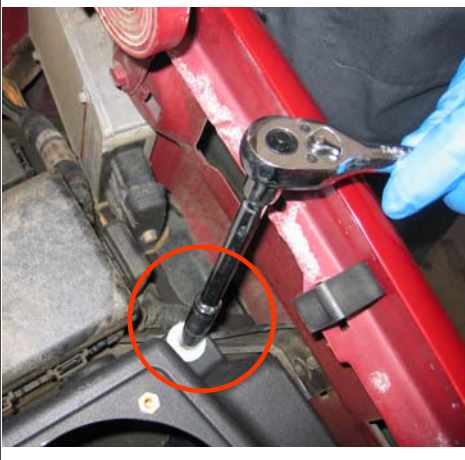

16. Center the S&B hump adapter (J) over the gap between the tubes. Secure both # 64 hose clamps (I).



17. Reconnect the negative battery cable.



18. Reinstall the OE air scoop and secure with the OE bolt and washer.



19. Install the S&B air filter (C) to the S&B air box adapter (H), secure the # 72 hose clamp.



20. Install the S&B clear lid (R), secure with 10/24 screws (S) and concave rubber footed washers (U). Do not over tighten.



21. Inspect your installation, make sure kit is properly positioned and all fasteners and connections are tight.

PERFORMANCE TESTING

- * Engage parking brake and start your engine. Listen for abnormal noises. If an air leak is detected, re-inspect hoses and connections as they may need to be repositioned and tightened.
- * S&B FILTERS RECOMMENDS THAT YOU KEEP YOUR OEM INTAKE SYSTEM IN THE EVENT IT IS REQUIRED IN THE FUTURE.
- * In order to maintain your warranty, all connections and components must be checked periodically for alignment and for proper tension on all connections. Failure to do so will void your warranty.
- * Use only S&B Filter cleaning and oil products to service your filter. Using any other brand oil and or cleaners may void your warranty.

Smog Certification Note:

The California Air Resource Board (CARB) requires that an E.O. identification label be applied to the vehicle in order to pass a smog check inspection when a High Performance Intake Kit has been installed.

You must place the E.O. label provided on or near the intake kit after installation so that a smog check technician can easily verify the E.O. number.



S&B PERFORMANCE FILTERS & INTAKE KITS

75-5027

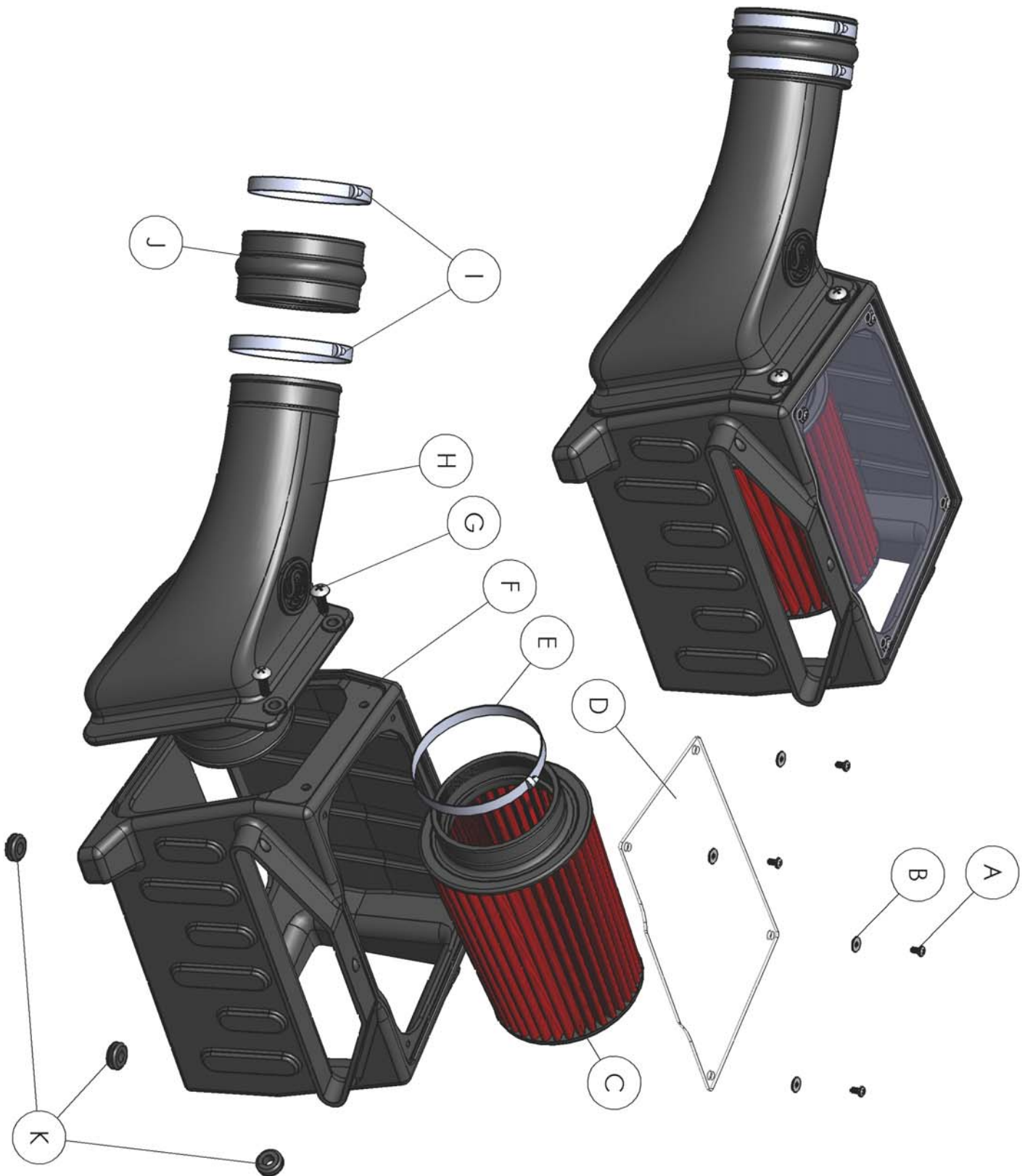

PRECISION CLEANING & OILING KIT



Order online today at www.sbfilters.com
or through your local S&B Distributor