



# INSTALLATION INSTRUCTIONS

**MAKE:** Dodge  
**MODEL:** Ram 2500/3500  
**YEAR:** 2019-2025  
**ENGINE:** 6.7L (TD)

**Stainless Steel**  
 49-42078-B  
 49-42078-P

**Cat -Back Exhaust**  
**Aluminized**  
 49-02078-B  
 49-02078-P

**Note: Will only fit MC/SB 160" WB and the CC/SB 149' WB**

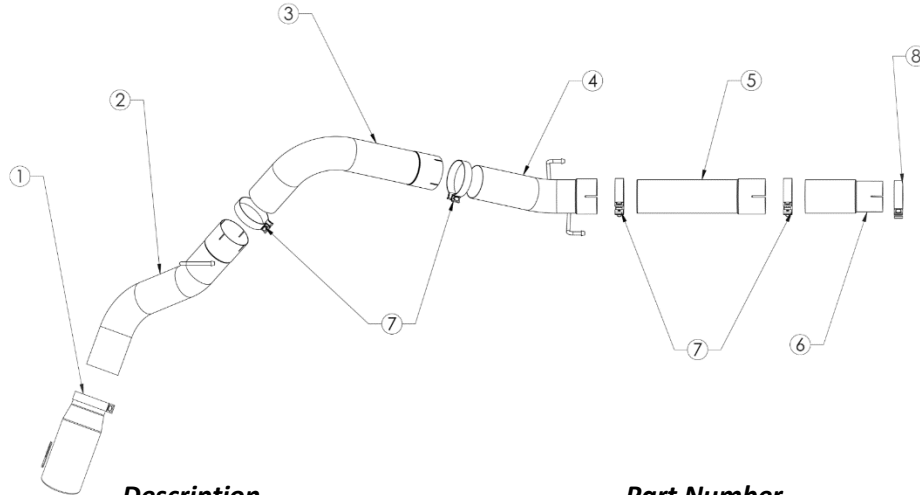

Item	Description	Part Number	Quantity
1	EXH Tip 5 In x 7 Out x 15L in Bolt-On Right Pol	49T50701-P15	1
1	EXH Tip 5 In x 7 Out x 15L in Bolt-On Right Black	49T50701-B15	1
2	Tail Pipe Stainless	05-244012	1
2	Tail Pipe Aluminized	05-242012	1
3	Over Axle Stainless	05-244011	1
3	Over Axle Aluminized	05-242011	1
4	Rear Pipe Stainless	05-144879	1
4	Rear Pipe Aluminized	05-142879	1
5	Extension Pipe Stainless	05-144878	1
5	Extension Pipe Aluminized	05-142878	1
6	Front Pipe Stainless	05-144877	1
6	Front Pipe Aluminized	05-142877	1
7	Clamp, Band: 5" (SS)	05-41173	4
8	Clamp, Band: 4-1/2" (SS)	05-410241	1

aFe POWER recommends professional installation on this product. Thoroughly inspect the aFe POWER exhaust system to make sure there is no damage from shipping (if damage is noted, immediately contact aFe POWER customer service). Allow time for your vehicle to cool down prior to installation. When working on your vehicle proceed with caution. Wear protective safety equipment; eye goggles and gloves to ensure a safe installation.

Install band clamps to proper torque specifications of 40-45 ft-lb.

- (Read instructions prior to installation.)** It is recommended to not fully tighten the exhaust until it has been fully installed. Leave loose for adjustability.
- Secure vehicle on jack stands (refer to your manual for specified jack stand positions).
- For faster installation, spread out the parts of the exhaust alongside your vehicle as shown in the diagram above.
- Secure the stock exhaust with jack/stands.
- Remove the O.E exhaust up to the back of the DPF.
- Install the aFe POWER front pipe using the provided 4.5" band clamp.
- Install the aFe POWER Extension pipe using the provided 5" band clamp for installing on the Mega Cab Short Bed 160" WB. Extension pipe is not needed for the crew Cab Short Bed 149" WB.



## INSTALLATION INSTRUCTIONS

**MAKE:** Dodge  
**MODEL:** Ram 2500/3500  
**YEAR:** 2019-2025  
**ENGINE:** 6.7L (TD)

**Stainless Steel**  
49-42078-B  
49-42078-P

**Cat -Back Exhaust**  
**Aluminized**  
49-02078-B  
49-02078-P

**Note: Will only fit MC/SB 160" WB and the CC/SB 149" WB**

8. Install the rear pipe using the provided 5" band clamp. Slide the hangers into the O.E. mounts.
9. Install the over-axle pipe using the provided 5" band clamp.
10. Install the tailpipe using the provided 5" band clamp. Slide the hanger into the O.E. isolation mount.
11. Install the aFe POWER tip.
12. Adjust the exhaust and tip into desired position.
13. Ensure that all the components of the aFe POWER exhaust system are aligned and are at a safe clearance from all wires, hoses, brake lines, body parts, and tires.
14. Start from the front of the aFe exhaust system and evenly tighten all clamps and fasteners.
15. Start the vehicle and check for any leaks. If any leaks are found, determine cause and repair as necessary.
16. Remove vehicle from jacks stands.
17. It is recommended to re-tighten all clamps and hardware after 50-100 miles.

