

2011 – 2016
Duramax
EZ LYNK LML
Switch Installation Guide

Tools needed for installation

- **Flashlight**
- **Flathead Screwdriver**
- **Snips**
- **5 FT of wire to fish the switch wires through the fire wall**
- **Zip Ties**
- **Electrical Tape**
- **10mm 3/8 Socket**
- **13mm 3/8 Deep Socket**
- **1/16 Drill Bit**
- **Unibit #1 or 3/8 Drill Bit**
- **1/8 Drill Bit**

Installing the Switch

1. Open the hood of the truck. Disconnect the negative battery cables from both batteries.

2. Locate the ECM.
(Driver side between the power steering reservoir and the battery). Please allow the truck to cool down before proceeding to the next step.



3. Remove the plastic protection cover by applying pressure to the tabs and sliding it out.

4. Looking down on the ECM from the top side on the driver side of the engine remove the ECM Plug closest to the fire wall (J3 Gray Plug). You don't have to but I've found it easiest if I remove all three of the plugs from the ECM.

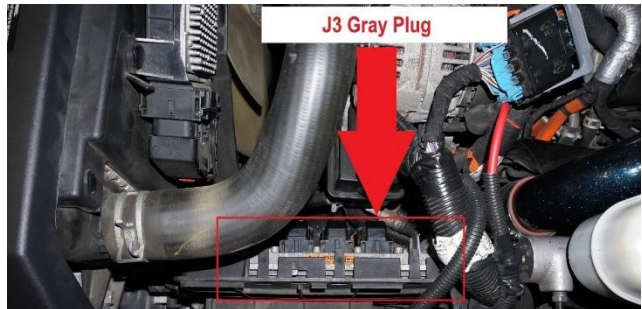

5. Disconnecting the plug from the ECM will not require any special tools. Slide the red lock tab up and apply pressure to the middle of the plug (you might hear a click indicating that it has released). Then pull up on the release lever.
6. Now that that all 3 plugs are disconnected from the ECM pull the plugs closer to allow easier access for the following steps. (I've found it easiest to push the gray and black ECM connector plugs under the power steering lines and pull them up near the hot side intercooler pipe)

7. Set the plugs to the side and use your 5ft of metal wire to fish through the firewall. (We use the hood latch release cable hole to fish the wire through to get inside the



cab. (Pushing the hood latch release cable grommet in using your fingers will allow enough room to run your wire through the firewall onto the driver's floor board. A flashlight will be handy. We removed the fender support bracket for easier access)

8. Now find the wire under the dash and attach the yellow and black wires from the switch to it. (I use electrical tape for that)
9. Using the metal wire, gently pull the yellow and black wires back into the engine bay. (Be very careful when pulling these wires through the firewall - if they feel like they are hung up go back to the drivers floor board and make sure they aren't tangled with any of the other components)
10. Once the wires are pulled through the firewall, undo the electrical tape to the yellow and black wires and remove any residue from the pins. Examine the pins to make sure they are not damaged.
11. Take the black wire loom and slide it over the yellow and black wires. (Slide the wire loom all the way into the cab. Using the electrical tape, tape the wire loom to the yellow and black wires. Leave about 8-10 inches of wire exposed)



12. Place the wire loom and wires to the side.

13. Locate the gray ECM plug and remove the zip tie holding the top cover. Remove the cap by lifting up one the 2 ears on either side. (Place the black wire cover cap in a safe place out of the way)



14. With the gray ECM connector in your hand use a pick/knife/small flathead screwdriver to pry the gray cover off the bottom of the ECM connector. (Be very gentle as they break very easy. Place the gray cover cap in a safe, out of the way place)

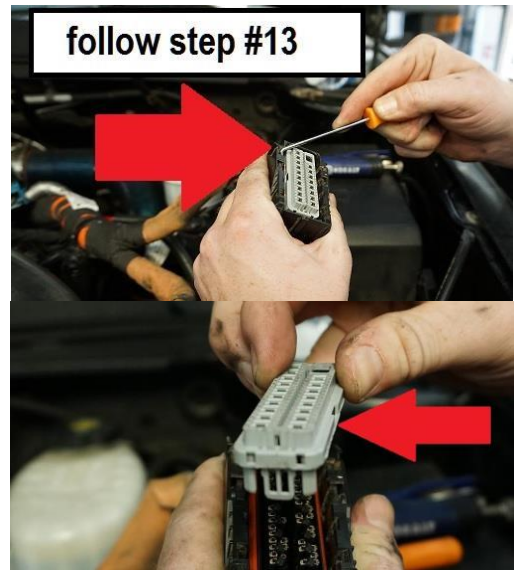

15. With the gray cap removed locate pin holes #11 & #35. 2011 model trucks will have a yellow wire running to pin #11. 2012 - 2016 model trucks have plastic filler pins in holes #11 and #35.

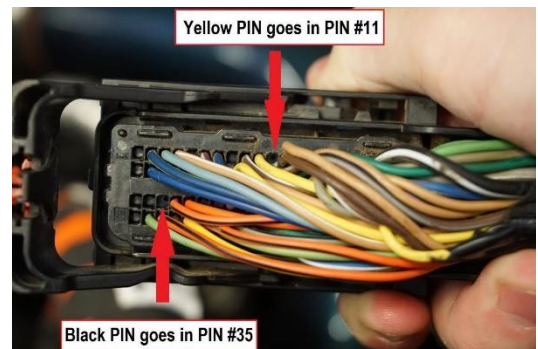

16. **2011 only** - to remove the yellow pin from #11 use a small tool of some sort (paper clip) to put pressure on the release on the bottom side of the plug. (We used an angled pick to release pin #11)



17. To remove the black plastic filler pins from pin location #11 and #35 use a 1/16 drill bit. Placing the flat end of the drill bit on the bottom side on the hole. Apply pressure to the drill bit and push the plastic filler pin out the top. (Be very careful pushing the plastic pins out they will need more pressure applied to them than your fingers can apply)



18. Take the Yellow wire and put it in the #11 PIN hole. (To make sure that it is in all the way you can verify by looking at the back side to make sure it's flush with all the other pins. The PIN shouldn't be able to be pulled out the top side.) Repeat this for the Black wire that goes into PIN #35.

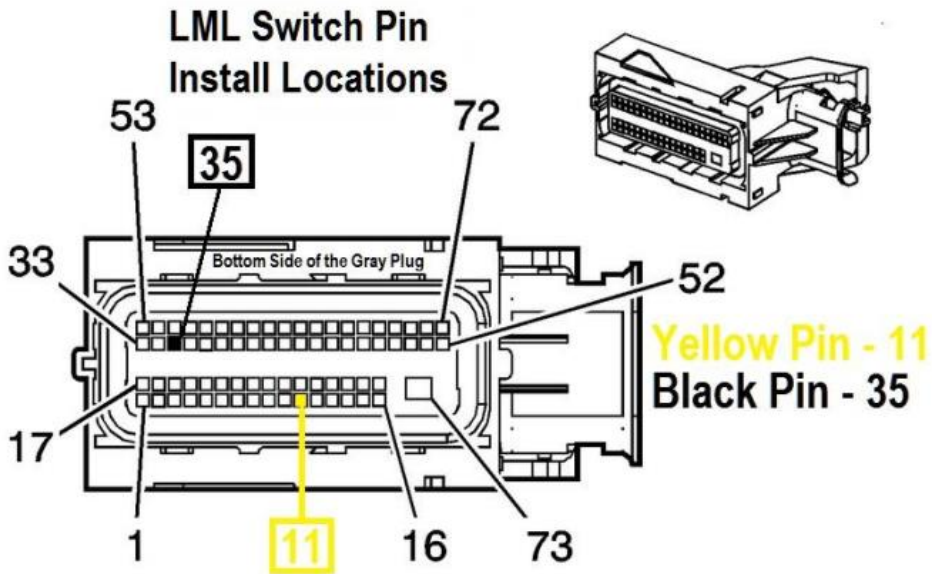

19. With both the Yellow and Black wires installed, put the gray bottom cover back on the plug. (make sure that it doesn't push the wires back out the top side when putting the gray cover back on)

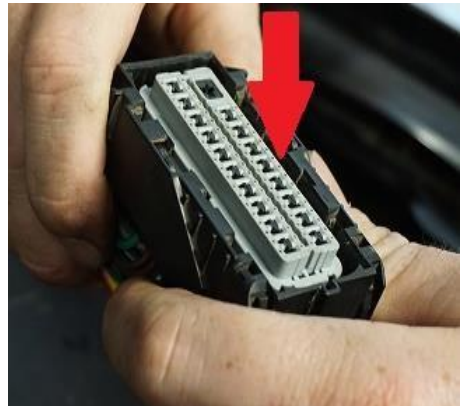

20. Using a zip tie fasten the wires to the plug where you used the snips to cut the original factory zip tie.
21. Place the black wire cover cap back on to the plug.
22. Carefully replace all the ECM plugs you removed
23. The LML Switch is now installed. You may mount the switch anywhere in the cab that you please.